

Manual Valve

Type 987 DN 15 - 300 (1/2" - 12")

Type 987 manually operated actuator in metal.

This valve with non rising hand wheel has a robust designed metal actuator which allows higher temperatures applications, depending on the diaphragm material to be used

Features

- Process media can be neutral or aggressive liquid, and gaseous, dependent upon material selection of body and diaphragm
- Flow can be in either direction
- Insensitive to dirty or contaminated media
- Excellent flow characteristic
- Bubble tight sealing
- Installation can be in any position
- Eliminates water hammer
- Complete with position indicator
- Compact construction

Technical specifications

Design	Diaphragm Valve Metal bonnet and handwheel
Size range	DN 15 - 300
Diaphragm size see page 11	MA 25 - 300
Body material	S.G. iron EN-GJS-400-18-LT (GGG40.3)-PP-Lined S.G. iron EN-GJS-400-18-LT (GGG40.3)-PFA-Lined Cast iron EN-GJL-250 (GG 25) Cast iron EN-GJL-250 (GG 25)-Hard-Rubber-Lined
End connection standards see page 8-9	Threaded socket: DIN ISO 228 Flange: EN 1092 PN10/16, ANSI Class 125/150
Diaphragm material	EPDM, PTFE, NBR, FPM
Actuator material	GG25, non rising hand wheel
Max. working pressure	DN15 - 150 , 10 bar (150 PSI) DN200 - 300, 6 bar (87 PSI)
Temperature range	-10 °C to +150 °C, depending on diaphragm and body material
Control functions	Manual control

Note: Possible actuator and valve body combinations see page 7.
Ordering key see page 60.

K_v100 flow coefficient

The K_v100 flow coefficient is the Q flow rate of cubic meter per hour of water at a temperature of 20°C that will generate Δp = 1 bar pressure drop at a certain valve position.

The K_v100 values shown in the table are calculated with the valve completely open.

DN	MA	Unlined		Hard rubber lined		Plastic lined	
		Kv m ³ /h	Cv gpm	Kv m ³ /h	Cv gpm	Kv m ³ /h	Cv gpm
15	25	7	8	-	-	5	6
20	25	12	14	10	12	9	11
25	25	14	16	14	16	13	15
32	40	-	-	29	34	23	27
40	40	40	47	32	37	26	30
50	50	78	91	51	60	50	59
65	65	88	103	75	88	-	-
65	80	-	-	-	-	72	84
80	80	154	180	113	132	110	129
100	100	217	254	190	222	175	205
125	125	280	328	240	281	214	250
150	150	478	559	395	462	365	427
200	200	1035	1211	865	1012	865	1012
250	250	1389	1625	1258	1472	1466	1715
300	300	2244	2625	1816	2125	-	-

Manual Valve

Type 987 DN 15 - 300 (1/2" - 12")

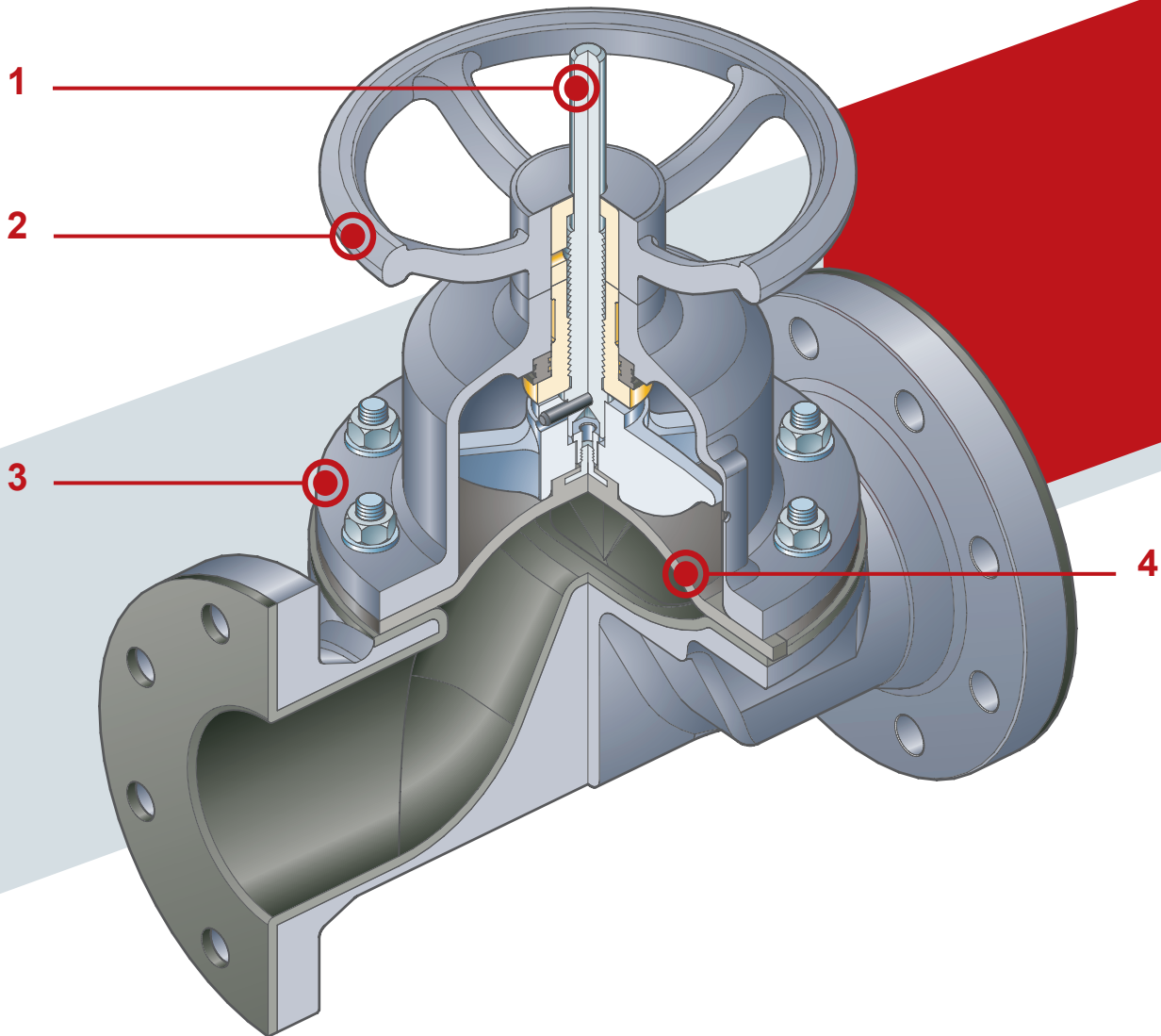

1 Optical position indicator supplied as standard

2 Non-rising ergonomic metal handwheel for easy operation

3 Robust metal bonnet in cast iron EN-GJL-250

4 Diaphragm which isolates the bonnet from the medium. Available in various materials for different media.

Manual Valve

Type 987 DN 15 - 300 (1/2" - 12")

Threaded Socket

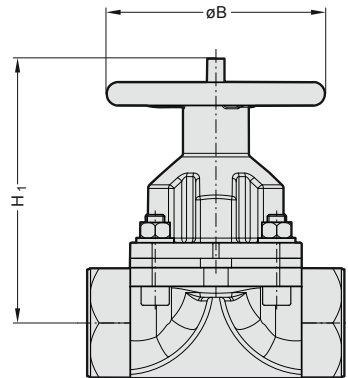

Flanged

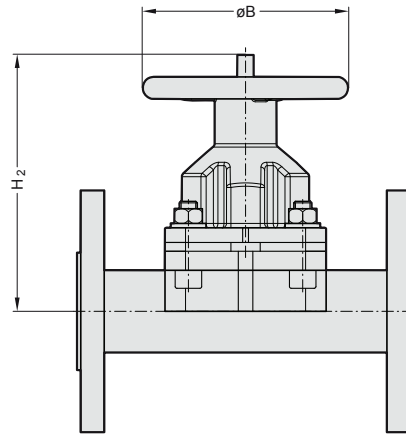

Dimensions (mm)

DN	MA	ØB	Threaded socket version		Flanged version	
			H ₁	Weight kg	H ₂	Weight kg
15	25	100	102	1,7	111	3,1
20	25	100	105	1,8	111	3,9
25	25	100	109	2,1	115	4,3
32	40	140	153	3,9	157	8,0
40	40	140	156	4,3	163	9,0
50	50	140	172	6,0	176	12,0
65	65	180	173	9,6	206	15,0
65	80	225	-	-	258	21,0
80	80	225	-	-	258	23,0
100	100	225	-	-	292	32,0
125	125	310	-	-	354	68,0
150	150	368	-	-	423	106,0
200	200	471	-	-	576	185,0
250	250	587	-	-	689	275,0
300	300	690	-	-	815	480,0

Note: Valve body face to face (FTF) and flange dimensions see page 8.