

CAST STEEL VALVE

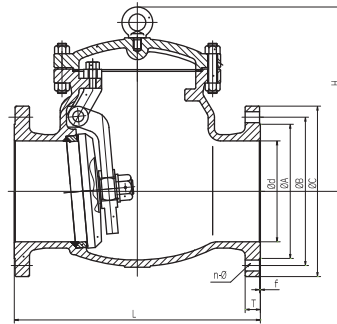

2" - 24"

G3FM413CTS-17-R0

TYPE FM 413 CTS

- ANSI 150LBS
- BODY ASTM-A216-WCB
- FACE TO FACE ANSI B16.10, END FLANGE ANSI B16.5
- BASIC DESIGN API 6D & BS 1868, TEST API 598
- OPTION: ANSI 300LBS, 600LBS

Dimensions

Unit :mm

SIZE	Ød	ØA	ØB	ØC	T	f	L	H	n-Ø
2"	51	92	120.5	152	16	1.6	203	135	4-Ø19
2-1/2"	64	105	139.5	178	17.5	1.6	216	155	4-Ø19
3"	76	127	152.5	190	19	1.6	241	168	4-Ø19
4"	102	157	190.5	229	24	1.6	292	235	8-Ø19
5"	127	186	216	254	25	1.6	330	249	8-Ø22
6"	152	216	241.5	279	26	1.6	356	277	8-Ø22
8"	203	270	298.5	343	29	1.6	495	339	8-Ø22
10"	254	324	362	406	31	1.6	622	398	12-Ø25
12"	305	381	432	483	32	1.6	698	525	12-Ø25
14"	337	413	476	533	35	1.6	787	553	12-Ø29
16"	387	470	540	597	37	1.6	864	584	16-Ø29
18"	438	533	578	635	40	1.6	978	688	16-Ø32
20"	489	584	635	699	43	1.6	978	712	20-Ø32
24"	591	692	749.5	813	48	1.6	1295	740	20-Ø35

