

CHECK VALVE

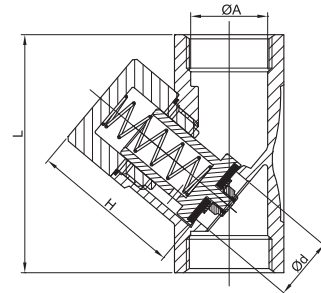
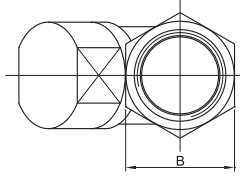

THREADED END, 1/4" - 4"

G1FM407-17-R0

TYPE FM 407

- PISTON CHECK VALVE, PN40
- BODY ASTM-A351-CF8M
- PN40 RATING
- MAXIMUM WORKING TEMPERATURE 230°C
- END TO END CONFORMS TO DIN 3202 PART 4 M8 SERIES (PN40)

Dimensions

Unit :mm

SIZE	ØA	B	Ød	H	L	WEIGHT KGS
1/4"	11.7	27	11.6	34.4	65.8	0.28
3/8"	14	27	12.5	34.4	65.8	0.25
1/2"	17	27	12.5	34.4	65.8	0.23
3/4"	23	32.3	18	44.6	75.7	0.38
1"	29	41	23.5	56.9	89.7	0.72
1-1/4"	38	50	31.4	64.2	109.8	1.22
1-1/2"	44	55.5	35.7	76	121	1.55
2"	56	70	45.5	87	151.6	2.75

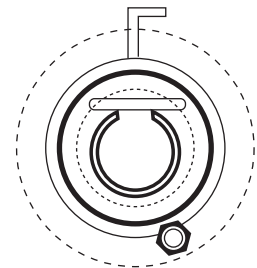
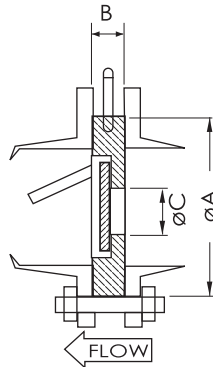

THREADED END, 2" - 12"

G1FM418-17-R0

TYPE FM 418

- SINGLE DOOR CHECK VALVE, ANSI 150/ DIN PN16
- BODY & DISC ASTM-A351-CF8M/ASTM-A351-CF8
- FL-HOOK TYPE CHECK
- OPTION: JIS 10K

Dimensions

Unit :mm

SIZE	PRESSURE RATING	ØA	B	ØC
2"	150L	104	19	30
	PN16	109	19	30
2-1/2"	150L	124	19	42
	PN16	129	19	42
3"	150L	134	19	50
	PN16	144	19	50
4"	150L	175	19	72
	PN16	164	19	72
5"	150L	195	21	93
	PN16	194	21	93
6"	150L	220	21	112
	PN16	220	21	112
8"	150L	279	27	142
	PN16	275	27	142
10"	150L	339	29	190
	PN16	330	29	190
12"	150L	409	32	211
	PN16	386	32	211