

All configurations now include CNC machined honeycomb aluminum, wet wing fuel tanks, streamline aerodynamic extruded lift struts, wheels & brakes, wing skins at no extra charge!

What's Included in the Belite Chipper 2-Place Experimental Kit?

Chipper kits ship in two separate groups: The Airframe Kit and the Finishing Kit. You'll also need other things including, but not limited to: an engine, engine mount, cowl, battery, propeller, engine probes, (collectively, "FireWall Forward"), instruments, ELT, transponder, radio, fabric, glue, paint and more. The kit does include wheels and brakes, but DOES NOT include tires or tailwheel mechanism.

The finishing kit contains many beautifully machined components, along with wing skins, lift struts, welded rudder pedals, and much, much more!

There are items which you will be required to purchase, and this document describes those items to the best of our ability.

This document describes the contents of the airframe kit, the finishing kit, and "what's NOT included." Please study it carefully. If it's not included on our bill of materials, it's not in the kit. This information is subject to change, please check back for the latest info.

The kit comes with a generous supply of high quality rivets. You may order more rivets from us as you need.

AIRFRAME KIT

There are several sub kits included in your airframe kit. Each has a separate assembly chapter.

- Cabin
- Rear fuselage
- Rudder
- Horizontal stabilizer and elevator
- Wings (set of 2)
- Hoerner wingtips (set of 2)
- Cabin Seat

CABIN

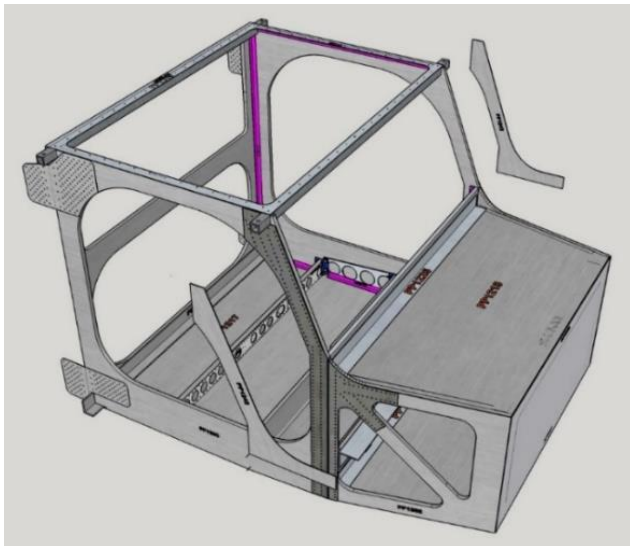

1: Cabin

- 1) Cabin parts CNC precut honeycomb aluminum panels, still tabbed into sheets
- 2) Gussets, pre-drilled
- 3) Bulk angle stock, you must cut to length and rivet on butting edges throughout cabin
- 4) Top cabin aluminum sheet, CNC cut, predrilled
- 5) Steel spar carry throughs top cabin
- 6) Aluminum angle bottom lift strut carry through
- 7) 0.25" heavy landing gear plate, CNC cut
- 8) 0.125" side landing gear plates, CNC cut
- 9) AN Bolts, Nuts, Washers for bolting landing gear plates on corners
- 10) Rivets

REAR FUSELAGE

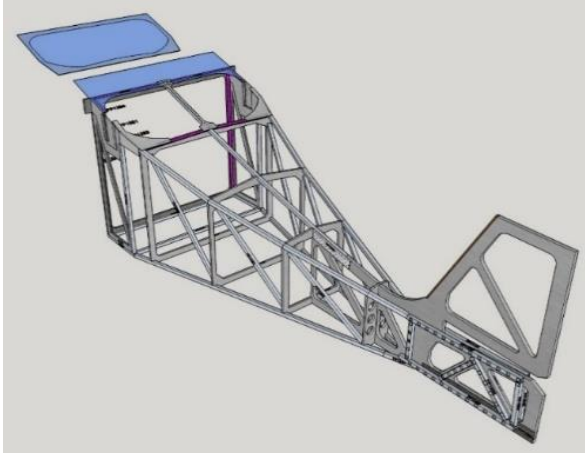

1: Rear Fuselage

- 1) Rear Fuselage formers CNC precut honeycomb aluminum panels, still tabbed into sheets.
- 2) Vertical stabilizer CNC precut honeycomb aluminum panel
- 3) Square thinwall aluminum tubing, you must cut to length and rivet on butting edges throughout rear fuselage
- 4) Bulk angle stock, you must cut to length and rivet on butting edges at some locations
- 5) Bottom rear fuselage aluminum sheet CNC cut
- 6) Side rear fuselage aluminum sheet CNC cut, trimming may be required
- 7) Top rear fuselage aluminum sheet in overlapping sheets, you must trim and drill to fit each sheet
- 8) Bottom 0.75" square reinforcement tube
- 9) Polycarbonate parts for top along with frame
- 10) Predrilled gussets
- 11) Rivets

JURY STRUTS

James is working on an improved jury strut design. You will receive it as part of your kit.

WINGS (set of two) – PP1000 in your kit

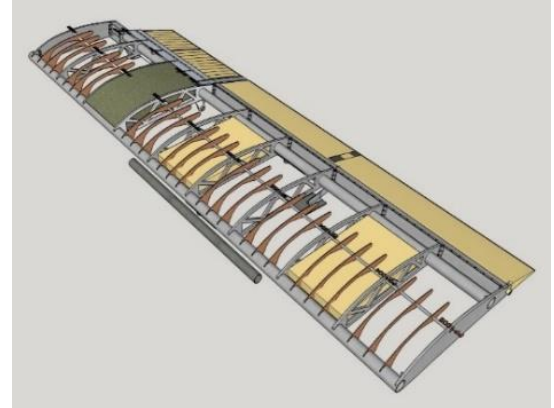

3: Wing

- 1) 12' aluminum spars (set of four) (these need 1.5" tip extensions to meet length requirement of 145.5".) (Extensions are included.)
- 2) Wing Ribs CNC precut honeycomb aluminum
- 3) 0.5" 6061T6 false rib spars 24' total
- 4) False ribs, CNC precut from 1/8" Baltic birch plywood
- 5) Aluminum strips and parts to fabricate trailing cove for Ailerons and flaps. Builder cuts to length, bends and drills
- 6) Aileron Kit for each wing
- 7) Flap Kit for each wing
- 8) Aileron spade parts for each wing
- 9) AN hardware
- 10) Rivets
- 11) 17 gallon wet wing tank skins and ribs
- 12) Metal skins

HOERNER WING TIPS

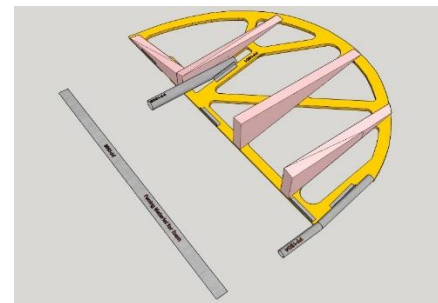

7: Wingtip (Hoerner)

- 1) Foam raw, must be shaped with rasp
- 2) Wingtip CNC precut honeycomb aluminum
- 3) Aluminum Angle
- 4) Front tube
- 5) Rear tube
- 6) Aluminum facing strips
- 7) Rivets

SEAT

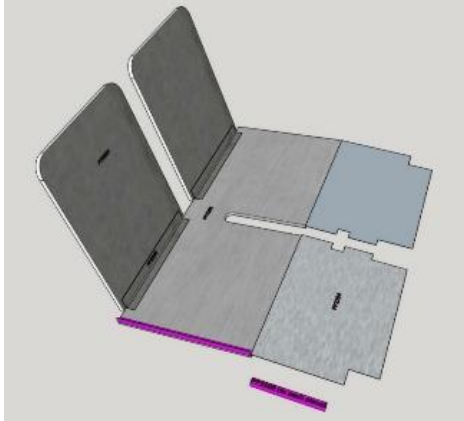

8: Seat

- 1) CNC Precut honeycomb aluminum base
- 2) CNC Precut honeycomb aluminum backs
- 3) Hinge material
- 4) Front cover trim aluminum
- 5) Angle aluminum
- 6) Rivets

HORIZONTAL STABILIZER and ELEVATOR

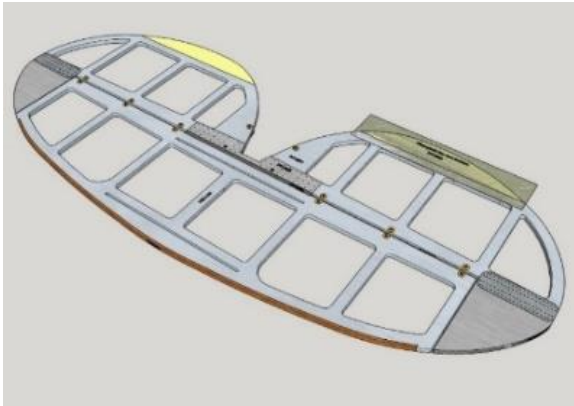

5: Horizontal surfaces

- 1) CNC precut horizontal stabilizer
- 2) CNC precut elevator
- 3) CNC precut gussets
- 4) AN Bolts, Nuts, Washers for bolting bracing
- 5) Hinge material for elevator and trim tab
- 6) AN Bolts, Nuts, Washers
- 7) CNC precut elevator tips
- 8) CNC precut elevator bellcranks
- 9) Left and right side 1" thick foam piece CNC precut for trailing edge of elevator
- 10) Fiberglass cloth
- 11) Softwood for fabrication of right side elevator trim tab
- 12) Rivets

RUDDER – PP1600 series in your kit

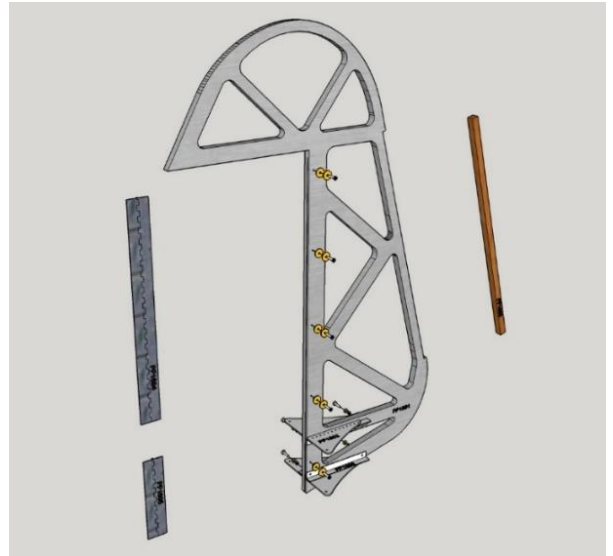

4: Rudder

- 1) CNC precut rudder
- 2) Angle material for attachment of rudder and tailwheel steering bellcrank
- 3) CNC precut bellcranks
- 4) Hinge material
- 5) AN Bolts, Nuts, Washers for attachment to hinge
- 6) Softwood insert for rear of rudder

FINISHING KIT – TAILDRAGGER

(The tricycle kit is very similar to the following list. Delete the tailwheel, change the main landing gear; add a nose gear assembly.) The taildragger finishing kit provides the following items:

WINGS (set of two)

- 1) Strut attachment CNC machined parts
- 2) Aileron Bellcrank CNC machined parts

CABIN

- 1) Firewall material, stainless steel

LIFT STRUTS

- 1) Set of four main streamline lift struts
- 2) CNC Machined lift strut inserts for top and bottom
- 3) (Folding wing: machined parts for bottom folding)
- 4) AN Bolts, Nuts, Washers

LANDING GEAR (set of two)

- 1) 7075T6 turned gear legs
- 2) CNC Machined gear leg collars
- 3) Trailing link tubing and hardware
- 4) Matco Wheels
- 5) Matco hydraulic brakes
- 6) Matco hydraulic master cylinders (set of two)

- 7) Matco axles
- 8) Hydraulic tubing for brakes
- 9) Gear attachment fittings for connecting axle to gear leg
- 10) AN Bolts, Nuts, Washers

WINDSHIELD

- 1) 0.093" polycarbonate CNC precut windshield
- 2) Rivets
- 3) Windshield ribs, CNC cut from honeycomb fiberglass
- 4) Windshield spars (aluminum tubes)

SEATS

- 1) Seatbelts x 2

ENTRY DOOR (set of 2)

- 1) CNC precut honeycomb door
- 2) 0.040" polycarbonate CNC precut windshield
- 3) Latch Mechanism
- 4) Hinge material
- 5) Rivets

CABIN BRACES

- 1) Prewelded steel tubes
- 2) AN hardware

CONTROL SYSTEMS

- 1) Rudder cables
- 2) Rudder cable hardware
- 3) Rudder cable nylon tubing
- 4) Elevator Push-Pull cables (set of two)
- 5) Elevator cable mounting angle
- 6) Elevator cable collars (set of four)
- 7) Aileron Push-Pull cables (set of two)
- 8) Aileron cable mounting clasps (set of four)
- 9) CNC machined control hardware set (comprehensive CNC parts kit for complete control assembly)
- 10) Steel all-thread
- 11) Rod end bearings
- 12) Aileron droop intermix plate
- 13) AN Bolts, Nuts, Washers

ITEMS THAT ARE REQUIRED BUT NOT INCLUDED

- 1) Engine
- 2) Engine Mount
- 3) Propeller
- 4) Propeller spinner, if desired
- 5) Cowl
- 6) Fuel line tubing and hardware
- 7) Fuel selector and cutoff switch
- 8) Fuel filter
- 9) Fuel pump
- 10) Instrument panel
- 11) Instruments / ELT / Transponder / ADS-B out
- 12) Engine control (throttle quadrant, cables, magneto switches, primer pump or bulb, carb heat, etc.) and FWF
- 13) Battery
- 14) Covering material, paint, glue, oratex, etc.
- 15) Flap servos, trim mechanism, droop servos, wiring, switches
- 16) Tailwheel assembly
- 17) Wheels

All information subject to error correction and change without notice. Prices do not include: engine, propeller, mount, cowl, instruments, fabric, paint, shipping, glue, etc. Disclosure: In order to reduce costs, some of our materials are purchased from surplus vendors. If you have questions, please ask before purchasing.