



## Medium Pressure Filters

Medium pressure filters can be used in applications up to 2000 psi (13790 kPa). Donaldson offers both spin-on and in-line cartridge-style filters.

Donaldson Duramax® filters are the highest rated medium pressure spin-on filters available. Duramax filters are proven, reliable, long-lived and easy to install.



## Section Index

Max Operating Pressure < 2000 psi (138 bar)

Models arranged from low to maximum flow rates

### Spin-on Filters

HMK03 .....	82
HMK04 .....	86
HNK04 .....	94
HMK05 .....	90
HNK05 .....	94
HMK24 .....	86
HMK25 .....	90

### In-line Cartridge Filters

FLK90 .....	99
FLK110 .....	102
FLK125 .....	105
DPK350 .....	108
W061 .....	112
HDK06 .....	116
W041 .....	120
HFK08 .....	124



HMK03

Max Flow: 25 gpm (95 lpm)



## HMK03 DURAMAX® Spin-On Filters

**Working Pressures to:** 1000 psi  
6895 kPa  
69 bar

**Rated Static Burst to:** 2000 psi  
13,790 kPa  
138 bar

**Flow Range To:** 25 gpm  
95 lpm

### Features

HMK03 Series Duramax® spin-on filters offer twice the capacity of competitive filters, yet they are physically smaller than traditional housing/cartridge filter assemblies. It features a die cast aluminum head and a unique radial seal O-ring gasket design that eliminates leakage.

Take advantage of Donaldson's mix and match system of in-stock heads, housings and media choices – so you can get exactly what you need. A full range of media options are available, using Donaldson's exclusive Synteq™ synthetic media designed especially for liquid filtration. You can also select the exact indicator types and bypass options to suit your application.



### Beta Rating

- Performance to  $\beta_{6(c)} = 1000$

### Porting Size Options

- SAE-12 O-ring

### Replacement Filter Lengths

- 5.5" / 140mm
- 9.5" / 242mm

### Standard Bypass Ratings

- 50 psi / 345 kPa / 3.5 bar
- No Bypass

### Filter Collapse Ratings

- 290 psid / 20 bar

### Assembly Weight

- Short: 3.3 lbs / 1.5 kg
- Long: 4.2 lbs / 1.9 kg

### Operating Temperatures

- -20°F to 250°F / -29°C to 121°C

### Housing Fatigue Strength Ratings\*

- 100,000 Cycles:  
0-1000 psi / 0-6895 kPa / 68 bar
- 300,000 Cycles:  
0-800 psi / 0-5516 kPa / 55 bar
- 1,000,000 Cycles:  
0-700 psi / 0-4826 kPa / 48 bar



## HMK03 Specification Illustrations

All dimensions are shown in inches [millimeters].

### Assembly - Side Views

Long Assembly

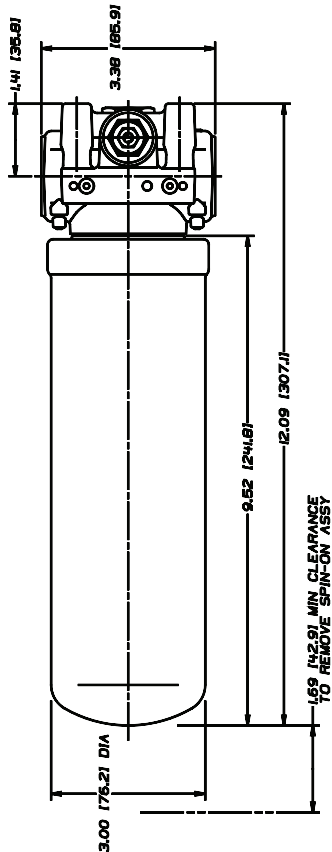

Short Assembly

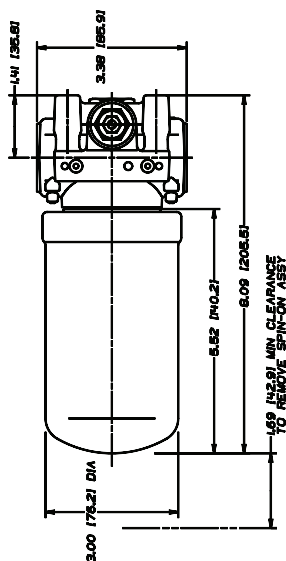

### Head - Top View with Indicators

Head with DC Electrical Indicator

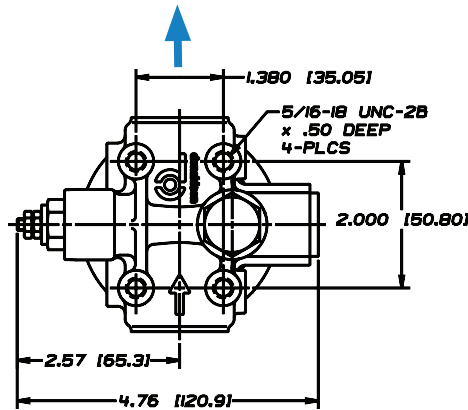

Head with AC/DC Electrical Indicator

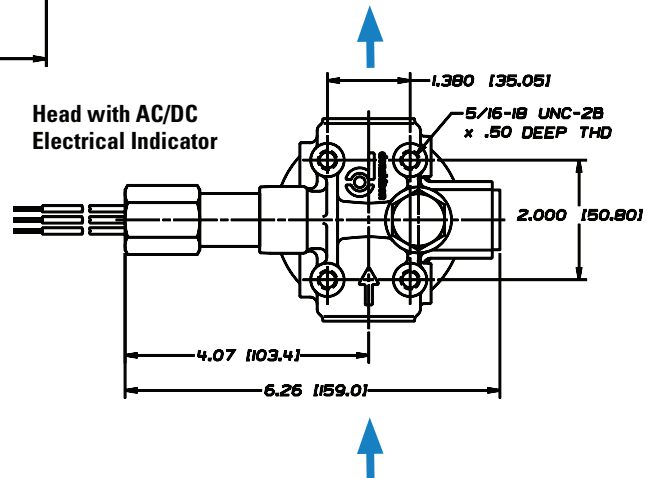

Head with Visual Indicator

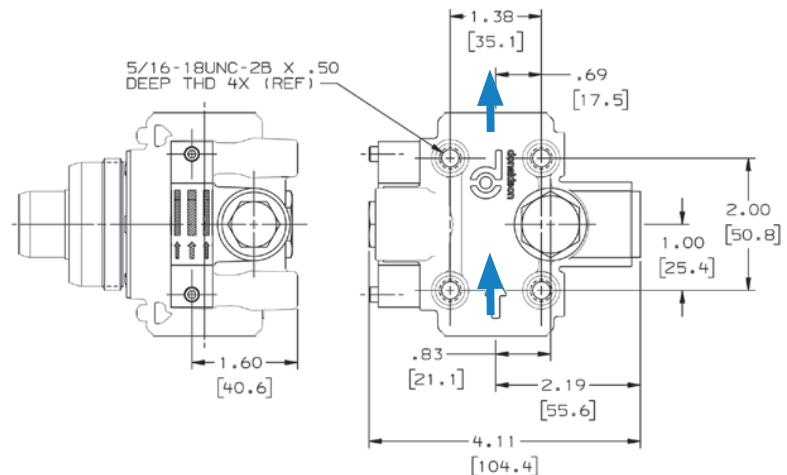



# HMK03

Max Flow: 25 gpm (95 lpm)



## HMK03 Components

### Filter Choices

Media	$\beta_{x(c)} = 1000$	Length		Donaldson	Comments
Type	Rating based on ISO 16889	in	mm	Part No.	
Synteq Synthetic	6 $\mu$ m	5.5	140	P170308	Buna-N
	6 $\mu$ m	9.5	242	P170309	Buna-N
	11 $\mu$ m	5.5	140	P170310	Buna-N
	11 $\mu$ m	9.5	242	P170311	Buna-N
	23 $\mu$ m	5.5	140	P170312	Buna-N
	23 $\mu$ m	9.5	242	P170313	Buna-N

#### Filter Notes

- Synteq™ filter media is compatible with petroleum based fluids, most phosphate esters, water oil emulsions, and HWCF (high water content fluids)
- All models have 2" -12 threads
- Buna-N® is a registered trademark of E. I. DuPont de Nemours and Company.



### HMK03 Head

Port Size	Bypass Rating	Indicator	Head Part No.
3/4" SAE-12	No Bypass	None*	P170327
O-Ring	50 psi / 345 kPa	None*	P170773
	50 psi / 345 kPa	Visual*	P179460

\*Head is machined to accept optional electrical indicators. See Indicator list at right for the available choices.

### Oil Service Indicator Choices

Use with Bypass Valve Pressure of:	Part No.	Style <sup>2</sup>	Description <sup>1</sup>
25 psi / 172.5 kPa	P171143	B	Electric 2-wire DC
	P173944	C	Electric 3-wire AC/DC
	P165965	D	Visual
	P575334	H	Visual, pop up
50 psi / 345 kPa	P165194	A	Electric Single post DC
	P574968	B	Electric 2-wire DC
	P174396	C	Electric 3-wire AC/DC
	P575335	H	Visual, pop up
	P574967	E	DC 2-wire.

<sup>1</sup> All electric models have a maximum operating temperature of 250°F/121°C.

<sup>2</sup> See illustration of indicator styles on next page and complete details for all parts in the service indicators portion of the accessories section.

## HMK03 Service Parts

### Service Indicator Styles (See table on opposite page)

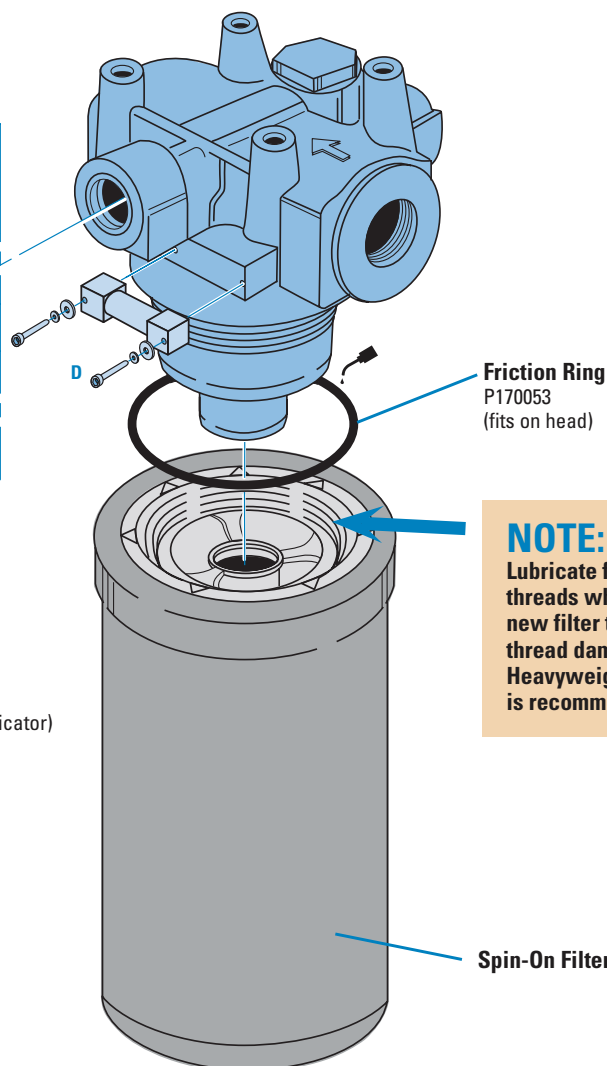
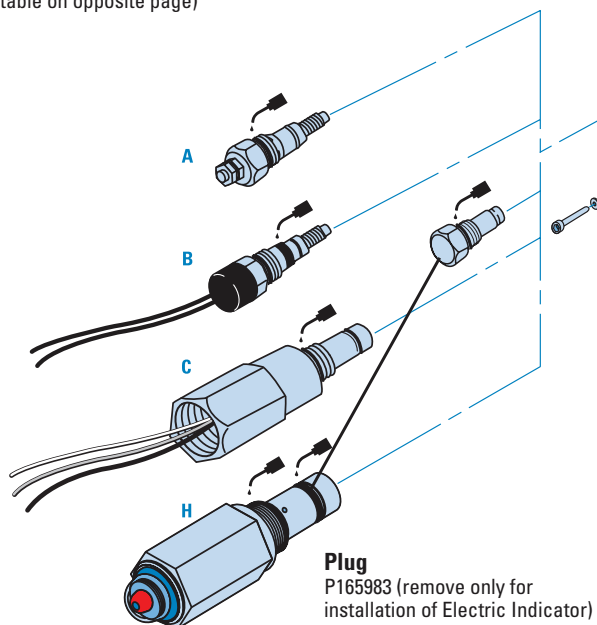

**NOTE:**  
Lubricate filter-to-head threads when installing new filter to prevent thread damage. Heavyweight gear lube is recommended.

## Performance Data

### HMK03 Filter Only (Synthetic, 5.5"/140mm)

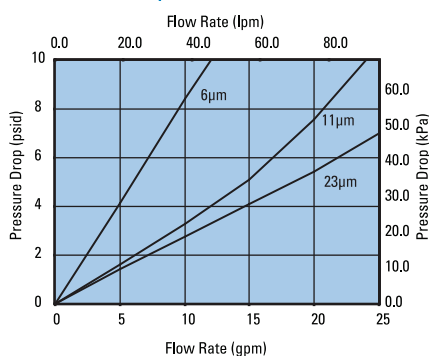

### HMK03 Filter Only (Synthetic, 9.5"/242mm)

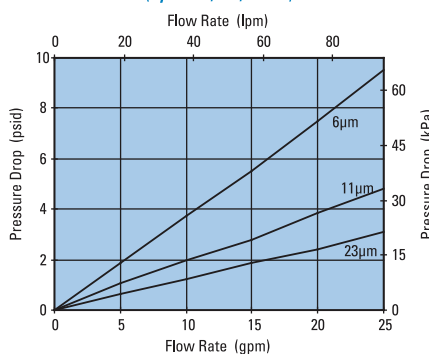

### HMK03 Head Only

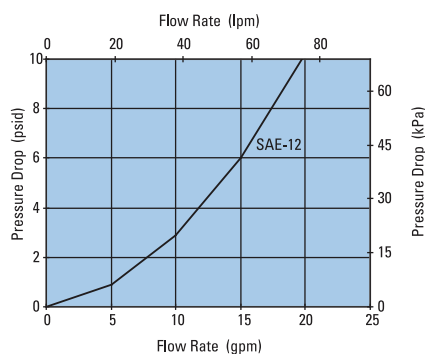

### SERVICE PARTS NOTE:

Some service parts may not be stocked. Please contact your Donaldson sales representative for lead time details.



## HMK04/24

Max Flow: 35 gpm (133 lpm) / 60 gpm (227 lpm)



### HMK04/24 DURAMAX® Spin-On Filters

**Working Pressures to:** 500 psi  
3450 kPa  
35 bar

**Rated Static Burst to:** 1000 psi  
6895 kPa  
69 bar

Flow Range To:	HMK04	HMK24
	35 gpm 133 lpm	60 gpm 227 lpm



Parallel Flow

### Features

HMK04 (single) and HMK24 (double) Duramax® spin-on filters feature a die-cast aluminum head, heavy-duty steel body, and die-cast aluminum top plate for added strength. A special head-to-canister O-Ring seal prevents leakage. Buna-N seals are standard; Viton® seals are available on some models.

Both models use the same replacement filters and feature identical pressure ratings, but the HMK24 handles greater flow capacity. There's no need to inventory two different replacement filters. A full range of media options are available, using Donaldson's exclusive Synteq™ synthetic media. Choose the indicator types and bypass options to suit your application.

#### Beta Rating

- Performance to  $\beta_{<4(c)} = 1000$

#### Porting Size Options

- HMK04 ¾", 1" NPT
- HMK04 SAE-12, SAE-16 O-ring
- HMK24 SAE-20, O-ring
- HMK24 1¼" SAE 4-Bolt  
Flange Code 61

#### Replacement Filter Lengths

- 5.97" / 152mm
- 9.4" / 240mm

#### Standard Bypass Ratings

- 25 psi / 173 kPa / 1.73 bar
- 50 psi / 345 kPa / 3.5 bar
- No Bypass

#### Assembly Weight

- HMK04 with short filter: 3.9 lbs/1.8 kg
- HMK04 with long filter: 4.8 lbs/2.2 kg
- HMK24: with short filter: 7.8 lbs/3.5 kg
- HMK24: with long filter: 9.6 lbs/4.4 kg

#### Operating Temperatures

- -20°F to 250°F / -29°C to 121°C (synthetic)
- -20°F to 225°F / -29°C to 107°C (cellulose)

#### Housing Fatigue Strength Ratings\*

- 100,000 Cycles: 0-500 psi / 0-3450 kPa / 34.5 bar
- 300,000 Cycles: 0-400 psi / 0-2758 kPa / 27.6 bar
- 1,000,000 Cycles: 0-350 psi / 0-2415 kPa / 24 bar

#### Filter Collapse Ratings

- 150 psid / 10 bar
- 300 psid / 20 bar also available

## HMK04/24 Specification Illustrations

***All dimensions are shown in inches [millimeters].***

## Assembly - Side Views

## Long Assembly

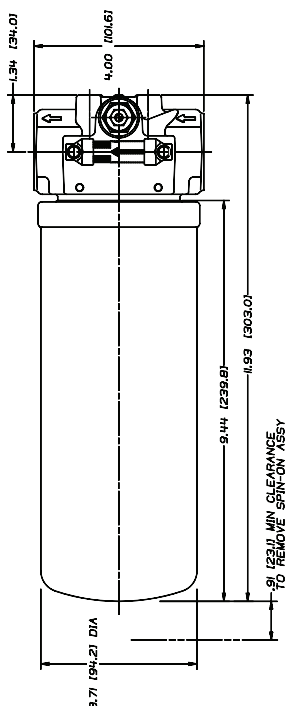

## Short Assembly

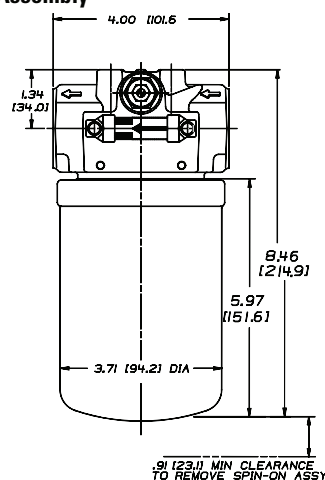

## Head - Top & Side Views

### HMK04 Head Top View with DC Electrical Indicator

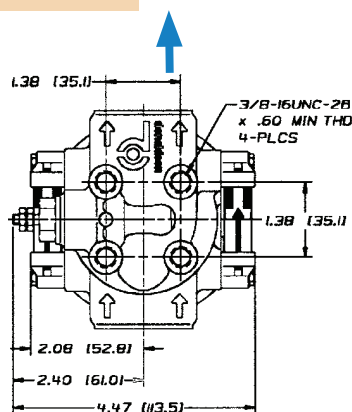

### HMK04 Head Top View

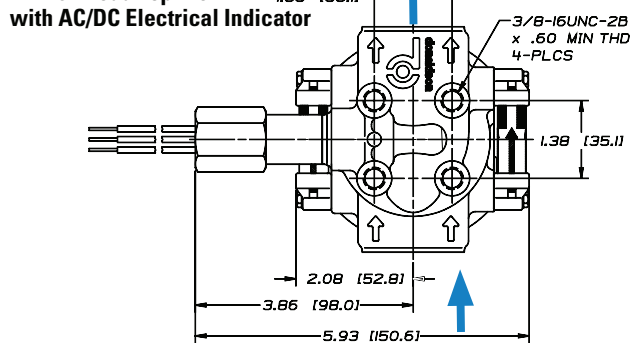

### HMK24 Head Side View

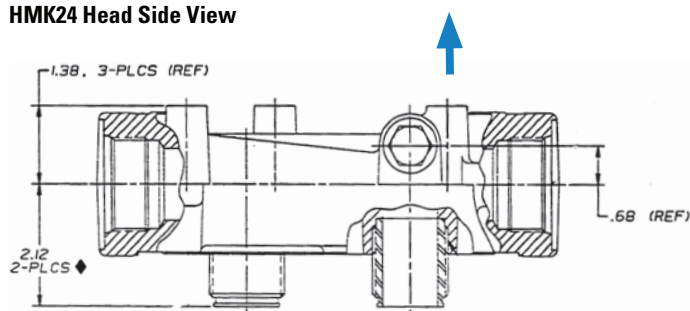

### HMK24 Head Top View

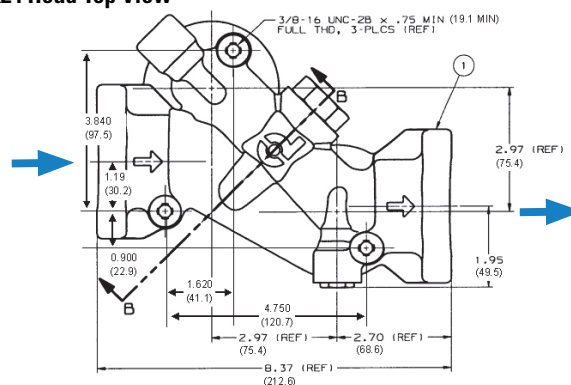





**HMK04/24**  
Max Flow: 35 gpm (133 lpm) / 60 gpm (227 lpm)



## HMK04/24 Components

### Filter Choices

Media Type	$\beta_{x(c)} = 2$ Rating based on ISO 16889	$\beta_{x(c)} = 1000$	Length in mm	Donaldson Part No.	Comments
Synteq Synthetic	<4 $\mu\text{m}$	9.4	240	P165185	<sup>1</sup> Viton® O-ring
	6 $\mu\text{m}$	5.97	152	P165354	
	6 $\mu\text{m}$	9.4	240	P165332	
	11 $\mu\text{m}$	5.97	152	P163542	500 psi collapse
	11 $\mu\text{m}$	5.97	152	P164375	
	11 $\mu\text{m}$	9.4	240	P164378	
	13 $\mu\text{m}$	9.4	240	P164056	<sup>1</sup> Viton O-ring
	14 $\mu\text{m}$	9.4	240	P177047	
	22 $\mu\text{m}$	9.4	240	P164059	<sup>1</sup> Viton O-ring
	23 $\mu\text{m}$	9.4	240	P163567	500 psi collapse
	23 $\mu\text{m}$	5.97	152	P164381	
	23 $\mu\text{m}$	9.4	240	P164384	
	50 $\mu\text{m}$	5.97	152	P165335	
	50 $\mu\text{m}$	9.4	240	P165338	
Water Absorbing	10 $\mu\text{m}$	9.4	240	P560584	
Wire Mesh	150 $\mu\text{m}$	9.4	240	P573301	

#### Filter Notes

- Refer to table in the Technical Reference Guide for fluid compatibility with our filter media.
  - Standard filter collapse rating is 150 psi, except as noted.
  - Thread size is 1 3/8"-12 UNF-2B
  - <sup>1</sup> Filters with seals made of Buna-N® are appropriate for most applications involving petroleum oil. Filters with seals made of Viton® (a fluorocopolymer) are required when using diester, phosphate ester fluids, water glycol, water/oil emulsions and HWCF (high water content fluids) over 150°F. Donaldson offers both types.
- Buna-N® Viton® are a registered trademarks of E. I. DuPont de Nemours and Company.



#### NOTE:

Lubricate filter-to-head threads when installing new filter to prevent thread damage. Heavyweight gear lube is recommended.

## Head Choices for HMK24 (double)



Parallel Flow

Port Size	Bypass Rating	Indicator Options <sup>1</sup>	Part No.
SAE-20 O-Ring	None	A, B, C, E, F, H	P179609
1 1/4" SAE 4-Bolt Code 61	50 psi	A, B, C, E, F, H	P179582

<sup>1</sup>Reference illustration on next page for service indicator styles.

## Performance Data

**HMK04 Filter Only**  
(Synthetic, 6"/152mm)

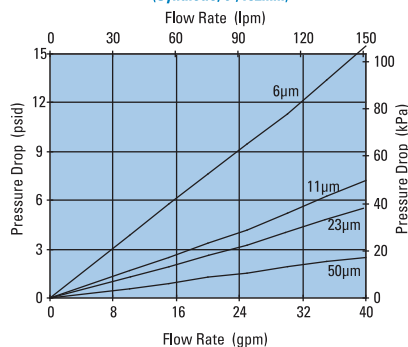

**HMK04 Filter Only**  
(Synthetic, 9.4"/240mm)

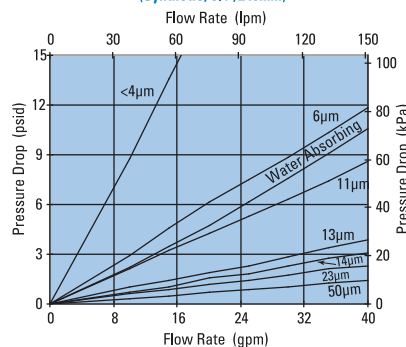

**HMK04/24 Head Only**

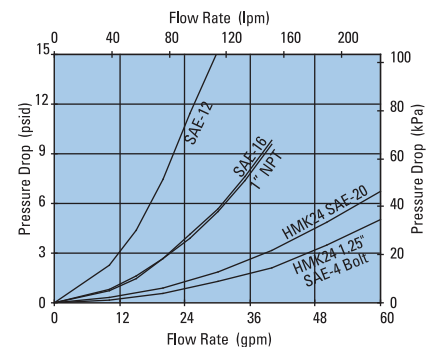



## Head Choices for HMK04 (single)

Port Size	Bypass Rating	Standard Indicator Style & Location <sup>1,2</sup>	Indicator Options	Head Part No.
3/4" NPT	25 psi / 172 kPa	None	None	P169317
		D (Visual), Left Side	None	P169310
SAE-12 O-Ring	25 psi / 172 kPa	None	None	P167473
		D (Visual), Left Side	None	P166387
	No Bypass	D (Visual), Left Side (25 psi)	None	P169320
		None	None	P165434
	No Bypass	D (Visual), Left Side (50 psi)	None	P173750
SAE-12 O-Ring (3 ports)	50 psi / 345 kPa	A (Electrical, P165194)	B, C, E, F, H	P167529
1" NPT	25 psi / 172 kPa	D (Visual), Both Sides	A, B, C, E, F, H	P166086
		None	None	P169309
		D (Visual), Left Side	None	P166416
SAE-16 O-Ring	15 psi / 100 kPa	None	A, B, C, E, F, H	P176569
SAE-16 O-Ring	25 psi / 172 kPa	None	None	P163681
		D (Visual), Left Side	None	P166417
		D (Visual), Both Sides	A, B, C, H	P166088
		E (Electrical, P177361)	None	P176568
		A (Electrical, P162400)	B, C, H	P165537
		No Bypass	D (Visual), Both Sides (25 psi)	A, B, C, F, H
	50 psi / 345 kPa	A (Electrical, P162400)	B, C, F, H	P166902
		D (Visual), Right Side)	All	P179381
		No Bypass	None	P164667
		50 psi / 345 kPa	None	P167201
		A (Electrical, P165194)	B, C, E, H	P166862
		5 psi	D (Visual), Both Sides	All
SAE-16 O-Ring	5 psi	D (Visual), Both Sides	All	P564850
1" NPT	No Bypass	D (Visual), Left Side (25 psiD)	None	P564484
1" NPT	25 psi / 172 kPa	D (Visual), Left Side (25 psiD)	None	P564485

### NOTE:

Lubricate filter-to-head threads when installing new filter to prevent thread damage.  
Heavyweight gear lube is recommended.



### Head Notes

<sup>1</sup>Reference illustration below for indicator styles.  
<sup>2</sup>Donaldson uses the inlet port as the reference point. "Left side," for instance, means that the indicator mounts on the side of the filter head that is on your left when you face the inlet port.

## 3-Port Head for Charge Pumps



The **P167529** head is designed with a 50 psi / 3.45 bar third port bypass valve that diverts all bypass flow back to the reservoir, instead of going straight through the head and into the system as it does in 2-ported heads. Unfiltered fluid is NOT allowed into the system in the case of plugged filters. Designed primarily for charge pump applications.

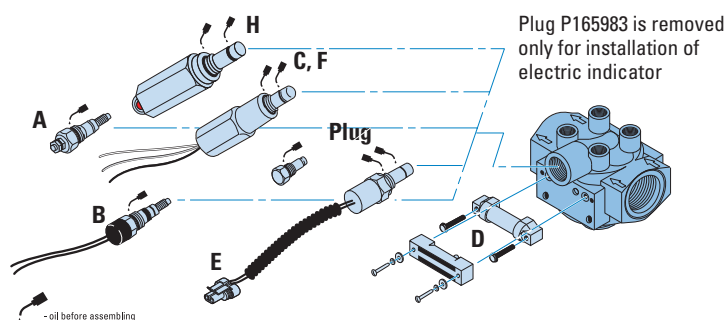

## Service Indicator Choices

Use with Bypass Valve Pressure of:	Indicator Part No.	Style <sup>3</sup>
<b>Visual Models (non-electric)<sup>2</sup></b>		
15 psi / 103 kPa	P162642	D
25 psi / 172.5 kPa	P162696	D
50 psi / 345 kPa	P167580	D
N/A	P165984	(blank plate)
25 psi / 172.5 kPa	P165965	D Heavy-Duty
50 psi / 345 kPa	P574177	D Heavy-Duty
25 psi / 172.5 kPa	P575334	H Pop up
50 psi / 345 kPa	P575335	H Pop up

### Indicator Notes

<sup>1</sup>All electric models have a maximum operating temperature of 250°F / 121°C.

<sup>2</sup>All non-electric models have a maximum operating temperature of 180°F / 82°C.

<sup>3</sup>Complete details on all service indicators can be found in the accessories section.

## Service Indicator Choices

Use with Bypass Valve Pressure of:	Indicator Part No.	Style <sup>3</sup>	Description
<b>Electric Models<sup>1</sup></b>			
5 psi / 34.5 kPa	P163642	A	Single post DC.
15 psi / 103 kPa	P163601	A	Single post DC.
25 psi / 172.5 kPa	P163839	A	Single post DC. N.C.
25 psi / 172.5 kPa	P162400	A	Single post DC. N.O.
25 psi / 172.5 kPa	P171143	B	DC 2-wire.
25 psi / 172.5 kPa	P173944	C	AC/DC 3-wire.
50 psi / 345 kPa	P165194	A	Single post DC. N.O.
50 psi / 345 kPa	P574968	B	DC 2-wire.
50 psi / 345 kPa	P574967	E	DC 2-wire.
50 psi / 345 kPa	P575549	F	DC 3-wire.
50 psi / 345 kPa	P174396	C	AC/DC 3-wire.



HMK05/25

Max Flow: 50 gpm (189 lpm) / 100 gpm (379 lpm)



## HMK05/25 DURAMAX® Spin-On Filters

**Working Pressures to:** 350 psi  
2415 kPa  
24.2 bar

**Rated Static Burst to:** 800 psi  
5520 kPa  
55.2 bar

Flow Range To:	HMK05	HMK25
	50 gpm	100 gpm
	189 lpm	379 lpm



Parallel Flow

### Features

HMK05 (single) and HMK25 (double) Duramax spin-on filters are perfect for high-flow applications, featuring a heavy-duty steel body and die-cast top plate for added strength. A special head-to-canister O-Ring seal prevents leakage. Buna-N® seals are standard. Fluorocarbon Viton® seals are available. Both models use the same replacement filters and have identical pressure ratings, so there's no need to inventory two different replacement filters. The HMK25 double filter head means twice the flow capability, with two filters to hold more contaminant.

Take advantage of Donaldson's mix and match system of in-stock heads, housings and media choices for exactly what you need. Media options include wire mesh and Donaldson's exclusive Synteq™ synthetic media.

#### Beta Rating

- Performance to  $\beta_{<4(c)} = 1000$

#### Porting Size Options

- HMK05 1 1/4" NPT
- HMK05 SAE-20 O-ring
- HMK25 1 1/2" NPT
- HMK25 SAE-24 O-ring
- HMK25 1 1/2" SAE 4-Bolt Flange Code 61

#### Replacement Filter Lengths

- 7.6" / 193mm
- 11.63" / 295.4mm
- 14.2" / 361mm

#### Standard Bypass Ratings

- 25 psi / 173 kPa / 1.73 bar
- 50 psi / 345 kPa / 3.5 bar
- No Bypass

#### Assembly Weight

- 7.5 lbs / 3.4 kg (single)
- 16 lbs / 7.3 kg (double)

#### Operating Temperatures

- -20°F to 250°F / -29°C to 121°C (synthetic)
- -20°F to 225°F / -29°C to 107°C (cellulose)
- -20°F to 250°F / -29°C to 121°C (wire mesh)

#### Housing Fatigue Strength Ratings\*

- 100,000 Cycles: 0-350 psi / 0-2413 kPa / 24.1 bar
- 300,000 Cycles: 0-300 psi / 0-2068 kPa / 20.7 bar
- 1,000,000 Cycles: 0-250 psi / 0-1734 kPa / 17.3 bar

#### Filter Collapse Ratings

- 200 psi / 13.8 bar

#### Filter Head Construction

- Standard Head Cast Aluminum
- Ductile Iron Available in HMK25

## HMK05/25 Specification Illustrations

All dimensions are shown in inches [millimeters].

### Assembly - Side Views

#### HMK25

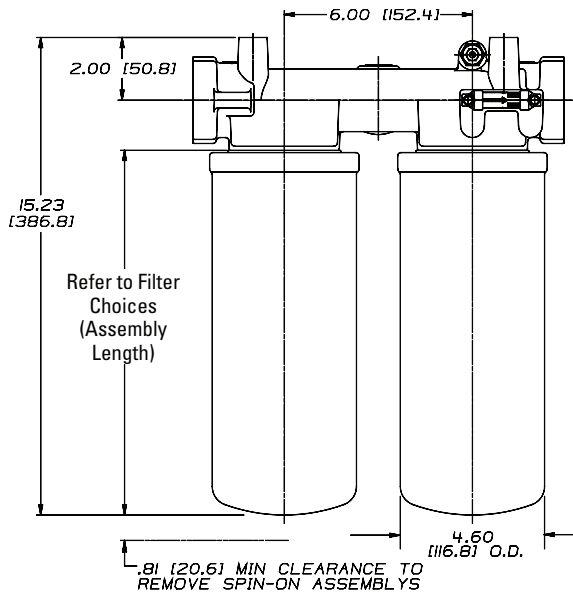

#### HMK05

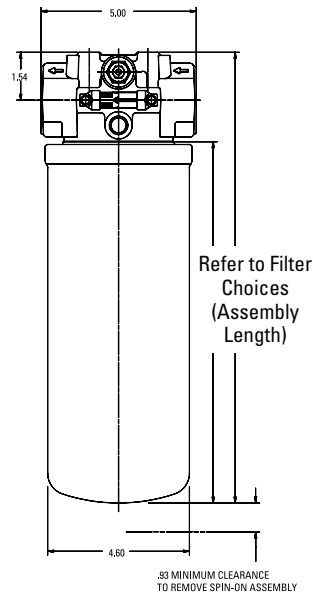

### Applications

- Case Drains
- Cooling Circuits
- Fluid Conditioning Systems
- Fuel Transfer
- Hydrostatic Charge Pumps
- Lube Oil Systems
- Power Transmissions
- Return Lines
- Side Loop Systems

### Head - Top Views

#### HMK05

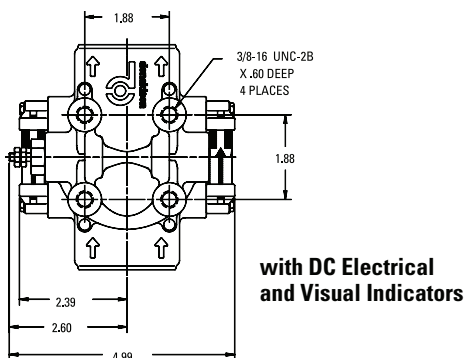
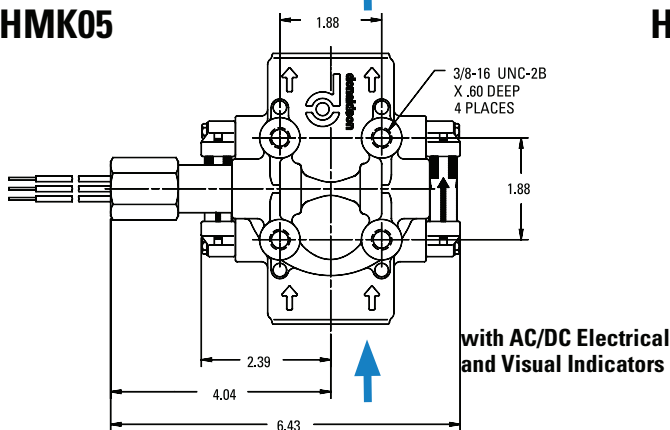

#### HMK25

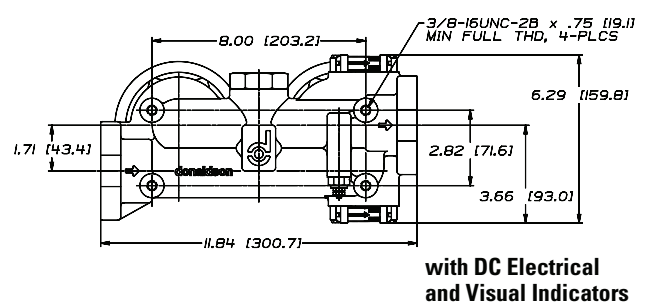
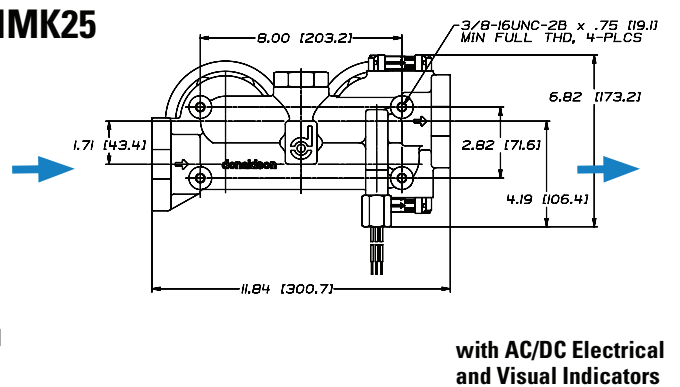



**HMK05/25**  
Max Flow: 50 gpm (189 lpm) / 100 gpm (379 lpm)



## HMK05/25 Components

### Filter Choices

Media Type	$\beta_{x(c)} = 2$ Rating based on ISO 16889	$\beta_{x(c)} = 1000$	Length		Donaldson Part No.	Comments
Synteq Synthetic	<4 $\mu\text{m}$	14.2	361		P564468	<sup>1</sup> Viton, Epoxy
	6 $\mu\text{m}$	11.6	294		P165675	
	6 $\mu\text{m}$	11.6	294		P171274	<sup>1</sup> Viton, Epoxy
	6 $\mu\text{m}$	14.2	361		P179763	
	11 $\mu\text{m}$	7.6	193		P176207	
	11 $\mu\text{m}$	11.6	294		P165659	
	11 $\mu\text{m}$	11.6	294		P171275	<sup>1</sup> Viton, Epoxy
	11 $\mu\text{m}$	14.2	361		P170949	
	23 $\mu\text{m}$	7.6	193		P176208	
	23 $\mu\text{m}$	11.6	294		P165569	
	23 $\mu\text{m}$	11.6	294		P171276	<sup>1</sup> Viton Epoxy
	23 $\mu\text{m}$	14.2	361		P173789	
	50 $\mu\text{m}$	11.6	294		P165672	
	50 $\mu\text{m}$	14.2	361		P573353	
Water Absorbing	10 $\mu\text{m}$		11.6	294	P179075	Absorbs 300 ml water
Wire Mesh	150 $\mu\text{m}$		11.6	294	P173943	

#### Filter Notes

- Refer to table in the Technical Reference Guide for fluid compatibility with our filter media.
- Thread size is 1 3/4"-12 UNF-2B
- <sup>1</sup>Filters with seals made of Buna-N® are appropriate for most applications involving petroleum oil. Filters with seals made of Viton® (a fluor elastomer) are required when using diester, phosphate ester fluids, water glycol, water/oil emulsions and HWCF (high water content fluids) over 150°F. Donaldson offers both types.

### Oil Service Indicator Options

Use with Bypass Valve Pressure of:	Indicator Part No.	Style <sup>3</sup>	Description
<b>Electric Models<sup>1</sup></b>			
5 psi / 34.5 kPa	P163642	A	Single post DC
15 psi / 103 kPa	P163601	A	Single post DC.
25 psi / 172.5 kPa	P163839	A	Single post DC. N.C.
25 psi / 172.5 kPa	P162400	A	Single post DC. N.O.
25 psi / 172.5 kPa	P171143	B	DC 2-wire
25 psi / 172.5 kPa	P173944	C	AC/DC 3-wire
50 psi / 345 kPa	P165194	A	Single post DC. N.O.
50 psi / 345 kPa	P574968	B	DC 2-wire
50 psi / 345 kPa	P574967	E	DC 2-wire
50 psi / 345 kPa	P575549	F	DC 3-wire
50 psi / 345 kPa	P174396	C	AC/DC 3-wire

Use with Bypass Valve Pressure of:	Indicator Part No.	Style <sup>3</sup>
<b>Visual Models (Non-Electric)<sup>2</sup></b>		
15 psi / 103 kPa	P162642	D
25 psi / 172.5 kPa	P162696	D
50 psi / 345 kPa	P167580	D
N/A	P165984	(blank plate)
25 psi / 172.5 kPa	P165965	D Heavy-duty
50 psi / 345 kPa	P574177	D Heavy-duty
25 psi / 172.5 kPa	P575334	H (Pop up)
50 psi / 345 kPa	P575335	H (Pop up)

### Service Parts

#### HMK05

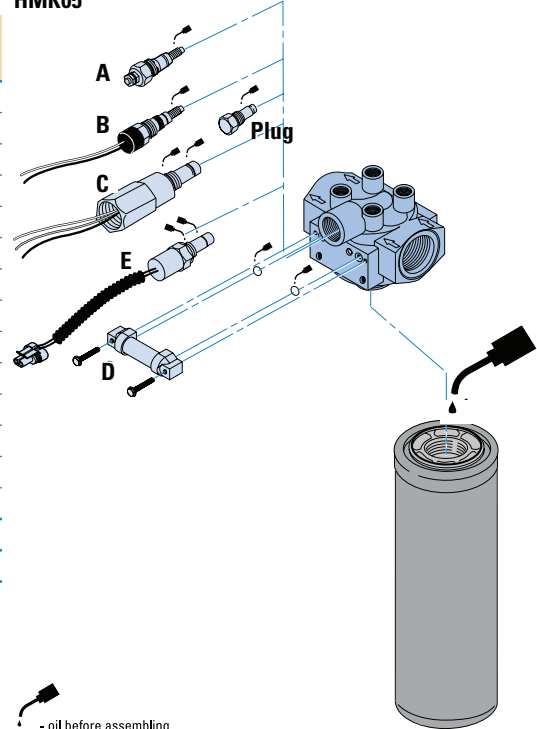

#### HMK25

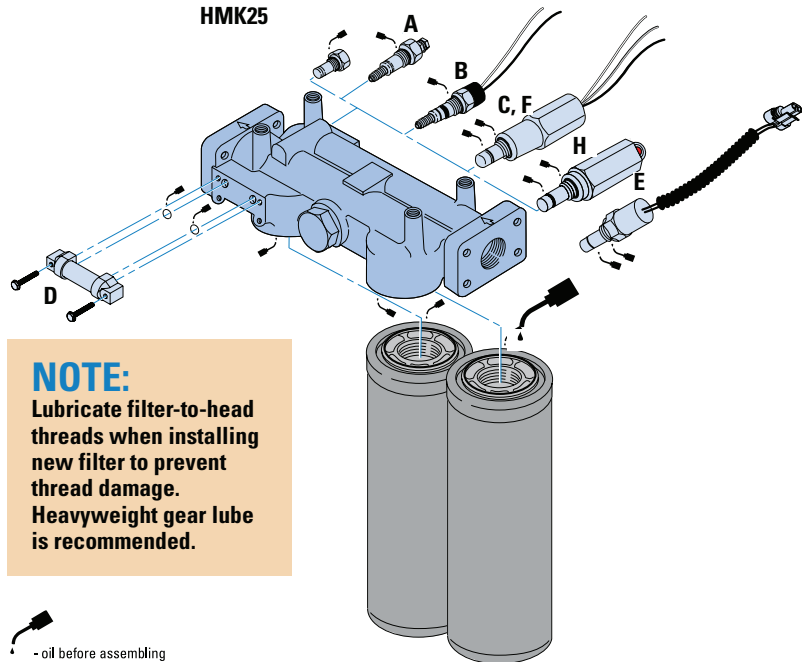

**NOTE:**  
Lubricate filter-to-head threads when installing new filter to prevent thread damage. Heavyweight gear lube is recommended.

- oil before assembling

#### Indicator Notes

- <sup>1</sup>All electric models have a maximum operating temperature of 250°F/ 114°C.
- <sup>2</sup>All non-electric models have a maximum operating temperature of 180°F/ 82°C.
- <sup>3</sup>Complete details on all service indicators can be found in the accessories section.

Buna-N® Viton® are a registered trademarks of E. I. DuPont de Nemours and Company.

## Head Choices for HMK05 (single)

Port Size	Bypass Rating	Standard Indicator Style & Location <sup>1</sup>	Indicator Options <sup>2</sup>	Part No.
1¼" NPT	25 psi / 172 KPa	D (Visual), Both Sides (25 psi)	A, B, C, E, F	P167294
1¼" NPT	25 psi / 172 KPa	A (Electrical) (25 psi)	A, B, C, E, F	P167621
	25 psi / 172 KPa	D (Visual), Left Side (25 psi)	D	P167622
SAE-20 O-Ring	25 psi / 172 KPa	D (Visual), Both Sides (25 psi)	A, B, C, E, F	P165973
	25 psi / 172 KPa	None	None	P167619
	50 psi / 345 KPa	D (Visual), Left Side, Blank Plate Right Side	A, B, C, E, F	P561885
	No Bypass	D (Visual), Both Sides (25 psi)	A, B, C, E, F	P166663
	No Bypass	D (Visual), Right Side (25 psi)	D	P564486
	No Bypass	D (Visual), Both Sides (50 psi)	A, B, C, E, F	P564858



Single Head



Dual Head

## Head Choices for HMK25 (dual)

Port Size	Bypass Rating	Indicator Style & Location <sup>1</sup>	Indicator Options <sup>2</sup>	Part No.
1½" NPT	25 psi / 172 KPa	D (Visual), Left side only	A,B,C,E,F	P169985
1½" SAE 4-Bolt Flange	25 psi / 172 kPa	D (Visual), Both sides	A,B,C,E,F	P167296
	No Bypass	D (Visual), Both Sides	A,B,C,E,F	P169984
SAE-24 O-Ring	25 psi / 172 kPa	D (Visual), Both sides	A,B,C,E,F	P167297
1½" SAE 4-Bolt Flange	50 psi / 345 kPa	Visual RH	A,B,C,E,F	P560855*

\* Ductile Iron Construction

### NOTE:

Lubricate filter-to-head threads when installing new filter to prevent thread damage. Heavyweight gear lube is recommended.

## Head Choice for HMK05 (3rd port return)

Port Size	Bypass Rating	Indicator Style & Location <sup>1</sup>	Indicator Options <sup>2</sup>	Part No.
1¼" SAE 4-Bolt Flange (3rd port: 1" SAE 4-Bolt)	50 psi / 345 kPa	None	A,B,C,E,F	P561924

### Head Notes

<sup>1</sup>Donaldson uses the inlet port as the reference point. "Left side," for instance, means the indicator mounts on the Left side when you face the inlet port.

<sup>2</sup>May be purchased separately.

\*Complete details on all service indicators can be found in the accessories section.

## 3-Port Head



The **P561924** head is designed with a 50 psi / 3.45 bar third port bypass valve that diverts all bypass flow back to the reservoir, instead of going straight through the head and into the system as it does in 2-ported heads. Unfiltered fluid is NOT allowed into the system in the case of plugged filters. Designed primarily for charge pump applications.

## Performance Data

HMK05 Filter Only  
(Synthetic, 11.6"/294mm)

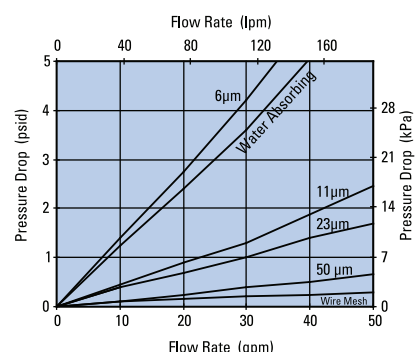

HMK05 Filter Only  
(Synthetic, 14.2"/361mm)

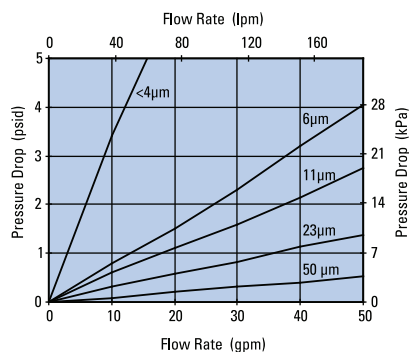

HMK05/25 Head Only

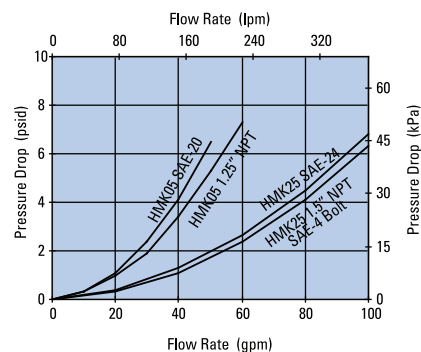





HNK04/05

Max Flow: 35 gpm (133 lpm) / 50 gpm (189 lpm)



## HNK04/05 DURAMAX® Spin-On Filters

<b>Working Pressures to:</b>	<b>HNK04</b>	<b>HNK05</b>
	500 psi	350 psi
	3450 kPa	2415 kPa
	34.5 bar	24.1 bar

<b>Rated Static Burst to:</b>	<b>HNK04</b>	<b>HNK05</b>
	1000 psi	800 psi
	6895 kPa	5515 kPa
	69 bar	55 bar

<b>Flow Range To:</b>	<b>HNK04</b>	<b>HNK05</b>
	35 gpm	50 gpm
	133 lpm	189 lpm



## Features

HNK Duramax® filters utilize a RadialSeal™ design – making servicing easier and providing a more reliable seal without having to torque to specification.

- Applications include hydrostatic charge side filtration, pilot circuits, power shift transmissions and kidney loop circuits.
- Utilizes Synteq™ filter media for high filtration efficiency and higher dust-holding capacity.
- Improved performance including higher burst, greater fatigue strength and longer filter life.

### Beta Rating

- Performance to  $\beta_{6(c)}=1000$

### Porting Size Options

- HNK04: SAE-12, SAE-16 O-ring
- HNK05: SAE-20 O-ring

### Replacement Spin-On Lengths

- 04 short: 5.97" / 151.7 mm
- 04 long: 9.44" / 239.8 mm
- 05 short: 11.63" / 295.4 mm
- 05 long: 14.24" / 361.7 mm

### Assembly Weight

- 04 short: 5.97" length - 3.95 lbs / 1.8 kg
- 04 long: 9.44" length - 4.7 lbs / 2.1 kg
- 05 short: 11.63" length - 7.35 lbs / 3.3 kg
- 05 long: 14.24" length - 8.0 lbs / 3.6 kg

### Operating Temperatures

- -20° to 250°F (-29° to 121°C)

### Standard Bypass Ratings

- 50 psi / 345 kPa / 3.5 bar
- No Bypass

### Filter Collapse Ratings

- 235 psi / 1621 kPa / 16.2 bar



## HNK04/05 Specification Illustrations

All dimensions are shown in inches [millimeters].

### Applications

- Case Drains
- Cooling Circuits
- Fluid Conditioning Systems
- Fuel Transfer
- Hydrostatic Charge Pumps
- Lube Oil Systems
- Power Transmissions
- Return Lines
- Side Loop Systems

### HNK04 Spin-on Assembly - Side View

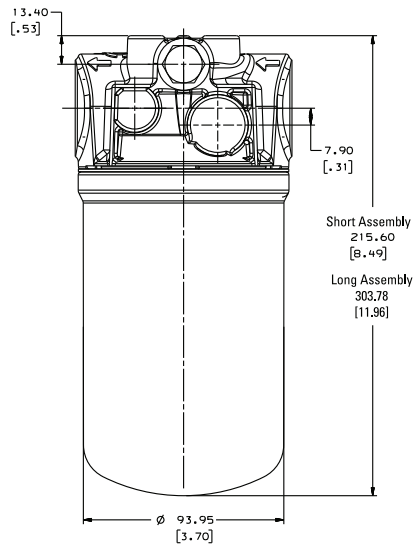

### HNK05 Spin-on Assembly - Side View

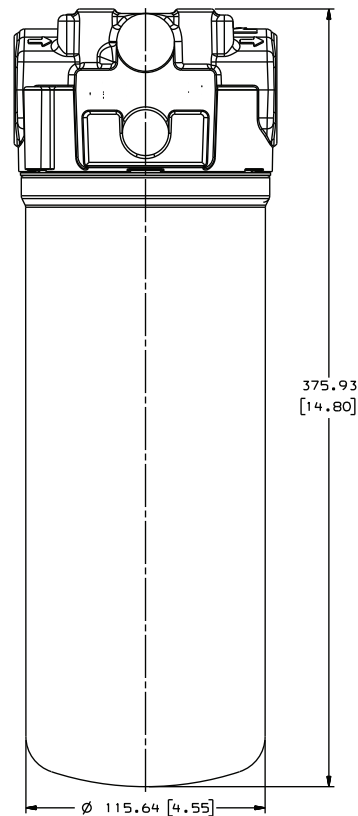

### HNK04 Head - Top View

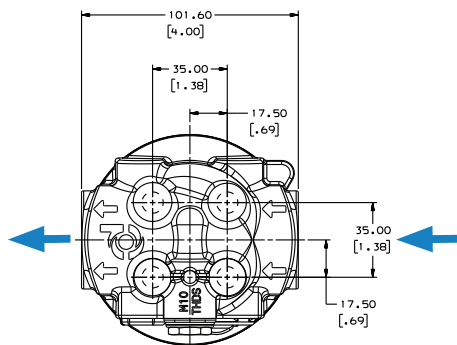

### HNK05 Head - Top View

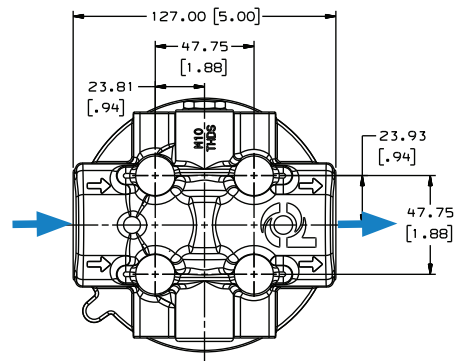



## HNK04/05

Max Flow: 35 gpm (133 lpm) / 50 gpm (189 lpm)



## HNK04/05 Components

### Head Choices for HNK04

Port Size	Bypass Rating	Part Number	Indicators	Style	Mounting Threads
SAE-12	50 psi / 3.5 bar	P568856	none	optional elect.	3/8"-16 UNC
SAE-12	No bypass	P568857	none	optional elect.	3/8"-16 UNC
SAE-16	50 psi / 3.5 bar	P568858	none	optional elect.	3/8"-16 UNC
SAE-16	No bypass	P568859	none	optional elect.	3/8"-16 UNC

### Head Choices for HNK05

Port Size	Bypass Rating	Part Number	Indicators	Style	Mounting Threads
SAE-20	50 psi / 3.5 bar	P568860	none	optional elect.	3/8"-16 UNC
SAE-20	No bypass	P568861	none	optional elect.	3/8"-16 UNC

### Indicator Choices

Set Point/Type	Part No.	Description
50 psi / 345 kPa	P165194	Electric Single post DC
25 psi / 172 kPa	P575334	Visual Indicator, Pop up
50 psi / 345 kPa	P575335	Visual Indicator, Pop up

### Filter Choices for HNK04

Media Type	$\beta_{x(c)} = 1000$ Rating based on ISO 16889	Length		Donaldson Part No.
		in	mm	
Synteq Synthetic	6 $\mu$ m	5.97	151.7	P569203
	6 $\mu$ m	9.44	239.8	P569204
	11 $\mu$ m	5.97	151.7	P569205
	11 $\mu$ m	9.44	239.8	P569206

### Filter Choices for HNK05

Media Type	$\beta_{x(c)} = 1000$ Rating based on ISO 16889	Length		Donaldson Part No.
		in	mm	
Synteq Synthetic	6 $\mu$ m	11.63	295.4	P569209
	6 $\mu$ m	14.24	361.7	P569210
	11 $\mu$ m	11.63	295.4	P569211
	11 $\mu$ m	14.24	361.7	P569212

#### Filter Notes

• Refer to table in the Technical Reference Guide for fluid compatibility with our filter media.



## Performance Data

### HNK04 Filter Only

(Synthetic, 5.97"/151.7mm & 9.44"/239.8 mm)

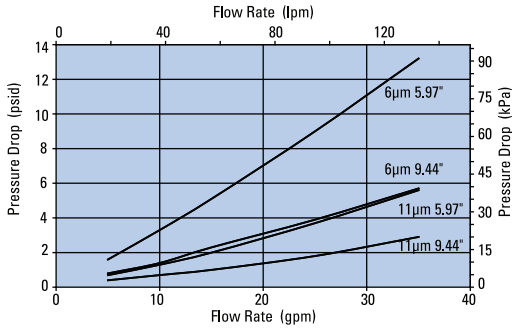

### HNK04 Head Only

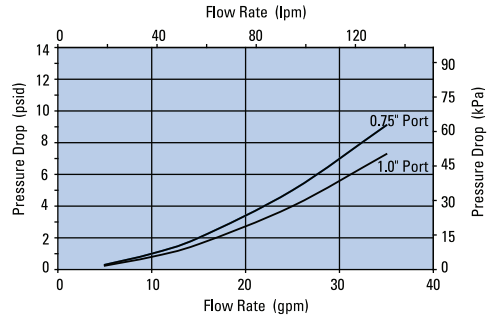

### HNK05 Filter Only

(Synthetic, 11.63"/295.4mm & 14.24"/361.7 mm)

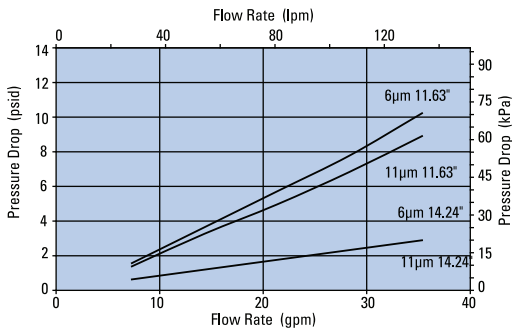

### HNK05 Head Only

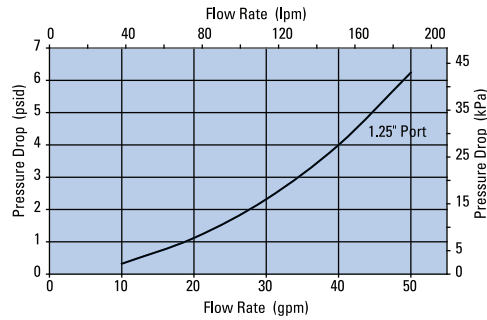

## Service Parts

**Plug**  
Remove only when  
installing indicator

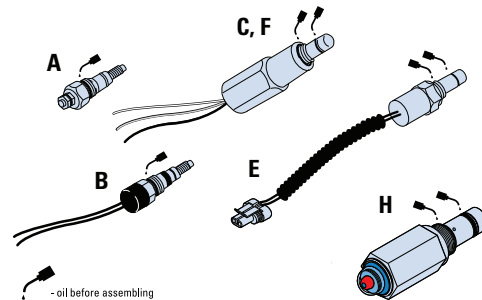
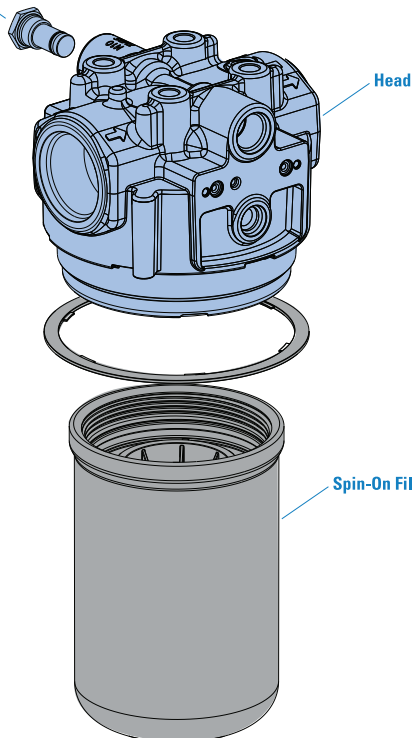

### SERVICE PARTS NOTE:

Some service parts may not be stocked. Please contact your Donaldson sales representative for lead time details.



Our FLK hydraulic filtration systems are packed with innovative features that will deliver cleaner, mistake-proof filter servicing.

### Applications

- Hydrostatic Charge Pumps
- Hydrostatic Transmission
- Pilot Control Circuits

### Integrated By-pass Valve

*Robust, proven design*

### Unique Head to Cartridge Interface Connection

### RadialSeal™ Sealing Technology

- No metal-to-metal contact – downstream flow
- Robust, reliable seal on clean side of filter – prevents cross contamination of oil

### Filter Cartridge

- Double wire mesh support on outside of cartridge maintains pleat spacing under high pressure differential
- Locking grab handles makes for cleaner servicing and simplifies filter position during servicing

### Industrial Hand Grips

*No special servicing tools needed*

### RadialSeal™ Sealing Technology

- No metal-to-metal contact – upstream flow
- Easy-to-torque, mistake-proof sealing
- Robust, reliable seal

### Anti-dust Seal

- Keeps threads free from contamination
- Easier to remove and reassemble during service

### Synteq XP Media Technology

*Delivers high performance – lower pressure drop, superior cold-start filtration and extended filter life*

### Closed End Cap

*Eliminates the possibility of contamination to clean side of assembly during servicing*

### Oil Drain Port

*Oil drain port used to drain oil during servicing*

### Locking Grab Handles

*Cleaner, easier servicing*

## IMPORTANT SERVICE INSTRUCTIONS:

To prevent thread damage when installing new filter, fully lubricate the entire thread and o-ring surface with a Molybdenum-containing gear oil or anti-seize paste such as Schaeffer #214S Supreme One 80W-140 gear oil or Dow Corning Molykote P-37 anti-seize past.

## FLK90 In-Line Cartridge Filters

**Working Pressures to:** 580 psi  
4002 kPa  
40 bar

**Rated Static Burst to:** 2000 psi  
13,790 kPa  
138 bar

**Flow Range To:** 40 gpm  
151 lpm



### IMPORTANT SERVICE INSTRUCTIONS:

To prevent thread damage when installing new filter, fully lubricate the entire thread and o-ring surface with a Molybdenum-containing gear oil or anti-seize paste such as Schaeffer #214S Supreme One 80W-140 gear oil or Dow Corning Molykote P-37 anti-seize past.

## Features

The FLK assembly is a robust, reusable housing and disposable cartridge design. The versatile FLK filter head accommodates multiple housing lengths. Industrial, raised hand grips make it easy to remove the housing from the head without the need for special servicing tools. The oil drain port on the bottom of the housing and the locking grab handles on the filter cartridge allow for cleaner, easier servicing. The filter tabs lock into place – simplifying positioning during reassembly. Short removal clearance is needed for filter replacement means the assembly can easily fit into tight spaces.

These assemblies utilize a unique sealing technology that protects systems from harmful ingressed contaminants and cross contamination of oil. The RadialSeal™ interface increases the surface area which provides a robust connection with superior vibration resistance, a common challenge in today's heavy-duty applications.

The FLK filters are offered with Synteq XP™ media, Donaldson's most advanced media technology. Each filter has extended surface area for advanced filtration performance. Synteq XP delivers better pressure drop and better contaminant holding capacity than standard filter media.

- Robust 4-point mount
- Oil drain port
- Optional 2-point mount
- Heads features: - one side machined/plugged for indicator

### Beta Rating

- Performance to  $\beta_{<6(c)} = 1000$

### Porting Size Options

- SAE-12 O-ring
- SAE-16 O-ring

### Replacement Filter Lengths

- 4.21" / 107 mm
- 8.23" / 209 mm

### Standard Bypass Ratings

- 50 psi / 345 kPa / 3.5 bar
- No bypass

### Assembly Weight

- Long Housing: 2.33 kg / 5.14 lbs
- Short Housing: 1.82 kg / 4.01 lbs

### Operating Temperatures

- -40° to 250°F (-40° to 121°C)

### Filter Collapse Ratings

- 145 psid / 1000 kPa / 10 bar (standard)



**FLK90**  
Max Flow: 40 gpm (151 lpm)



## FLK Specification Illustrations

**Long Assembly - Side View**

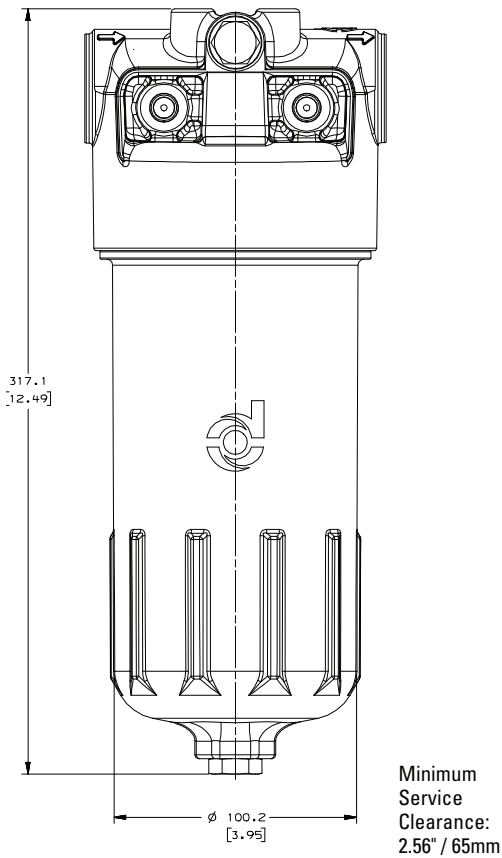

**Short Assembly - Side View**

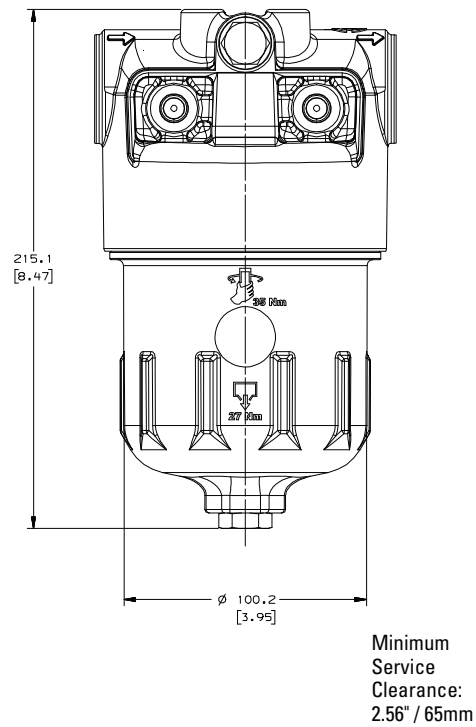

**Head - Top View**

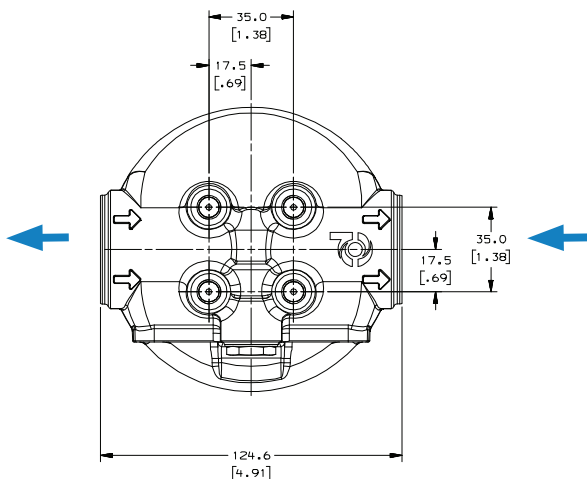



## FLK90 Components

### Head Choices

Part No.	Port Connections	Bypass Valve
P574994	SAE-12	50 psi (3.4 bar) bypass
P574995	SAE-12	No bypass
P574996	SAE-16	50 psi (3.4 bar) bypass
P574997	SAE-16	No bypass

### Housing Choices

Part No.	Comments
P766990	Short length assembly
P766961	Long length assembly

### Filter Choices

Media Type	$\beta_{s(c)} = 1000$ Rating based on ISO 16889	Length in mm	Donaldson Part No.
<b>Short Length Assembly</b>			
Synteq XP	6 $\mu$ m	4.21	107 P767128
Synthetic	11 $\mu$ m	4.21	107 P766987
	15 $\mu$ m	4.21	107 P767129
<b>Long Length Assembly</b>			
Synteq XP	6 $\mu$ m	8.23	209 P767130
Synthetic	11 $\mu$ m	8.23	209 P766959
	15 $\mu$ m	8.23	209 P767131

### Service Indicator Choices

Use with Bypass Valve Pressure of:	Indicator Part No.	Style <sup>2</sup>	Description
<b>Electric Models<sup>1</sup></b>			
50 psi / 345 kPa	P165194	A	Single post DC. N.O.
50 psi / 345 kPa	P574968	B	DC 2-wire.
50 psi / 345 kPa	P574967	E	DC 2-wire.
50 psi / 345 kPa	P575549	F	DC 3-wire.
50 psi / 345 kPa	P174396	C	AC/DC 3-wire.
25 psi / 172.5 kPa	P575334	H	Visual pop up
50 psi / 345 kPa	P575335	H	Visual pop up

#### Indicator Notes

<sup>1</sup>All electric models have a maximum operating temperature of 250°F / 121°C.

<sup>2</sup>Complete details on all service indicators can be found in the accessories section.

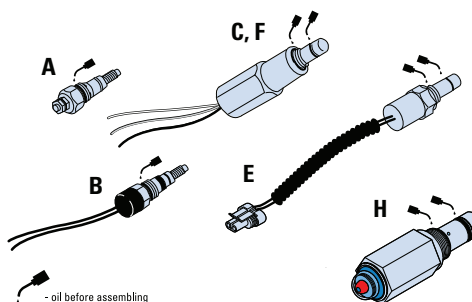

## Performance Data

FLK90 Short Housing Only

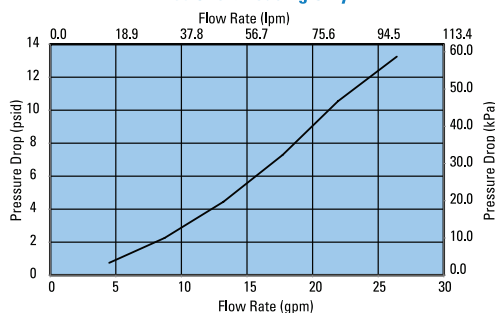

FLK90 Long Housing Only

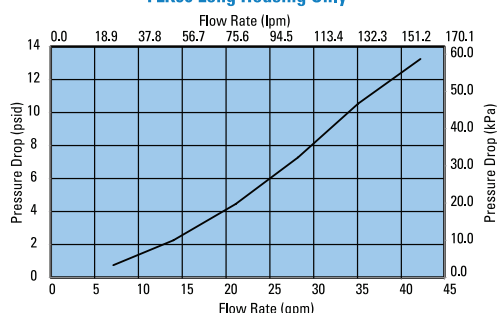

FLK90 Short Filter only  
(Synthetic Media, 10.43"/265mm)

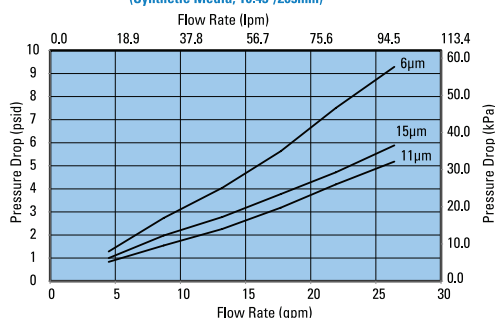

FLK90 Long Filter only  
(Synthetic Media, 10.43"/265mm)

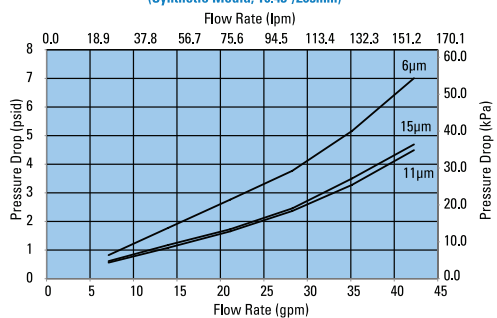



**FLK110**  
Max Flow: 42 gpm (159 lpm)



## FLK110 In-Line Cartridge Filters

**Working Pressures to:** 435 psi  
3001 kPa  
30 bar

**Rated Static Burst to:** 1300 psi  
8970 kPa  
90 bar

**Flow Range To:** 42 gpm  
159 lpm



### IMPORTANT SERVICE INSTRUCTIONS:

To prevent thread damage when installing new filter, fully lubricate the entire thread and o-ring surface with a Molybdenum-containing gear oil or anti-seize paste such as Schaeffer #214S Supreme One 80W-140 gear oil or Dow Corning Molykote P-37 anti-seize past.

## Features

The FLK assembly is a robust, reusable housing and disposable cartridge design. The versatile FLK filter head accommodates multiple housing lengths. Industrial, raised hand grips make it easy to remove the housing from the head without the need for special servicing tools. The oil drain port on the bottom of the housing and the locking grab handles on the filter cartridge allow for cleaner, easier servicing. The filter tabs lock into place – simplifying positioning during reassembly. Short removal clearance is needed for filter replacement means the assembly can easily fit into tight spaces.

These assemblies utilize a unique sealing technology that protects systems from harmful ingressed contaminants and cross contamination of oil. The RadialSeal™ interface increases the surface area which provides a robust connection with superior vibration resistance, a common challenge in today's heavy-duty applications.

The FLK filters are offered with Synteq XP™ media, Donaldson's most advanced media technology. Each filter has extended surface area for advanced filtration performance. Synteq XP delivers better pressure drop and better contaminant holding capacity than standard filter media.

- Robust 4-point mount
- Oil drain port
- Optional 2-point mount
- Heads features: - one side machined/plugged for indicator

### Beta Rating

- Performance to  $\beta_{<6(c)} = 1000$

### Porting Size Options

- SAE-20 O-ring

### Replacement Filter Lengths

- 7.4" / 187.9 mm
- 10.43" / 264.9 mm

### Filter Collapse Ratings

- 145 psid / 1000 kPa / 10 bar (standard)

### Standard Bypass Ratings

- 50 psi / 345 kPa / 3.5 bar
- No bypass

### Assembly Weight

- Long Housing: 1.34 kg / 2.95 lb
- Short Housing: 1.01 kg / 2.22 lb

### Operating Temperatures

- -40° to 250°F (-40° to 121°C)

## FLK Specification Illustrations

### Long Assembly - Side View

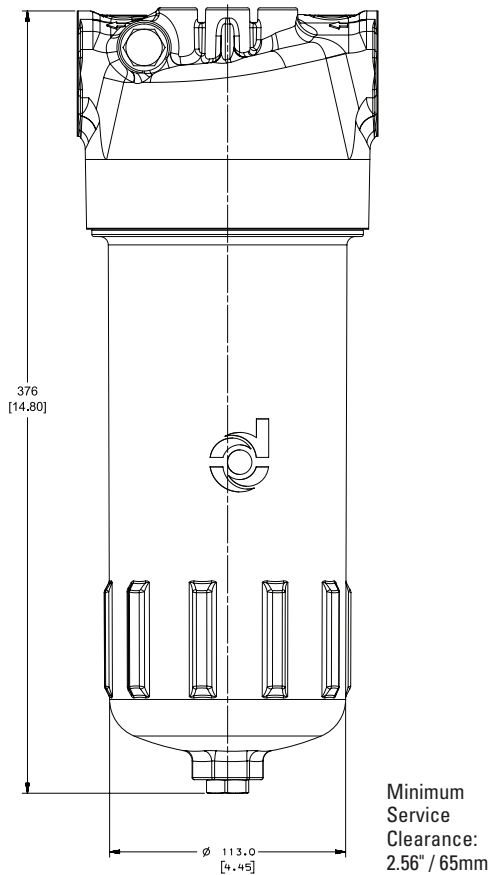

### Short Assembly - Side View

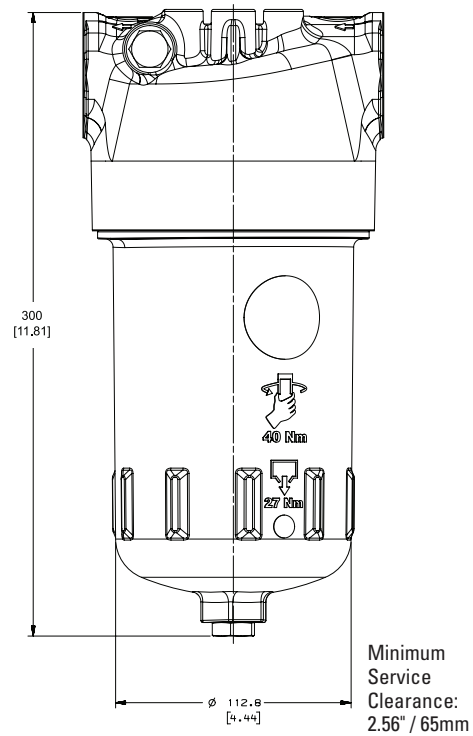

### Head - Top View

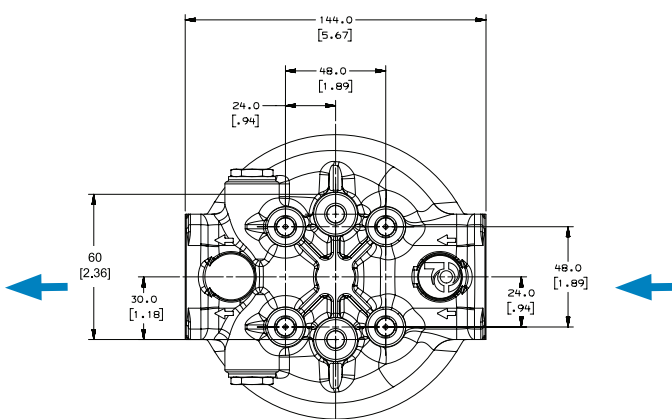

### Applications

- Hydrostatic Charge Pumps
- Hydrostatic Transmission
- Pilot Control Circuits



**FLK110**  
Max Flow: 42 gpm (159 lpm)



## FLK110 Components

### Head Choices

Part No.	Port Connections	Bypass Valve
P766831	SAE-20	50 psi (3.4 bar) bypass
P767009	SAE-20	No bypass

### Housing Choices

Part No.	Comments
P766812	Short length assembly
P766810	Long length assembly

### Filter Choices

Media	$\beta_{x(e)} = 1000$	Length		Donaldson
Type	Rating based on ISO 16889	in	mm	Part No.
Short Length Assembly				
Synteq XP	6 $\mu\text{m}$	7.4	187	P766847
Synthetic	11 $\mu\text{m}$	7.4	187	P766813
	15 $\mu\text{m}$	7.4	187	P767012
Long Length Assembly				
Synteq XP	6 $\mu\text{m}$	10.43	265	P767010
Synthetic	11 $\mu\text{m}$	10.43	265	P766811
	15 $\mu\text{m}$	10.43	265	P767011

### Service Indicator Choices

Use with Bypass	Indicator
Valve Pressure of:	Part No. Style <sup>2</sup> Description
<b>Electric Models<sup>1</sup></b>	
50 psi / 345 kPa	P165194 A Single post DC. N.O.
50 psi / 345 kPa	P574968 B DC 2-wire
50 psi / 345 kPa	P574967 E DC 2-wire
50 psi / 345 kPa	P575549 F DC 3-wire
50 psi / 345 kPa	P174396 C AC/DC 3-wire
25 psi / 172.5 kPa	P575334 H Visual pop up
50 psi / 345 kPa	P575335 H Visual pop up

#### Indicator Notes

<sup>1</sup>All electric models have a maximum operating temperature of 250°F / 121°C.  
<sup>2</sup>Complete details on all service indicators can be found in the accessories section.

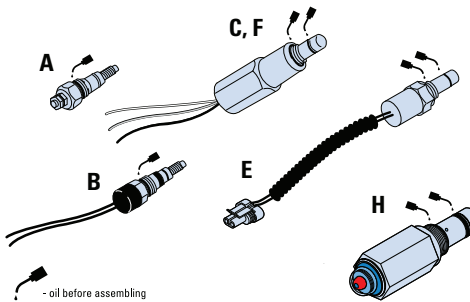

## Performance Data

FLK110 Short Housing Only

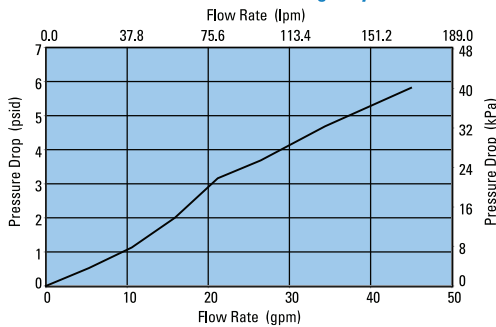

FLK110 Long Housing Only

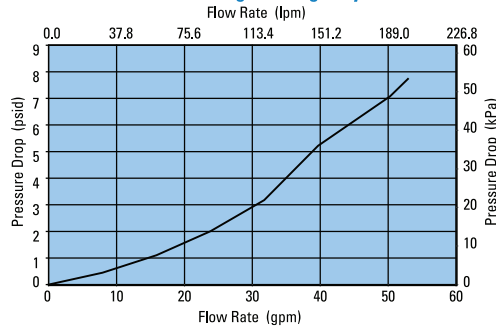

FLK110 7" Filter Only  
(Synthetic Synteq XP, 7.4"/187mm)

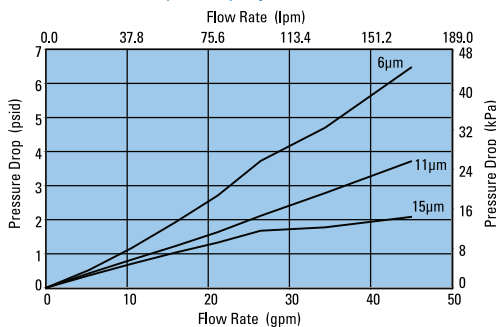

FLK110 10" Filter Only  
(Synthetic Synteq XP, 10.43"/265mm)

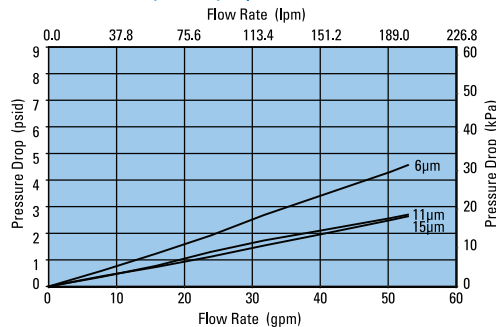

## FLK125 In-Line Cartridge Filters

**Working Pressures to:** 508 psi  
3505 kPa  
35.1 bar

**Rated Static Burst to:** 2000 psi  
13,790 kPa  
138 bar

**Flow Range To:** 85 gpm  
322 lpm

### Applications

- Hydrostatic Charge Pumps
- Hydrostatic Transmission
- Pilot Control Circuits



### IMPORTANT SERVICE INSTRUCTIONS:

To prevent thread damage when installing new filter, fully lubricate the entire thread and o-ring surface with a Molybdenum-containing gear oil or anti-seize paste such as Schaeffer #214S Supreme One 80W-140 gear oil or Dow Corning Molykote P-37 anti-seize past.

## Features

The FLK assembly is a robust, reusable housing and disposable cartridge design. The versatile FLK filter head accommodates multiple housing lengths. Industrial, raised hand grips make it easy to remove the housing from the head without the need for special servicing tools. The oil drain port on the bottom of the housing and the locking grab handles on the filter cartridge allow for cleaner, easier servicing. The filter tabs lock into place – simplifying positioning during reassembly. Short removal clearance is needed for filter replacement means the assembly can easily fit into tight spaces.

These assemblies utilize a unique sealing technology that protects systems from harmful ingressed contaminants and cross contamination of oil. The RadialSeal™ interface increases the surface area which provides a robust connection with superior vibration resistance, a common challenge in today's heavy-duty applications.

The FLK filters are offered with Synteq XP™ media, Donaldson's most advanced media technology. Each filter has extended surface area for advanced filtration performance. Synteq XP delivers better pressure drop and better contaminant holding capacity than standard filter media.

- Robust 4-point mount
- Oil drain port
- Optional 2-point mount
- Heads features: - one side machined/plugged for indicator

### Beta Rating

- Performance to  $\beta_{<6(c)}=1000$

### Porting Size Options

- 2" SAE 4 bolt flange code 61

### Replacement Filter Lengths

- 10.85" / 275.7 mm

### Standard Bypass Ratings

- 50 psi / 345 kPa / 3.5 bar

### Assembly Weight

- Long Housing: 4.76 kg / 10.50 lbs

### Operating Temperatures

- -40° to 250°F (-40° to 121°C)

### Filter Collapse Ratings

- 145 psid / 1000 kPa / 10 bar (standard)



**FLK125**  
Max Flow: 85 gpm (322 lpm)



## FLK Specification Illustrations

### Long Assembly - Side View

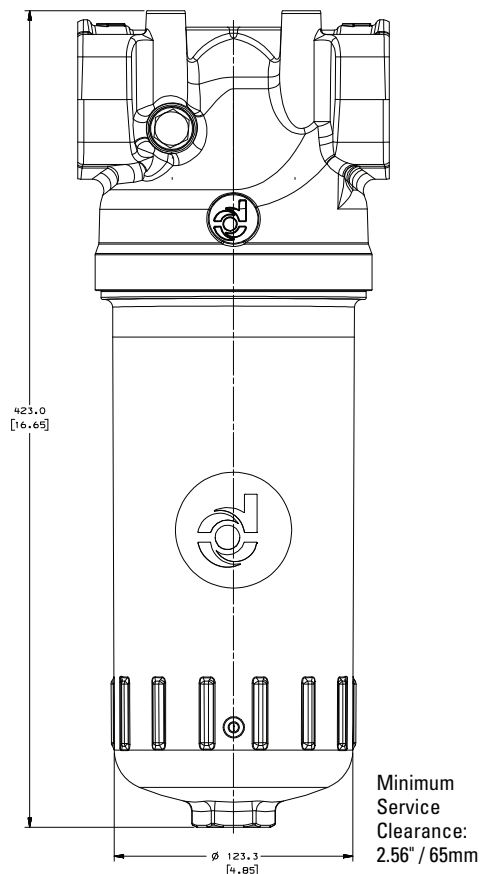

### Head - Top View

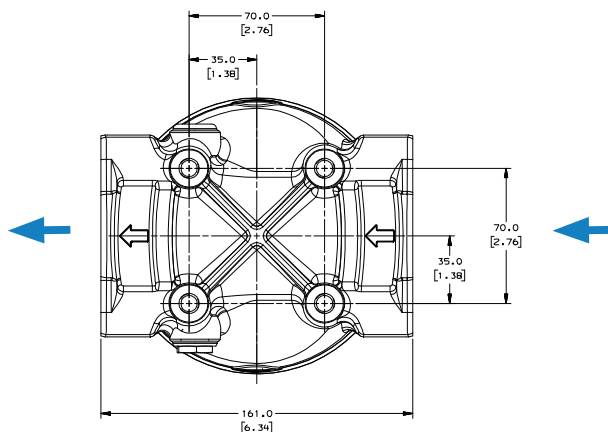



## FLK125 Components

### Head Choices

Part No.	Port Connections	Bypass Valve
P767095	2" SAE 4 bolt	50 psi (3.4 bar) bypass

### Housing Choices

Part No.	Comments
P767089	Long length assembly

### Filter Choices

Media	$\beta_{x(c)} = 1000$	Length		Donaldson
Type	Rating based on ISO 16889	in	mm	Part No.
Synteq XP	6 $\mu$ m	10.74	272.7	P767084
Synthetic	11 $\mu$ m	10.74	272.7	P767104
	15 $\mu$ m	10.74	272.7	P767106

### Service Indicator Choices

Use with Bypass	Indicator
Valve Pressure of:	Part No. Style <sup>2</sup> Description
<b>Electric Models<sup>1</sup></b>	
50 psi / 345 kPa	P165194 A Single post DC. N.O.
50 psi / 345 kPa	P574968 B DC 2-wire
50 psi / 345 kPa	P574967 E DC 2-wire
50 psi / 345 kPa	P575549 F DC 3-wire
50 psi / 345 kPa	P174396 C AC/DC 3-wire
25 psi / 172.5 kPa	P575334 H Visual pop up
50 psi / 345 kPa	P575335 H Visual pop up

#### Indicator Notes

<sup>1</sup>All electric models have a maximum operating temperature of 250°F / 121°C.  
<sup>2</sup>Complete details on all service indicators can be found in the accessories section.

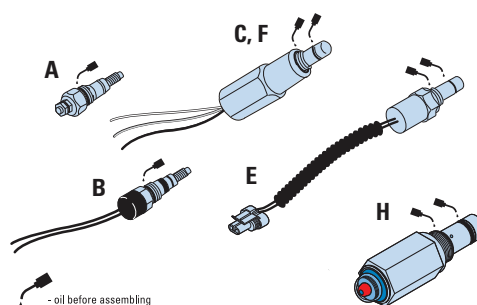

## Performance Data

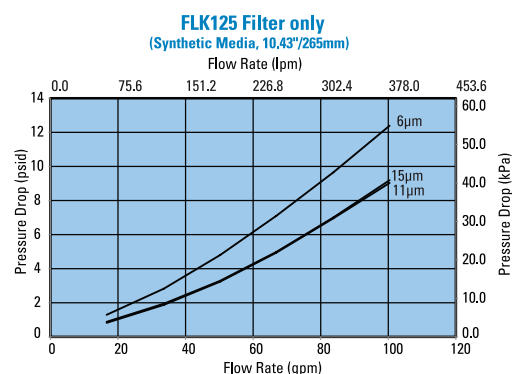
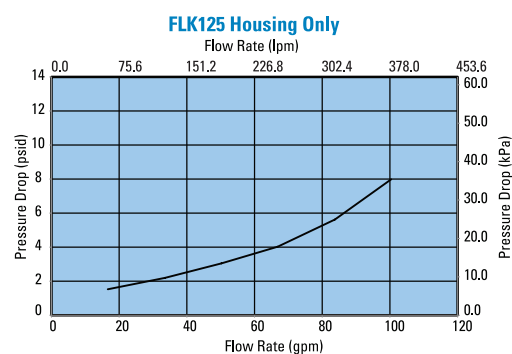



**DPK350**  
Max Flow: 100 gpm (379 lpm)



## DPK350 In-Line Cartridge Filters

**Working Pressures to:** 350 psi  
2400 kPa  
24 bar

**Rated Static Burst to:** 700 psi  
4800 kPa  
48 bar

**Flow Range To:** 100 gpm  
379 lpm



### Applications

- In-plant Systems
- Process Fluids
- Lube Oil Systems

### Features

DPK350 duplex filter assemblies allow continuous filtration during filter servicing to avoid machine shutdown. The DPK350 duplex design combines lighter weight aluminum heads with durable steel bowls for a high-performance assembly. Choose between optional features such as no by-pass, by-pass valve, visual indicators or combination electrical/visual indicators for a customized assembly that best fits the needs of your specific application. Filter performance ranges from 5 $\mu$  to 25 $\mu$  at beta 1000 and high collapse elements are available at 5 $\mu$  and 27 $\mu$ , offering additional flexibility to achieve the filtration level your system requires.

- Head Material: Anodized Aluminum Alloy
- Bowl Material: Steel
- Optional visual and visual / electric indicators
- Self locking transfer valve
- Automatic bleed-over valve

### Beta Rating

- Performance to  $\beta_{5(c)}=1000$

### Porting Size Options

- 1-1/2" SAE 4-Bolt Flange Code 61

### Replacement Filter Lengths

- 14.62" / 371 mm

### Filter Collapse Ratings

- 300 psid / 207 kPa / 21 bar (standard)
- 3045 psid / 2100 kPa / 210 bar (high collapse)

### Assembly Weight

- 44 lbs / 20 kg

### Operating Temperatures

- -40° to 250°F (-40° to 121°C)

### Standard Bypass Ratings

- 50 psi / 345 kPa / 3.5 bar
- No bypass

## DPK350 Specification Illustrations

### Assembly - Side Views

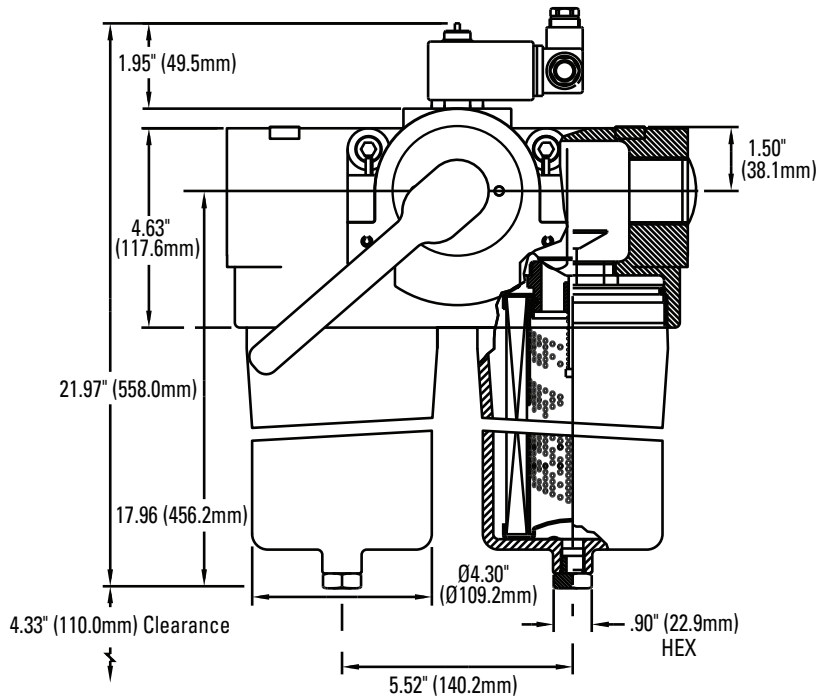

The handle shifts fluid flow from one filter to the other.

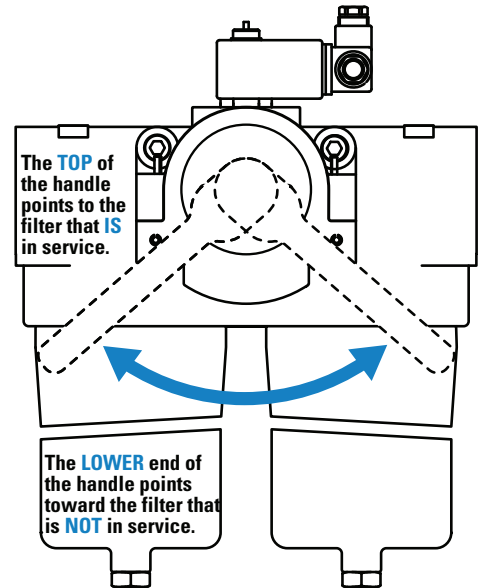

### Head - Top View

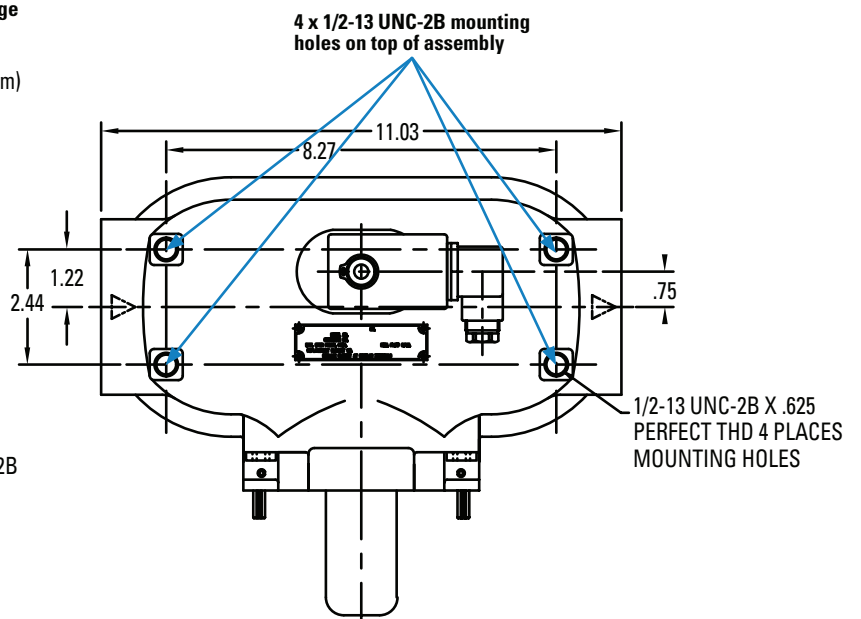
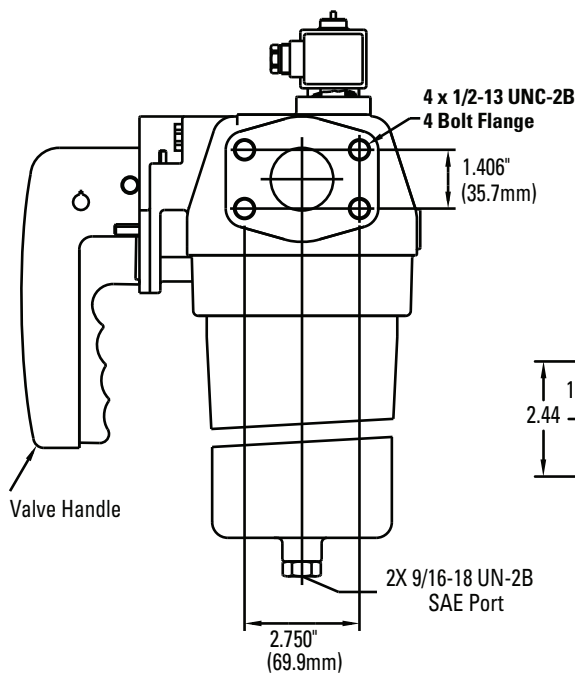



**DPK350**  
Max Flow: 100 gpm (379 lpm)



## DPK350 Components

### Assembly Choices

Part No.	Port Connections	Bypass Valve	Comments
P577024	1-½" SAE 4-bolt flange code 61	No bypass	Filter elements not included with assembly. Please select filter elements from list below
P577025	1-½" SAE 4-bolt flange code 61	50 psi (3.4 bar) bypass	Filter elements not included with assembly. Please select filter elements from list below

### Filter Choices

Media Type	$\beta_{x(c)} = 1000$ Rating based on ISO 16889	Length		Donaldson Part No.	Comments
		in	mm		
DT Synteq Synthetic	5 µm	14.62	371	P567101	
	8 µm	14.62	371	P567102	
	13 µm	14.62	371	P567103	
	23 µm	14.62	371	P567104	
	5 µm	14.69	373	P560716	High collapse
	27 µm	14.69	373	P560718	High collapse

### Service Indicator Choices

Use with Bypass Valve Pressure of:	Indicator Part No.	Seal Material	Connector Style
<b>Visual / Electric Models</b>			
50 psi / 345 kPa	P577029	Viton seal	Hirschman
<b>Visual Models</b>			
50 psi / 345 kPa	P577028	Viton seal	Manual reset

## Performance Data

### DPK350 Housing Only

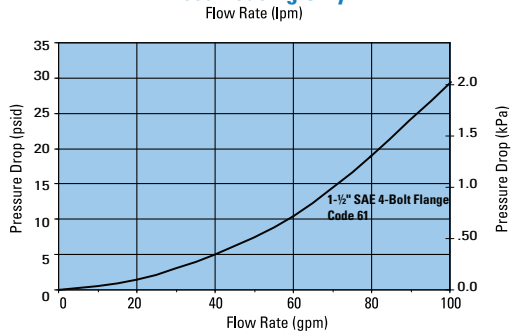

### DPK350 14" Filter Only

(DT Synthetic Synteq Media, 14.62"/371mm)

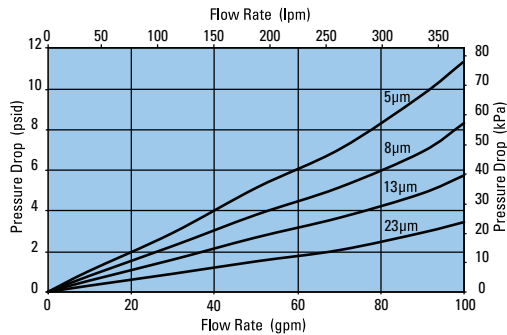

### DPK350 14" High-Collapse Filter Only

(DT Synthetic Synteq Media, 14.68"/373mm)

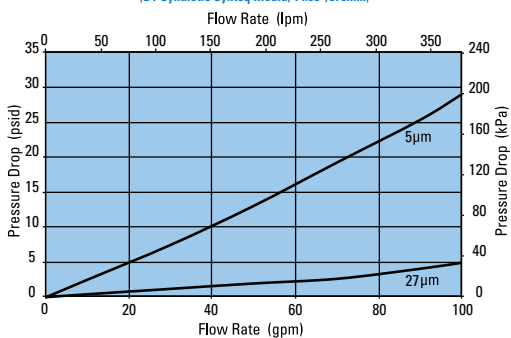



W061

Max Flow: 100 gpm (379 lpm)



## W061 In-Line Cartridge Filters

**Working Pressures to:** 600 psi  
4140 kPa  
41.4 bar

**Rated Static Burst to:** 1500 psi  
10,342 kPa  
103 bar

**Fatigue Pressure Rating:** 300 psi  
2070 kPa  
21 bar

**Flow Range To:** 100 gpm  
379 lpm

### Applications

- In-Plant Systems
- Meets HF3 Specification
- Mobile Equipment



## Features

The W061 filter assembly contains the popular HF3 filter. Quick filter change outs are accomplished with the use of our easily serviceable ring assembly. Donaldson DT high-performance 4-layer media is offered in a variety of designs. Five different media grades are offered. Donaldson filters core collapse options range from 150 to 3,000 psi. The differential pressure indicator line is designed to work with a wide assortment of bypass valves. Thermal lockout and surge control are two key features incorporated in many of the differential pressure indicators.

- Assembly length code 2 conforms to HF3 specifications
- Wide range of indicator options
- Three housing length options for design flexibility
- Head material: cast iron
- Housing material: steel
- Bleed plug in head

### Beta Rating

- Performance to  $\beta_{<4(c)} = 1000$

### Porting Size Options

- SAE-12, SAE-16 O-ring

### Replacement Filter Lengths

- 4.59" / 116.7 mm
- 8.22" / 208.8 mm
- 12.91" / 327.8 mm

### Filter Collapse Ratingsz

- 150 psi / 1034 kPa / 10.3 bar (standard)

### Standard Bypass Ratings

- 25 psi / 173 kPa / 1.73 bar
- 50 psi / 345 kPa / 3.5 bar
- No Bypass

### Assembly Weight

- 4.59": 7.9 lbs / 3.6 kg
- 8.22": 8.9 lbs / 4.0 kg
- 12.91": 10.2 lbs / 4.6 kg

### Operating Temperatures

- -20° to 250°F (-29° to 121°C)



## W061 Specification Illustrations

All dimensions are shown in millimeters [inches].

### Assembly - Side View

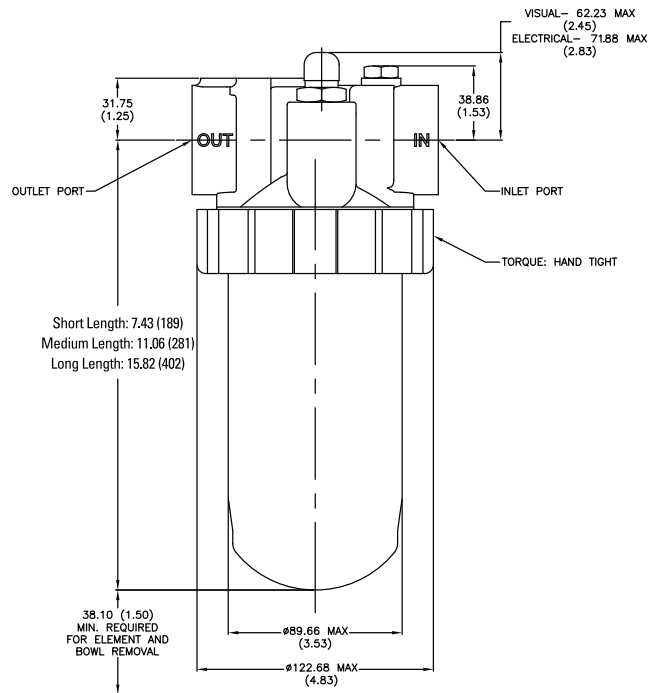

### Head - Top View

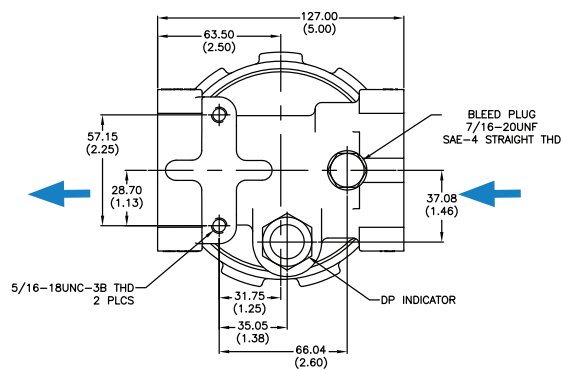



W061

Max Flow: 100 gpm (379 lpm)



## W061 Components

### High-Performance DT Filter Choices

Media Type	$\beta_{x(c)} = 2$ Rating based on ISO 16889	$\beta_{x(c)} = 1000$	Length in mm	Donaldson Part No.	Comments
DT Synteq		<4 $\mu$ m	4.59 117	P566204	DT-9600-4-2UM
Synthetic		5 $\mu$ m	4.59 117	P566205	DT-9600-4-5UM
		8 $\mu$ m	4.59 117	P566206	DT-9600-4-8UM
		12 $\mu$ m	4.59 117	P566207	DT-9600-4-14UM
		23 $\mu$ m	4.59 117	P566208	DT-9600-4-25UM
		5 $\mu$ m	4.59 117	P566364	DT-9601-4-5UM, High collapse
		12 $\mu$ m	4.59 117	P566365	DT-9601-4-14UM, High collapse
		<4 $\mu$ m	8.22 209	P566209	DT-9600-8-2UM
		5 $\mu$ m	8.22 209	P566210	DT-9600-8-5UM
		8 $\mu$ m	8.22 209	P566211	DT-9600-8-8UM
		12 $\mu$ m	8.22 209	P566212	DT-9600-8-14UM
		23 $\mu$ m	8.22 209	P566213	DT-9600-8-25UM
		5 $\mu$ m	8.22 209	P566366	DT-9601-8-5UM, High collapse
		12 $\mu$ m	8.22 209	P566367	DT-9601-8-14UM, High collapse
		<4 $\mu$ m	8.23 209	P567875	DX2-9600-8-2UM
		5 $\mu$ m	8.23 209	P565122	DX2-9600-8-5UM
		8 $\mu$ m	8.23 209	P565123	DX2-9600-8-8UM
		12 $\mu$ m	8.23 209	P564936	DX2-9600-8-14UM
		<4 $\mu$ m	12.91 328	P566214	DT-9600-13-2UM
		5 $\mu$ m	12.91 328	P566215	DT-9600-13-5UM
		8 $\mu$ m	12.91 328	P566216	DT-9600-13-8UM
		12 $\mu$ m	12.91 328	P566217	DT-9600-13-14UM
		23 $\mu$ m	12.91 328	P566218	DT-9600-13-25UM
		5 $\mu$ m	12.87 327	P566368	DT-9601-13-5UM, High collapse
		12 $\mu$ m	12.87 327	P566369	DT-9601-13-14UM, High collapse
		<4 $\mu$ m	12.87 327	P567876	DX2-9600-13-2UM
		5 $\mu$ m	12.87 327	P565188	DX2-9600-13-5UM
		8 $\mu$ m	12.87 327	P565189	DX2-9600-13-8UM
		12 $\mu$ m	12.87 327	P565187	DX2-9600-13-14UM
Water	10 $\mu$ m		8.23 209	P569528	Absorbs 130 ml water @ 25 psid
Absorbing	10 $\mu$ m		12.87 327	P569529	Absorbs 220 ml water @ 25 psid



#### Filter Notes:

- All Donaldson DT and DX2 filters utilize glass fiber media with an epoxy-based resin system for the ultimate in chemical compatibility.
- All Donaldson DT and DX2 filters are potted with epoxy-based adhesives.
- Standard collapse DT designs are double wire-backed using epoxy-coated steel mesh for maximum pleat support and dirt capacity.
- DT high collapse designs are potted into machined aluminum end caps for greater filter integrity in critical applications.
- Viton® seals are standard on all Donaldson DT and DX2 filters.

### Performance Data

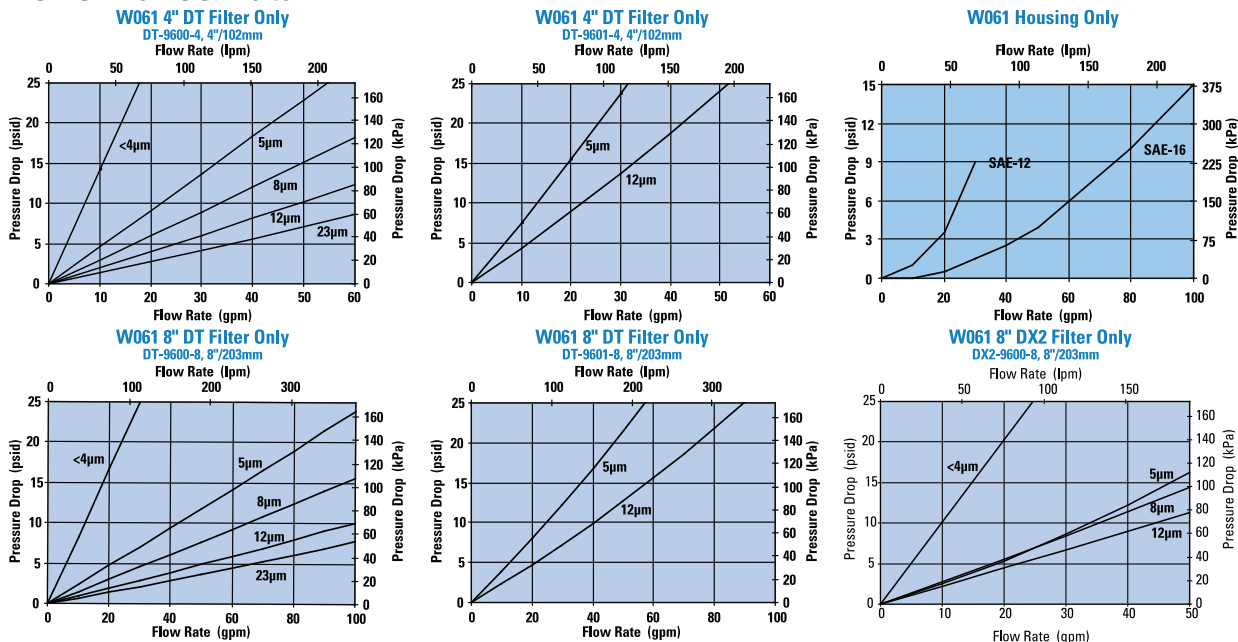

## Head Assembly Choices

Port Size	Bypass Rating	Seal Material	Indicator Style & Location	Donaldson Part No.
SAE-12 O-Ring	50 psi / 3.45 bar	Buna-N	Port Machined & Plugged	P574242
SAE-16 O-Ring	50 psi / 3.45 bar	Buna-N	Port Machined & Plugged	P574243
SAE-16 O-Ring	25 psi / 1.72 bar	Viton	Port Machined & Plugged	P575929

## Housing Choices

Housing Length	Seal Material	Donaldson Part No.
4" (101.6mm)	Buna-N	X011115
8" (203.2mm)	Buna-N	X011111
13" (330.2mm)	Buna-N	X011117

## Indicator Choices

Indicator Pressure Setting	Connector Style	Seal Material	Donaldson Part No.	Thermal Lockout	Surge Control	Reset
<b>Visual Pop-up Models</b>						
15 psi / 103 kPa	NA	Buna-N	P572345	No	No	Auto
35 psi / 241 kPa	NA	Buna-N	P572347	No	No	Auto
35 psi / 241 kPa	NA	Buna-N	P572348	Yes	Yes	Manual
35 psi / 241 kPa	NA	Viton	P567456	Yes	Yes	Manual
<b>Electrical / Visual Models</b>						
15 psi / 103 kPa	Hirschman	Buna-N	P572323	No	No	Auto
35 psi / 241 kPa	Hirschman	Buna-N	P572327	No	No	Auto
35 psi / 241 kPa	Brad Harrison	Buna-N	P572329	No	No	Auto
35 psi / 241 kPa	Hirschman	Buna-N	P572384	Yes	Yes	Manual
35 psi / 241 kPa	Hirschman	Viton	P567458	Yes	Yes	Manual
15 psi / 103 kPa	3 wire flying leads	Buna-N	P572342	No	No	Auto
35 psi / 241 kPa	3 wire flying leads	Buna-N	P572349	No	No	Auto
<b>Electrical Models</b>						
15 psi / 103 kPa	Hirschman	Buna-N	P572355	No	No	Auto
35 psi / 241 kPa	Hirschman	Buna-N	P572359	No	No	Auto
35 psi / 241 kPa	Brad Harrison	Buna-N	P572361	No	No	Auto

## Head/Bowl/Housing Seal Kits

Donaldson Part No.	Material
X011160	Buna
X011161	Viton

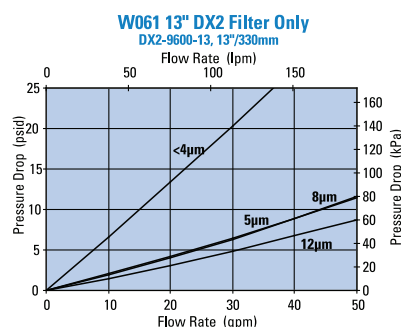
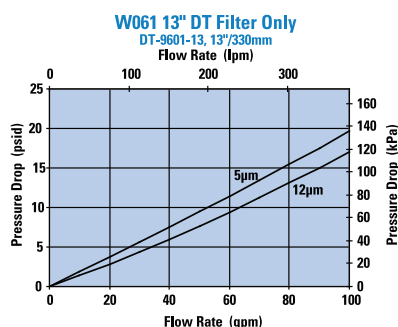
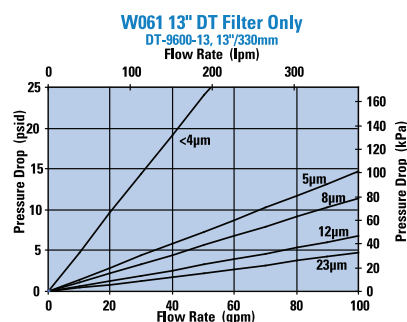



**HDK06**

Max Flow: 150 gpm (568 lpm)



## HDK06 In-Line/Tank Mount Filters

**Working Pressures to:** 350 psi  
2415 kPa  
24.1 bar

**Rated Static Burst to:** 500 psi  
3450 kPa  
34.5 bar

**Flow Range To:** 150 gpm  
568 lpm

### Features

HDK06 filters come in two styles: In-line and tank mount. Both styles feature a die cast aluminum head and steel body for strength and durability; service is made easier with a single, center retention bolt on top of the head. Filter flow is inside to outside. Buna-N® seals are standard.

HDK06 assemblies come complete with our  $\beta_{9(c)}=1000$  rated Synteq™ filter cartridge. Other ratings are available, depending on your cleanliness requirements. HDK06 comes with an easy-to-read visual service indicator.



*In-line model shown*

### Beta Rating

- Performance to  $\beta_{<4(c)}=1000$

### Porting Size Options

- 2½" NPT

### Replacement Filter Lengths

- 16.00" / 406mm

### Standard Bypass Ratings

- 25 psi / 172.5 kPa / 1.7 bar

### Assembly Weight

- 39.25 lbs / 18 kg

### Operating Temperatures

- -20°F to 250°F
- -29°C to 121°C

### Filter Burst Ratings

- 100 psid / 690 kPa / 6.9 bar

## HDK06 Specification Illustrations

All dimensions are shown in inches [millimeters].

### Assembly - Side Views

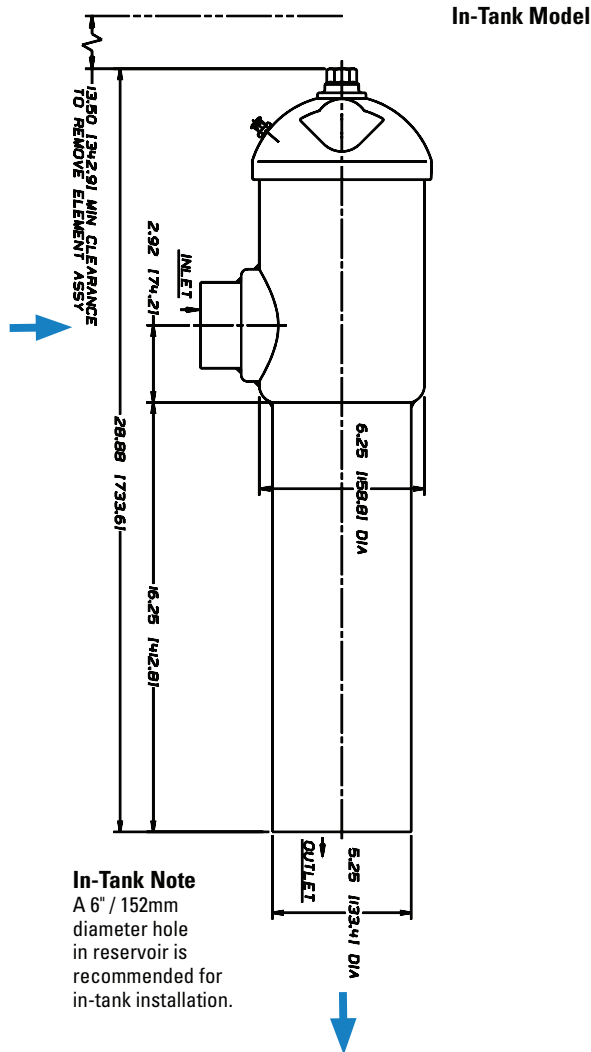

### Applications

- Cooling Circuits
- Fluid Conditioning Systems
- Lube Oil Systems
- Return Lines
- Suction Lines

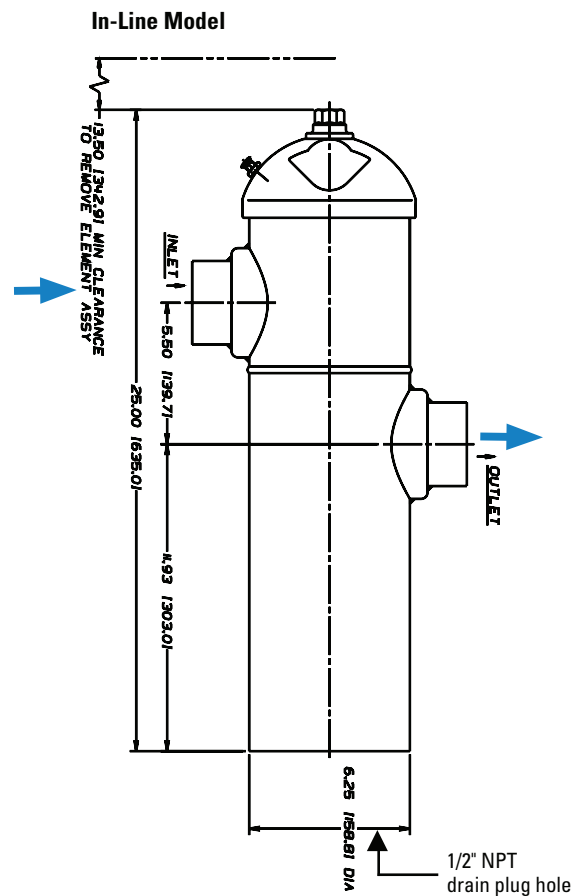

### Head - Top Views

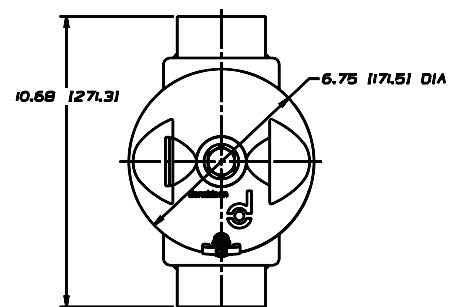
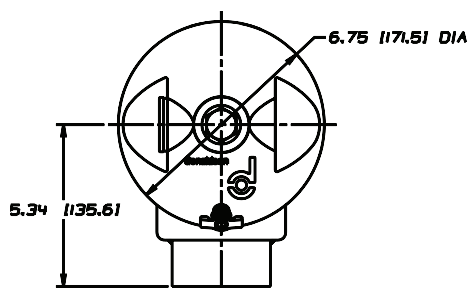



# HDK06

Max Flow: 150 gpm (568 lpm)



## HDK06 Components

### Assembly Choices

Style	Part No.	Port Size	Bypass Rating	Indicator	Includes Filter Cartridge
In-Tank	K060173	2½" NPT	25 psi / 172.5 kPa	Visual	P176221
In-Line	K060160	2½" NPT	25 psi / 172.5 kPa	Visual	P176221

### Filter Choices

Media Type	$\beta_{x(c)} = 2$ Rating based on ISO 16889	$\beta_{x(c)} = 1000$	Length		Donaldson Part No.
Synteq		<4 µm	16.00	406	P161016
Synthetic		6 µm	16.00	406	P165628
		11 µm	16.00	406	P176221
		22 µm	16.00	406	P161571
		23 µm	16.00	406	P164699
		50 µm	16.00	406	P166597
Wire Mesh	150 µm		11.6	294	P160700

#### Filter Notes

Standard HDK06 replacement filters have Buna-N® seals, which are appropriate for most applications involving petroleum oil. Filters with seals made of fluorocarbon elastomer (such as Viton® and Fluorel®) are required when using diester, phosphate ester fluids, water glycol, water/oil emulsions, and HWCF (high water content fluids) over 150°F.

HDK06 filters are inside to outside reverse flow 4.39" (112mm) OD.

Refer to the table in the Technical Reference Guide for fluid compatibility with our filter media.

Viton® is a registered trademark of E. I. DuPont de Nemours and Company.

Fluorel® is a registered trademark of 3M Company.

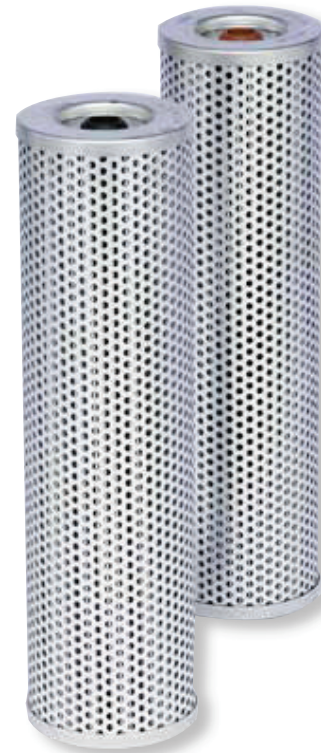

## Performance Data

HDK06 Filters Only

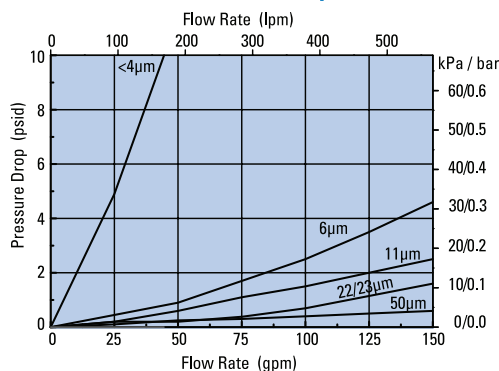

HDK06 Head Only

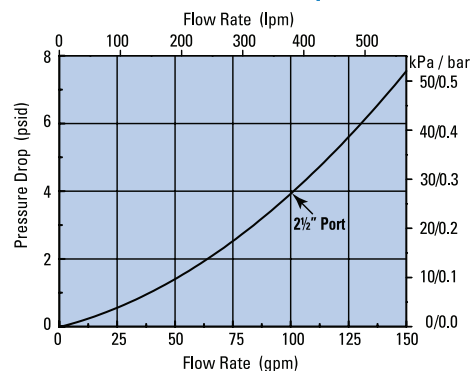

## HDK06 Service Parts

### SERVICE PARTS NOTE:

Some service parts may not be stocked. Please contact your Donaldson sales representative for lead time details.

### Optional Tee Handle for Easier Servicing

The first step in changing the HDK06 cartridge is loosening the top nut with a wrench. Our optional tee handle makes this job easier. The P160135 kit, comprised of the handle, an o-ring, and a clip ring, replaces the entire top nut assembly.

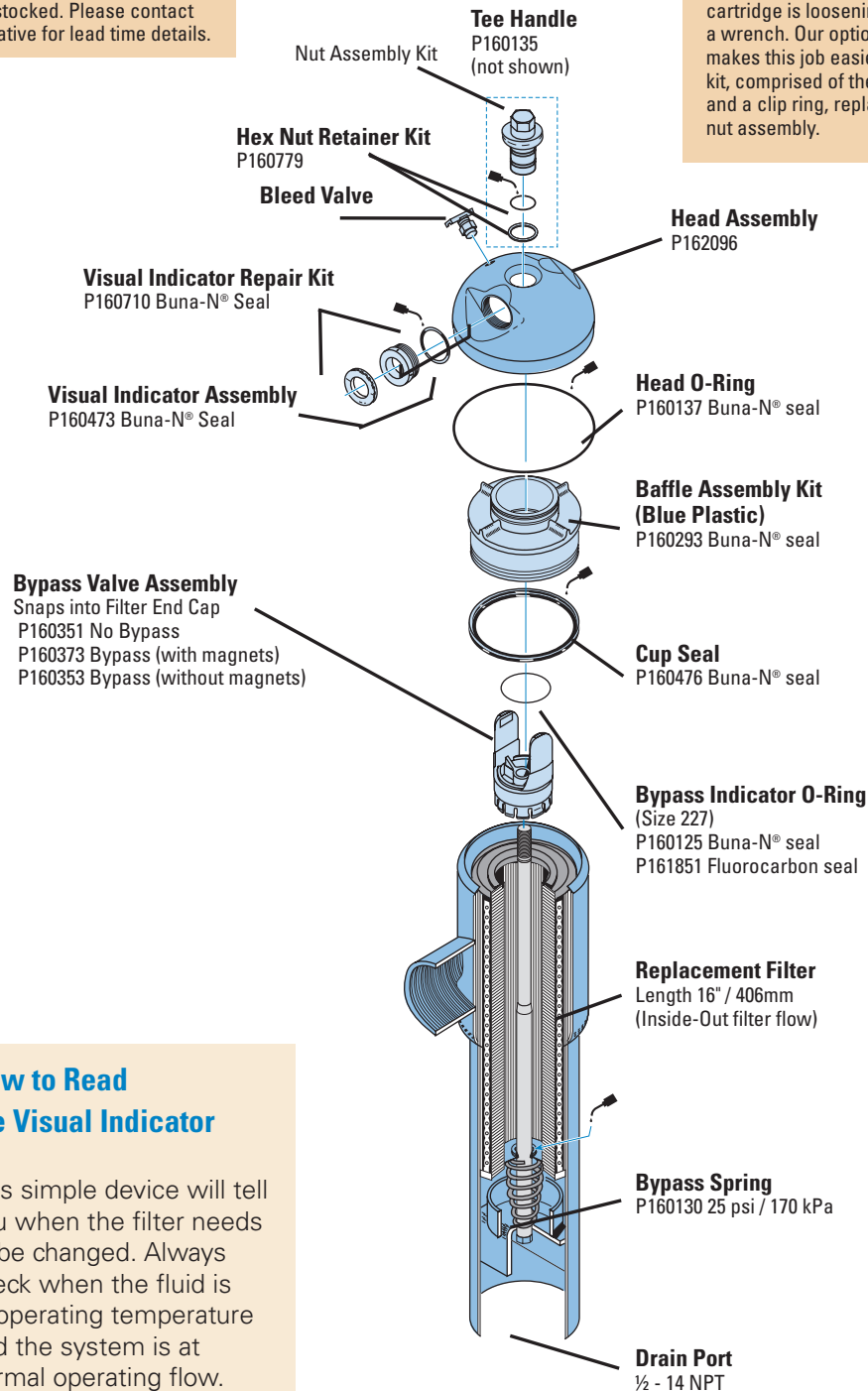

### How to Read the Visual Indicator

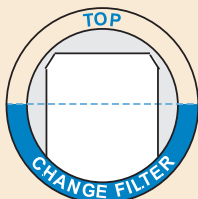

**Filter OK**

This simple device will tell you when the filter needs to be changed. Always check when the fluid is at operating temperature and the system is at normal operating flow.

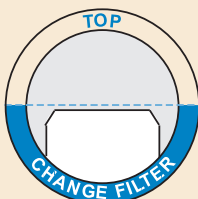

**Filter Needs Service**

If the top of the white panel is below the lower half of the window, the filter needs servicing.

Buna-N® is a registered trademark of E. I. DuPont de Nemours and Company.





W041

Max Flow: 300 gpm (1135 lpm)



## W041 In-Line Cartridge Filters

**Working Pressures to:** 500 psi  
3450 kPa  
34.5 bar

**Rated Static Burst to:** 1500 psi  
10,342 kPa  
103.5 bar

**Flow Range To:** 300 gpm  
1135 lpm



### Applications

- Fluid Conditioning Systems
- In-Plant Systems
- Lube Oil Systems

## Features

The W041 high flow filter combines the best features of a base-mounted assembly; several inlet port options, top cover filter servicing for ease of maintenance and a wide selection of service indicators. The W041 all-aluminum head design and plated steel cylinder provides a strong, durable, and dependable unit. We offer standard features like deep pleat filters for higher dirt holding capacity and our standard Donaldson DT 4-layer media filter construction. This technology, combined with many other standard features, is ideal for today's applications in pulp and paper, power generation and steel mill applications. Five standard grades of media are offered. Thermal lockout and surge control are two key features incorporated in many of the differential pressure indicators.

- Large T-handle for fast servicing without tools
- Wide range of indicator options
- Two filter length options for design flexibility
- Base material: aluminum
- Cylinder material: steel
- Cover material: cast iron
- Two drain plugs in base
- Bleed/fill plug in cover

### Beta Rating (per ISO 16889)

- Performance to  $\beta_{<4(c)} = 1000$

### Porting Size Options

- 2" or 2½" SAE 4-Bolt Flange Code 61

### Replacement Filter Lengths

- 16.74" / 425.3 mm
- 38.62" / 980.9 mm

### Filter Collapse Ratings

- 150 psid / 1034 kPa / 10.3 bar (standard)

### Housing Weight

- 16.74": 48.5 lbs / 22.0 kg
- 38.62": 86.2 lbs / 39.2 kg

### Operating Temperatures

- -20°F to 250°F / -29° to 121°C

### Standard Bypass Ratings

- 50 psi / 345 kPa / 3.5 bar

## W041 Specification Illustrations

All dimensions are shown in millimeters [inches].

### Assembly - Side View

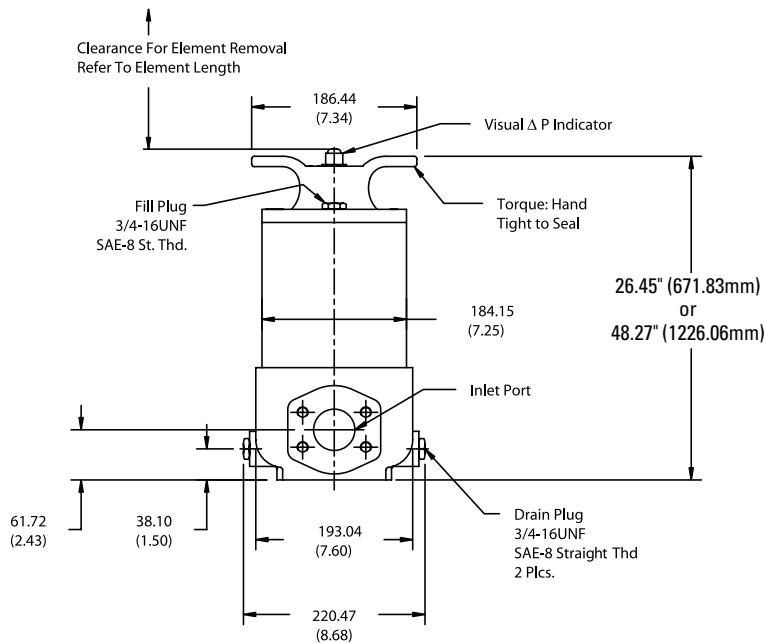

### Head - Bottom View

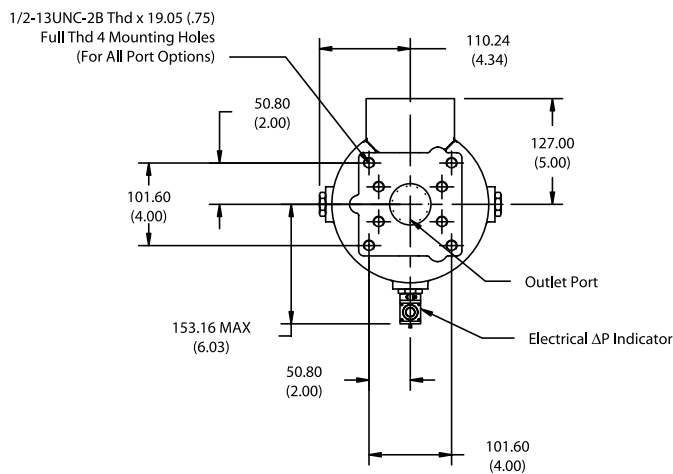



W041

Max Flow: 300 gpm (1135 lpm)



## W041 Components

### High-Performance DT Filter Choices

Media Type	$\beta_{x/c} = 1000$ Rating based on ISO 16889	Length		Donaldson Part No.	Comments
DT Synteq Synthetic	<4 $\mu$ m	16.74	425	P566239	DT-8300-16-2UM
	5 $\mu$ m	16.74	425	P566240	DT-8300-16-5UM
	8 $\mu$ m	16.74	425	P566241	DT-8300-16-8UM
	12 $\mu$ m	16.74	425	P566242	DT-8300-16-14UM
	23 $\mu$ m	16.74	425	P566243	DT-8300-16-25UM
	<4 $\mu$ m	38.62	981	P566244	DT-8300-39-2UM
	5 $\mu$ m	38.62	981	P566245	DT-8300-39-5UM
	8 $\mu$ m	38.62	981	P566246	DT-8300-39-8UM
	12 $\mu$ m	38.62	981	P566247	DT-8300-39-14UM
	23 $\mu$ m	38.62	981	P566248	DT-8300-39-25UM
	<4 $\mu$ m	16.10	409	P566249	DT-8310-16-2UM
	5 $\mu$ m	16.10	409	P566250	DT-8310-16-5UM
	8 $\mu$ m	16.10	409	P566251	DT-8310-16-8UM
	12 $\mu$ m	16.10	409	P566252	DT-8310-16-14UM
	23 $\mu$ m	16.10	409	P566253	DT-8310-16-25UM
	<4 $\mu$ m	37.94	964	P566254	DT-8310-39-2UM
	5 $\mu$ m	37.94	964	P566255	DT-8310-39-5UM
	8 $\mu$ m	37.94	964	P566256	DT-8310-39-8UM
	12 $\mu$ m	37.94	964	P566257	DT-8310-39-14UM
	23 $\mu$ m	37.94	964	P566258	DT-8310-39-25UM
Water Absorbing	10 $\mu$ m	37.94	964	P578277	

#### Filter Notes

All Donaldson DT filters utilize glass fiber media with an epoxy-based resin system for the ultimate in chemical compatibility. All Donaldson DT filters are potted and seam-sealed with epoxy-based adhesives. Standard collapse designs are double wire-backed using epoxy-coated steel mesh for maximum pleat support and dirt capacity. Extended life designs are double wire-backed using epoxy-coated steel mesh. Viton® seals are standard on all Donaldson DT filters. Viton® is a registered trademark of E. I. DuPont de Nemours and Company.

## Performance Data

#### W041 16" DT Filter Only

DT-8300-16, 16"/406mm

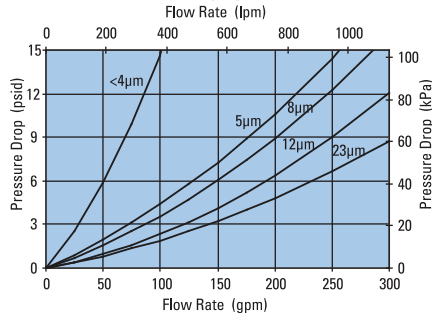

#### W041 39" DT Filter Only

DT-8300-39, 39"/991mm

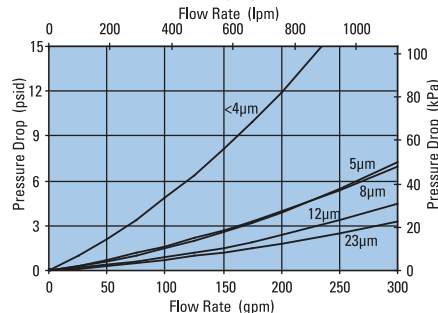

#### W041 Housing Only

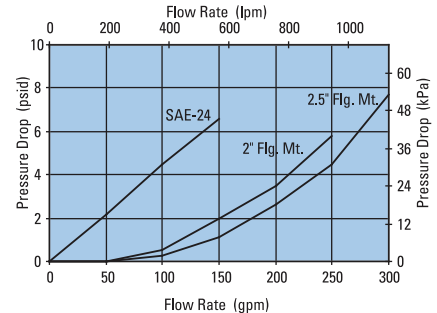

#### W041 16" DT Filter Only

DT-8310-16, 16"/406mm

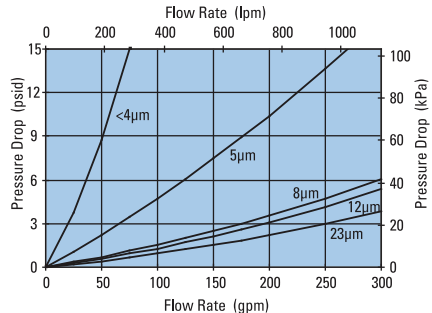

#### W041 39" DT Filter Only

DT-8310-39, 39"/991mm

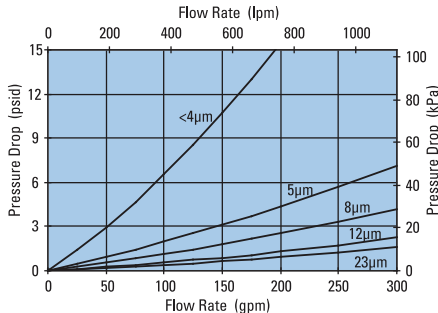

## Filter Assembly Choices

Size	Rating	Material	Indicator Port	Housing Length	Assembly Length	Part No.
2" SAE 4 Bolt Flange Code 61	50 psi / 3.45 bar	Viton	Port Machined & Plugged	16" (406.4mm)	26.45" (671.8mm)	P574218
2-1/2" SAE 4 Bolt Flange Code 61	50 psi / 3.45 bar	Viton	Port Machined & Plugged	39" (990.6mm)	48.27" (1226.1mm)	P574219
2" SAE 4 Bolt Flange Code 61	50 psi / 3.45 bar	Viton	Port Machined & Plugged	39" (990.6mm)	48.27" (1226.1mm)	P575920
2-1/2" SAE 4 Bolt Flange Code 61	50 psi / 3.45 bar	Viton	Port Machined & Plugged	16" (406.4mm)	26.45" (671.8mm)	P575921

## Indicator Choices

Indicator	Connector	Seal	Donaldson	Thermal	Surge	Reset
Pressure Setting	Style	Material	Part No.	Lockout	Control	
<b>Visual Pop-up Models</b>						
35 psi / 241 kPa	NA	Buna-N	P572347	No	No	Auto
35 psi / 241 kPa	NA	Buna-N	P572348	Yes	Yes	Manual
35 psi / 241 kPa	NA	Viton	P567456	Yes	Yes	Manual
<b>Electrical / Visual Models</b>						
35 psi / 241 kPa	Hirschman	Buna-N	P572327	No	No	Auto
35 psi / 241 kPa	Brad Harrison	Buna-N	P572329	No	No	Auto
35 psi / 241 kPa	Hirschman	Buna-N	P572384	Yes	Yes	Manual
35 psi / 241 kPa	Hirschman	Viton	P567458	Yes	Yes	Manual
35 psi / 241 kPa	Brad Harrison	Buna-N	P572385	Yes	Yes	Manual
35 psi / 241 kPa	3 wire flying leads	Buna-N	P572349	No	No	Auto
<b>Electrical Models</b>						
35 psi / 241 kPa	Hirschman	Buna-N	P572359	No	No	Auto
35 psi / 241 kPa	Brad Harrison	Buna-N	P572361	No	No	Auto

## Head/Bowl/Housing Seal Kits

Donaldson Part No.	Material
X011156	Buna
X011157	Viton



## HFK08

Max Flow: 300 gpm (1135 lpm)



### HFK08 In-Line/Tank Mount Filters

**Working Pressures to:** 350 psi  
2415 kPa  
24.1 bar

**Rated Static Burst to:** 500 psi  
3450 kPa  
34.5 bar

**Flow Range To:** 300 gpm  
1135 lpm

### Features

HFK08 is available in two styles: in-line and in-tank. Both styles feature a cast aluminum head and steel body for maximum strength and durability. Its single, center retention bolt simplifies servicing. Flow is from inside to outside of the filter cartridge.

Three in-stock HFK08 models offer our proprietary Synteq™ synthetic media designed especially for liquid filtration. A wider range of filter media is available to purchase separately, as are fluoroelastomer seals. A visual service indicator is built into the HFK08 head.



*In-line model shown*

#### Beta Rating

- Performance to  $\beta_{<4(c)} = 1000$

#### Porting Size Options

- 3" NPT
- SAE-20 O-ring

#### Replacement Filter Lengths

- 18.00" / 457mm

#### Standard Bypass Ratings

- 25 psi / 172.5 kPa / 1.7 bar

#### Assembly Weight

- 55.4 lbs / 25.12 kg

#### Operating Temperatures

- -20°F to 250°F
- -29°C to 121°C

#### Filter Burst Ratings

- 75 psi / 517 kPa / 5.2 bar (synthetic)
- 100 psi / 689 kPa / 6.9 bar (wire mesh)

## HFK08 Specification Illustrations

All dimensions are shown in inches [millimeters].

### Assembly - Side Views

**In-Line Model**

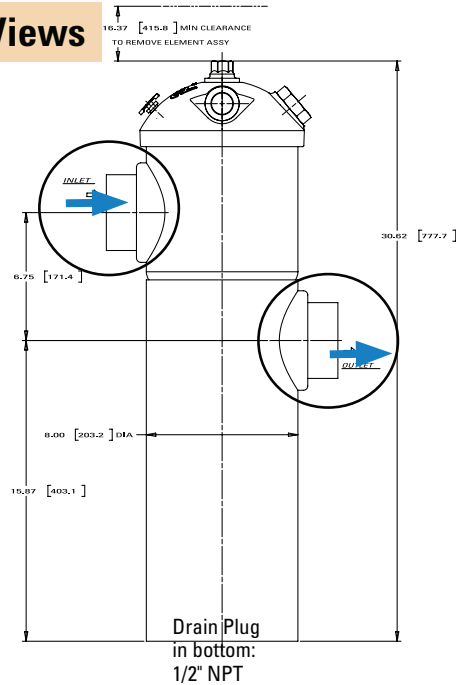

**K080087 In-Line Model**

Smaller port size (SAE-20) works well for kidney loop filtration.

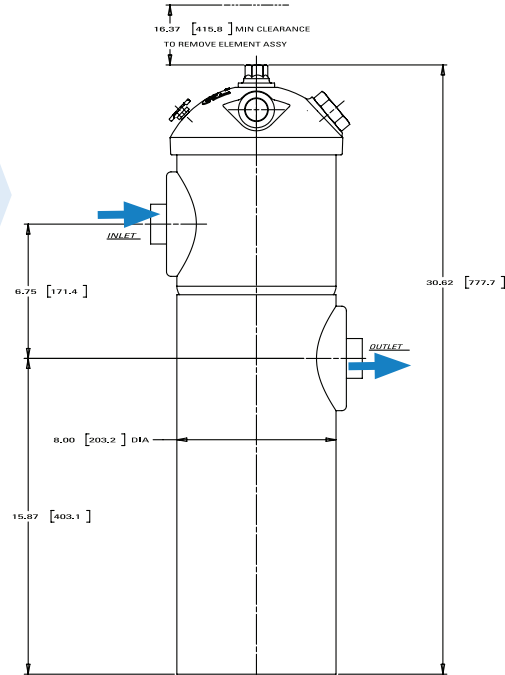

### Head - Top Views

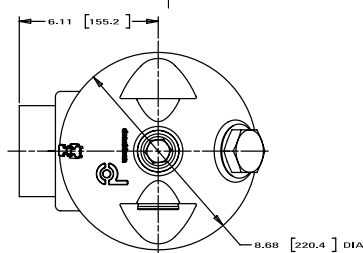
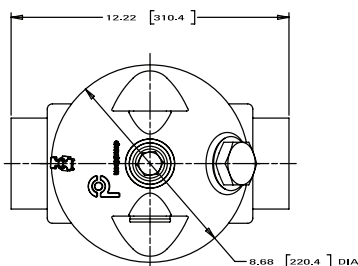

### Applications

- Fluid Conditioning Systems
- Lube Oil Systems
- Return Lines
- Side Loop Systems
- Suction Lines

**In-Tank Model**

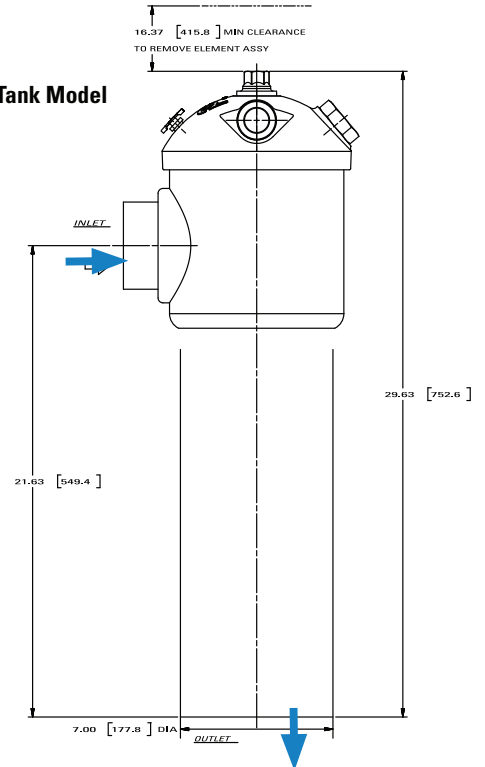



HFK08  
Max Flow: 300 gpm (1135 lpm)



HFK08 Components

Filter Assemblies

Port Size	Bypass Rating	Indicator Style1 & Location	Assembly Part No.	Length (in./mm)	Filter Part No.
3" NPT	25 psi / 172.5 kPa	Visual, Left side	K080051, In-Tank	18"/457mm	P164703
		Visual, Right side	K080033, In-Line	18"/457mm	P164703
			K080085, In-Line	18"/457mm	P164407 Viton® Seal
SAE-20	25 psi / 172.5 kPa	Visual, Right side	K080087, In-Line	18"/457mm	P164405

Assembly Notes

<sup>1</sup>Donaldson uses the inlet port as the reference point. "Left side," for instance, means that the indicator mounts on the side of the filter head that is on your left when you face the inlet port. Viton® is a registered trademarks of E. I. DuPont de Nemours and Company.

Filter Choices

Media Type	$\beta_{x(c)} = 2$ Rating based on ISO 16889	$\beta_{x(c)} = 1000$	Length		Donaldson Part No.
Synteq Synthetic		<4 µm	18.00	457	P164407 Viton® seal
		<4 µm	18.00	457	P164405
		6 µm	18.00	457	P166462
		11 µm	18.00	457	P176222
		23 µm	18.00	457	P164703
Wire Mesh	45 µm		18.00	457	P173573
	150 µm		18.00	457	P163945

**Filter Notes**  
Standard HFK08 replacement filters have Buna-N® seals, which are appropriate for most applications involving petroleum oil. Filters with seals made of fluorocarbon elastomer (such as Viton® and Fluorel®) are required when using diester, phosphate ester fluids, water glycol, water/oil emulsions, and HWCF (high water content fluids) over 150°F. HFK08 filters are inside to outside reverse flow 4.39" (112mm) OD.  
Refer to the table in the Technical Reference Guide for fluid compatibility with our filter media.  
Viton® is a registered trademarks of E. I. DuPont de Nemours and Company.  
Fluorel® is a registered trademark of 3M Company.



The K080087 model has features that are perfect for kidney loop filtration.

Performance Data

HFK08 Filter Only

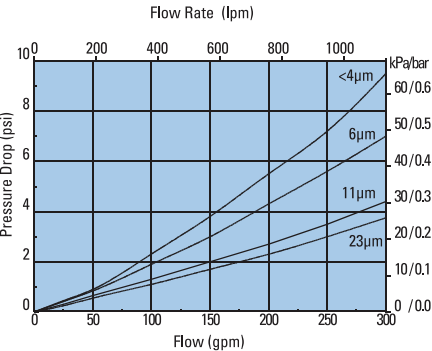

HFK08 Housing Only

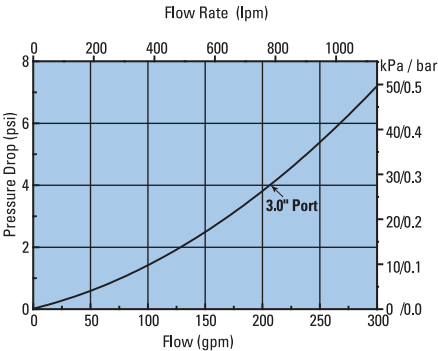

K080087 Assembly (with Filter)

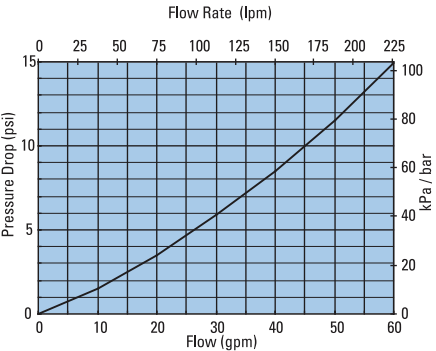



## HFK08 Service Parts

### SERVICE PARTS NOTE:

Some service parts may not be stocked. Please contact your Donaldson sales representative for lead time details.

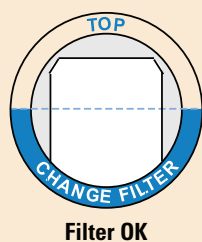
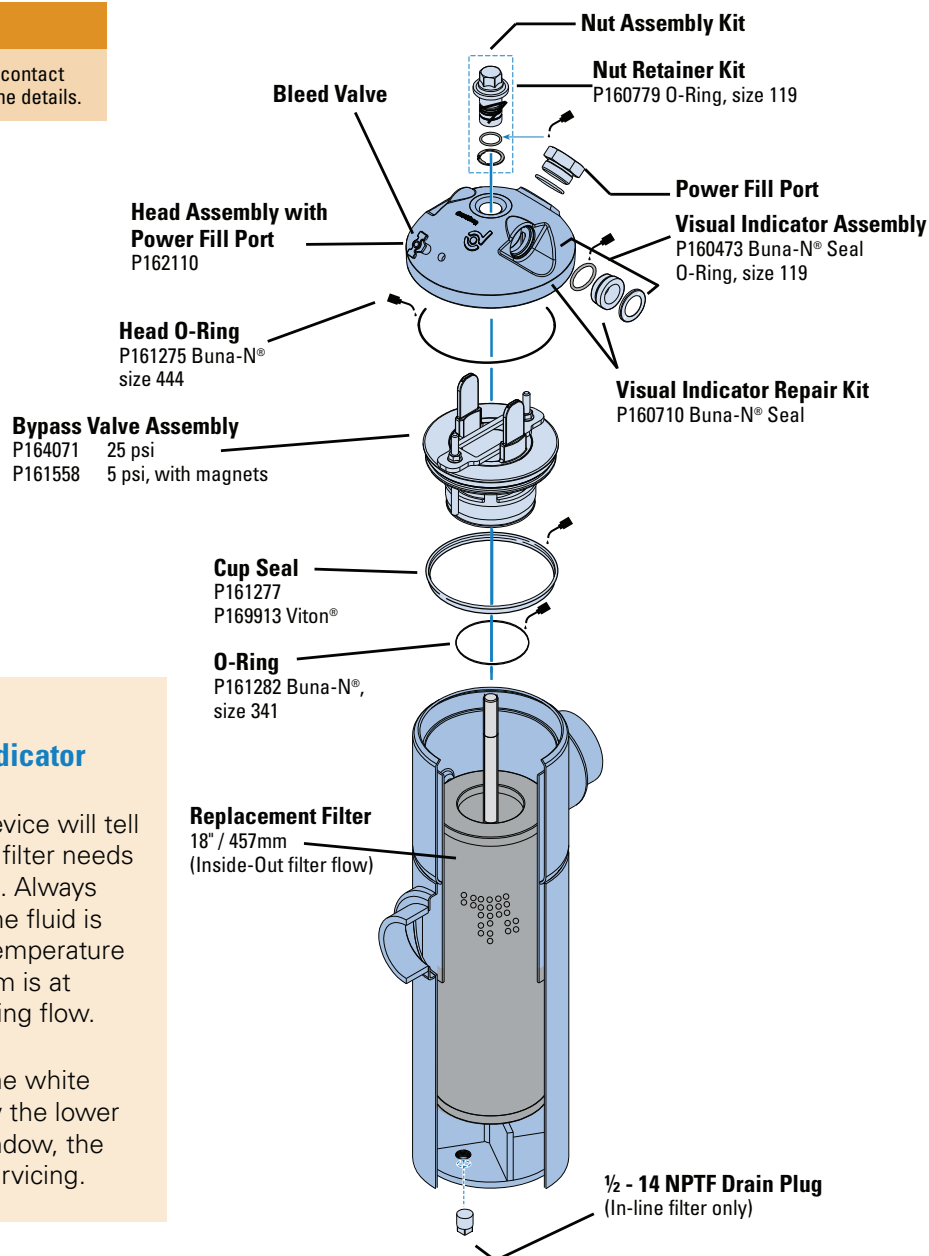

### How to Read the Visual Indicator

This simple device will tell you when the filter needs to be changed. Always check when the fluid is at operating temperature and the system is at normal operating flow.

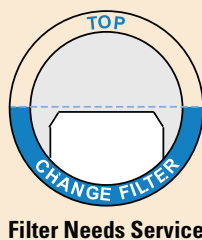

If the top of the white panel is below the lower half of the window, the filter needs servicing.



HFK08 replacement filters are available with synthetic or wire mesh media.

Buna-N® and Viton® are a registered trademarks of E. I. DuPont de Nemours and Company.