



## Connected Smart-UPS with APC SmartConnect

The First Cloud-enabled UPS For Distributed IT

APC™ award-winning Smart-UPS™ is the most popular UPS in the world for servers, storage and network power protection. Smart-UPS provides availability and manageability to your network allowing you to focus on business growth instead of business downtime. Trusted to protect critical data and equipment from power problems by supplying clean and reliable network-grade power.

Connected Smart-UPS units boast an ingenious networking feature that makes Smart-UPS even more adaptable and easier to deploy: APC SmartConnect is a feature which allows you to view the status of your UPS through a secure web portal. Through this innovative remote monitoring interface, you'll receive automatic notifications, firmware updates, and advanced support. APC SmartConnect's easy-to-use network connectivity provides added value — and more important — added peace of mind.

Life Is On

**APC**<sup>®</sup>  
by Schneider Electric

# The World's Most Popular UPS Just Got Smarter

Connected Smart-UPS is here:



## APC SmartConnect Enabled:

- Accessible from any internet connected device, on site or mobile
- Simple account login and registration
- Proactive actionable alerts and lifecycle recommendations
- Compatible with major RMM platforms
- No special software, SNMP trap or coding required
- Connected Smart-UPS adhere to the latest industry standards in secure data collection

## Connected Smart-UPS Features:

### APC SmartConnect

APC SmartConnect is a proactive remote UPS cloud monitoring feature that is accessible from any internet connected device

### Pure Sinewave

A pure form of sinewave designed to emulate utility power, will support your device upon battery backup

### Intelligent Battery Management

Temperature compensated charging extends life and advanced algorithms recommend replacement date

### High-efficiency Greenmode

Optimum efficiency which saves on utility and cooling costs

### Network-grade Power

Provides stable power conditions by filtering noise, automatic voltage regulation (AVR), and surge protection

### Emergency Power Off (EPO)

Provides for remote UPS shut-off in the event of a fire or other emergency (2,200 VA and above)

## Getting Started is Easy



### Install your UPS

Install your SmartConnect-compatible UPS at your business site. Connect it to your network using a dedicated ethernet port.

### Scan the QR code

Scan the QR Code printed on your Smart-UPS, and automatically register your device with the SmartConnect Web Portal.

### Register your UPS

Create a Schneider Electric account to register your Smart-UPS. Your UPS will be automatically linked to your account.

Life Is On

**APC**  
by Schneider Electric

# Connected Smart-UPS SMC Features

Application optimized models ideal for entry level servers, point-of-sale (POS) and other small network devices



## APC SmartConnect

Proactive remote UPS cloud monitoring feature that is accessible from any internet connected device

## Pure Sinewave Output

Simulates the utility when on battery for optimum device compatibility

## Advanced Battery Management

Temperature compensated charging extending the life of internal batteries

## High Efficiency Green Mode

Save on utility costs while reducing heat to promote longer component life

## Network Grade Power Conditioning

Automated voltage regulation (AVR), noise filtering and surge protection

## LCD Display

Intuitive interface provides comprehensive status information at a glance

## Communication Ports

USB and serial ports for UPS management

## Safety-agency Approved

Ensures the product has been tested and approved to national standards

## Generous Number of Outlets

All receptacles are surge and UPS protected

## Battery Disconnect

Convenient way to disconnect battery for transport (Tower models)

## Connected Smart-UPS SMC

The most affordable Pure Sinewave UPS's in the Smart-UPS family. Designed for entry level servers, it is compatible with today's active power factor corrected (PFC) power supplies.

Life Is 

**APC**  
by Schneider Electric



# CONNECTED

## Connected Smart-UPS SMC Display

Comprehensive LCD interface for status at a glance

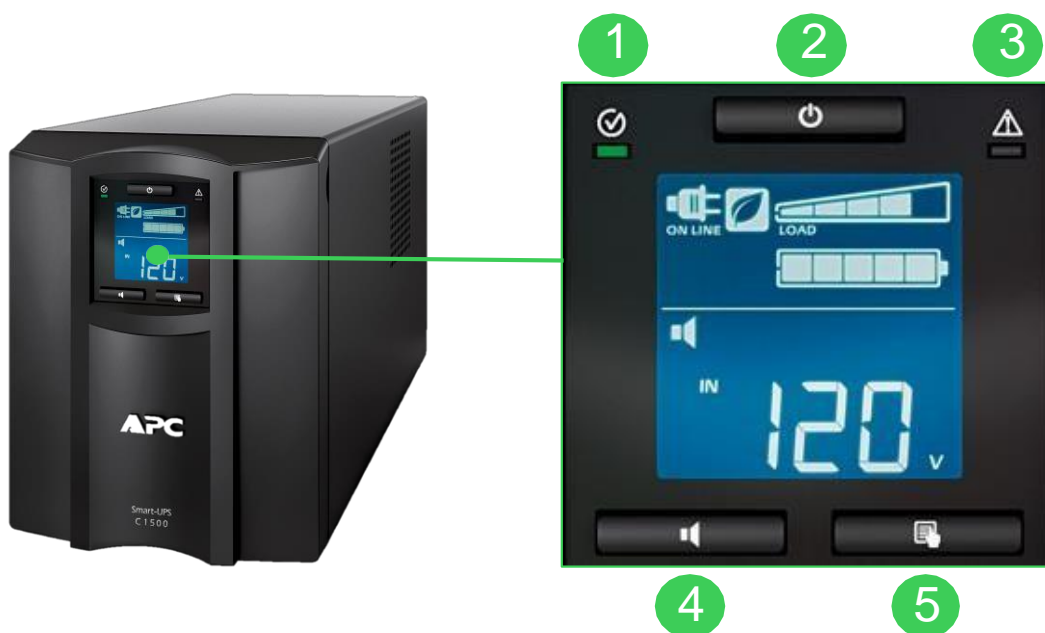

### LCD display

Comprehensive status at a glance

#### Status conditions:

- On line
- On battery
- Green mode
- Load graph
- Battery charge graph
- Audible alarm

#### Measure:

- Input & output voltage
- Load viewable in watts, VA and percentage
- Output current and frequency
- Event counter
- Estimated on battery runtime

- 1 On line / On battery
- 2 On / Off button
- 3 System fault LED
- 4 Mute button
- 5 Display button

Life Is On

**APC**  
by Schneider Electric

# Connected Smart-UPS SMT Features

Intelligent and efficient network power protection from entry level to scalable runtime. Ideal for servers, point-of-sale, routers, switches, hubs, and other network devices.

In addition to Smart-UPS SMC features:



## SmartSlot™ Interface

Accepts a wide array of accessory cards for advanced management and environmental monitoring

## Extended-range Automatic Voltage Regulation

Provides enhanced brownout protection, boosting incoming voltage up to 30% without using battery power

## Switched Outlet Group

Controlled separately from the UPS for discrete reboot of hung devices, sequenced ON/OFF, and non-critical load shedding

## Rack-mount Rails

All hardware provided to securely install in your IT rack

## Configurable, Multi-lingual LCD Display

Provides UPS status and key measures at a glance. Clear and accurate, menu-driven display for easy set-up and customization with or without software installation

## Emergency Power Off (EPO)

Provides for remote UPS shut-off in the event of a fire or other emergency (2,200 VA and above)



## Connected Smart-UPS

Advanced line-interactive power protection for servers and network equipment

Life Is 

**APC**  
by Schneider Electric

# Connected Smart-UPS SMT Display

## Intuitive, easy-to-use LCD interface



### LCD Display Screen

Clear, consistent, and detailed information in your choice of basic or advanced menus

### Power Status

Operating mode, efficiency, load, input / output frequency, battery capacity, runtime and more

### Configuration

Easily configure: language, power quality, alarms, delay and threshold settings

### Test and Diagnostics

Initiate battery and runtime calibration tests

### Control

UPS and outlet group settings

### Logs

See explanation of last 10 transfers and faults

### Quick Status Indicators

Online, on battery, fault, and replace battery LEDs for quick status identification

### Escape, Return and Navigation Buttons

Intuitive navigation to confirm, exit or adjust settings

### Load Energy Meter

Track energy usage in kilo watt hours

Life Is 

**APC**  
by Schneider Electric



# Connected Smart-UPS Management Solutions

## APC SmartConnect

Automatically included in Connected Smart-UPS units, APC SmartConnect is an ingenious connectivity feature that makes Smart-UPS even more adaptable and easier to deploy: APC SmartConnect allows you to view the status of your UPS through a secure web portal. Through this innovative remote monitoring interface, you will receive automatic notifications, firmware updates, and advanced support.



### APC SmartConnect Features:

- No special software or gateway required
- Accessible from any internet connected device
- Compatible with major RMM platforms
- Actionable alerts and lifecycle recommendations
- Enhanced troubleshooting and support
- Simple account login and registration

---

## PowerChute Business Edition For graceful UPS shutdown

### Built-in manageability for your UPS unit

PowerChute Business Edition software provides UPS management, safe system shutdown, and innovative energy reporting capabilities. Energy usage, cost, and CO2 reporting provides a greater understanding of the energy consumed by IT equipment, enabling improved energy efficiency. Advanced analysis features help to identify the causes of potential power-related problems before they occur, ensuring the health of your protected equipment.



### PowerChute Business Edition Features:

- Graceful system shutdown
- Fault notifications
- Risk-assessment reporting
- Scheduled shutdowns
- Energy-usage reporting
- Centralized monitoring
- Recommended actions
- Battery status
- Outlet-aware shutdown
- Event and data logging
- Power-event summary
- Voltage analysis

---

Life Is On

**APC**<sup>®</sup>  
by Schneider Electric

# Connected Smart-UPS Management Solutions

## UPS Network Management Cards

For remote management and control

Connect to your network and enjoy direct control

APC UPS network management cards allow for secure connection and control of an individual APC UPS unit via web browser, command-line interface, or SNMP. The configurable notification features keep you informed of problems as they occur. For protected servers, the included PowerChute Network Shutdown software provides graceful, unattended shutdown in the event of an extended power outage, always keeping business information safe.



### Network management card features:

- **Browser accessible:** View the user interface with a browser for quick access from anywhere, on a secure network
- **Remote device management:** Enable management of your UPS by connecting it directly to the network
- **Fault notification:** Get real-time event notifications, minimizing response time to critical physical infrastructure situations – reducing meantime to repair, improving efficiency, and maximizing uptime
- **Reboot equipment remotely:** Eliminate the need to dispatch technicians to remote locations

---

## PowerChute Network Shutdown

Provides graceful network-based shutdown of physical and virtual IT architectures

PowerChute Network Shutdown Edition software provides UPS management, safe system shutdown, and innovative energy reporting capabilities. Energy usage, cost, and CO2 reporting provides a greater understanding of the energy consumed by IT equipment, enabling improved energy efficiency. Advanced analysis features help to identify the causes of potential power-related problems before they occur, ensuring the health of your protected equipment.



### PowerChute Network Shutdown Features:

- Graceful network-based shutdown
- Sequenced server shutdown
- Integration with VMware and Microsoft Hyper-V
- Support for virtual clusters
- Virtual machine migration / shutdown
- IPv6 support
- Virtual machine prioritization
- Command file integration
- Redundant and parallel UPS support
- Event logging
- HTTPS communications
- Scalable architecture for host of client systems

---

Life Is On

**APC**<sup>®</sup>  
by Schneider Electric



# Connected Smart-UPS Services and Accessories

Schneider Electric Critical Power & Cooling Services (CPCS) provides the highest quality services and solutions by trained and trusted professionals. Our world-class services offer a smart way to build, operate, and maintain your critical applications, ensuring the right people, in the right place, at the right time.

## Management cards

- **AP9630:** UPS Network Management Card
- **AP9631:** UPS Network Management card with environmental monitoring



AP9631

---

## Additional accessories

- **AP9625:** APC Smart-UPS two-post rail kit



AP9625

---

## Service bypass panels

- **SBP1500RMI:** APC service bypass PDU, 120V; 15 amp with (8) NEMA 5-15R
- **SBP300RMI:** APC service bypass PDU, 120V; 30 amp with (4) NEMA 5-20R
- **SBP3000:** APC service bypass panel, 100–240V; 30 amp; BBM; hard-wire input /output



SBP3000RM

# APC Smart-UPS SMC

## Tower Technical Specifications



### SMC1000IC

### SMC1500IC

#### Output

Power Capacity	600W / 1000VA	900W / 1500VA
Nominal Output Voltage	230V	
Output Frequency	47-63 Hz	
Wave Form Type	Pure Sine Wave	
Output Connections	(8) IEC 320 C13	

#### Input

Nominal Input Voltage	230V	
Input Voltage Range for main operations (Max adjustable range)	180 – 286 V (170-300V)	
Input Frequency	50/60 Hz +/-3 Hz (auto sensing)	
Input Connection	IEC 320 C20	

#### Batteries and Runtime

Battery Type	Maintenance-free sealed lead-acid battery with suspended electrolyte	
Runtime at Half Load	14 min	11 min
Runtime at Full Load	5.Min	4 min
Replacement Battery	APCRBC142	RBC6

#### Communication and Management

APC SmartConnect Enabled	Yes	
Interface Ports	USB and Serial (RJ45)	
Control Panel and Audible Alarms	Etched glass LCD display with LED status indicators; alarm on battery, distinctive low battery alarm	

#### Surge Protection Filtering

Surge Energy Rating (Joules)	693 J	
Filtering	Full time multi-pole noise filtering: 0.3% IEEE surge let-through, zero clamping response time, meets UL1449	

#### Physical

Dimensions (H x W x D)	219 x 171 x 439 mm	219 x 171 x 439 mm
Net Weight	17.25 kg	20.4 kg

#### Conformance

Regulatory	VDE, CE, GOST, C-Tick	
------------	-----------------------	--

Life Is On

**APC**  
by Schneider Electric

# APC Smart-UPS SMC

## Rackmount Technical Specifications



	SMC1000I-2UC	SMC1500I-2UC
Output		
Pow er Capacity	600W / 1000VA	900W / 1500VA
Nominal Output Voltage	230V	
Output Frequency	47-63 Hz	
Wave Form Type	Pure Sine Wave	
Output Connections	(4) IEC 320 C13	
Input		
Nominal Input Voltage	230V	
Input Voltage Range for main operations (Max adjustable range)	180 – 286 V (170-300V)	
Input Frequency	47 / 63 Hz +/- 3 Hz (auto-sensing)	
Input Connection	IEC 320 C14	
Batteries and Runtime		
Battery Type	Maintenance-free sealed lead-acid battery with suspended electrolyte	
Runtime at Half Load	14 min	18 min
Runtime at Full Load	5 min	6 min
Replacement Battery	APCRBC124	APCRBC132
Communication and Management		
APC SmartConnect Enabled	Yes	
Interface Ports	USB and Serial (RJ45)	
Control Panel and Audible Alarms	Etched glass LCD display with LED status indicators; alarm on battery, distinctive low battery alarm	
Surge Protection Filtering		
Surge Energy Rating (Joules)	693 J	
Filtering	Full time multi-pole noise filtering: 0.3% IEEE surge let-through, zero clamping response time, meets UL1449	
Physical		
Dimensions (H x W x D)	86 x 432 x 409 mm	86 x 432 x 477 mm
Net Weight	17.5 kg	27.1 kg
Conform ance		
Regulatory	VDE, CE, GOST, C-Tick	



# APC Smart-UPS SMT

## Tower Technical Specifications



SMT750IC		SMT1000IC		SMT1500IC	SMT2200IC	SMT3000IC
Output						
Power Capacity	500 W/750 VA	700W / 1000VA	1000W / 1500VA	1980 W/2200 VA	2700 W/3000 VA	
Nominal output voltage	230 V (configurable to 220 or 240 V nominal)					
Output frequency	47 - 53 Hz for 50 Hz nominal; 57 – 63 Hz for 60 Hz nominal					
Waveform type	Sine wave					
Output connections (NEMA)	(6) IEC320 C13	(8) IEC 320 C13			(8) IEC320 C13, (1) IEC320 C19	
Switched outlet groups	-	1				
Input						
Nominal input voltage	230V					
Input voltage range for main operations (Max adjustable)	160 – 286V (150 – 300V)					
Input frequency	50/60 Hz +/-3 Hz (auto sensing)					
Input connection	IEC320 C14			IEC320 C20, Schuko CEE7/EU1-16), British BS1363A		
Batteries and runtime						
Battery type	Maintenance-free sealed lead-acid battery with suspended electrolyte; leak proof					
Replacement battery	RBC48	RBC6	RBC7	RBC55		
Runtime estimates						
200W	:22	:45	1:24	2:17	2:29	
500W	:05	:10	:23	:51	:55	
700W	-	:06	:12	:34	:37	
1000W	-	-	:07	:21	:23	
1400W	-	-	-	:13	:14	
1600W	-	-	-	:10	:12	
Full load	:05	:06	:07	:07	:06	
Communications and management						
APC SmartConnect Enabled	Yes					
Interface ports	Serial (RJ45), USB, and SmartSlot					
Control panel and audible alarms	Alpha-numeric LCD display with LED status indicators; alarm on battery, distinctive low battery alarm and configurable delays					
Emergency power off (EPO)	Optional			Yes		
Physical						
Maximum height (millimeter)	161	219	219	435	435	
Maximum width (millimeter)	138	171	171	197	197	
Maximum depth (millimeter)	363	439	439	54.4	54.4	
Net weight (kilograms)	13.18	19.5	22.7	48.80	52.50	
Conformance						
Regulatory	RCM, CE, EN62040-1, EN62040-2, EAC, VDE					

Life Is On

**APC**  
by Schneider Electric

# APC Smart-UPS SMT

## Rackmount Technical Specifications



SMT750RMI2UC		SMT1000RMI2UC		SMT1500RMI2UC		SMT2200RMI2UC		SMT3000RMI2UC		
Output										
Power Capacity	500 W/750 VA		700W / 1000VA		1000W / 1500VA		1980 W/2200 VA		2700 W/3000 VA	
Nominal output voltage	230 V (configurable to 220 or 240 V nominal)									
Output frequency	47 – 53 Hz for 50 Hz nominal; 57 – 63 Hz for 60 Hz nominal									
Waveform type	Sine wave									
Output connections (NEMA)	(4) IEC320 C13					(8) IEC320 C13, (1) IEC320 C19				
Switched outlet groups	1									
Input										
Nominal input voltage	230V									
Input voltage range for main operations (Max adjustable)	160 – 286V (Max adjustable 150 – 300V)									
Input frequency	50/60 Hz +/-3 Hz (auto sensing)									
Input connection	IEC320 C14					IEC320 C20				
Batteries and runtime										
Battery type	Maintenance-free sealed lead-acid battery with suspended electrolyte; leak proof									
Replacement battery	APCRBC123		APCRBC157		APCRBC159		RBC43			
Runtime estimates										
200W	:24		1:10		1:32		1:24		1:26	
500W	:05		:17		:26		:35		:38	
700W	-		:09		:14		:24		:26	
1000W	-		-		:07		:15		:17	
1400W	-		-		-		:09		:11	
1600W	-		-		-		:07		:09	
Full load	:06		:09		:04		:05		:03	
Communications and management										
APC SmartConnect Enabled	Yes				Yes					
Interface ports	Serial (RJ45), USB, and SmartSlot “NC” versions have AP9631 network management card pre-installed in the SmartSlot									
Control panel and audible alarms	Alpha-numeric LCD display with LED status indicators; alarm on battery, distinctive low battery alarm and configurable delays									
Emergency power off (EPO)	Optional					Yes				
Physical										
Maximum height (millimeter)	86		86		86		86		86.1	
Maximum width (millimeter)	432		432		432		480		480	
Maximum depth (millimeter)	409		477		477		683		683	
Net weight (kilograms)	21.23		27.1		27.8		42.31		44.28	
Conformance										
Regulatory	RCM, CE, EN62040-1, EN62040-2, EAC, VDE									