

REVISIONS			
REV.	DESCRIPTION	DATE	APPROVED
REL-01		6/9/2006	
REL-02	Updated From 4 Penta Cups	10/7/2015	R.L.J.

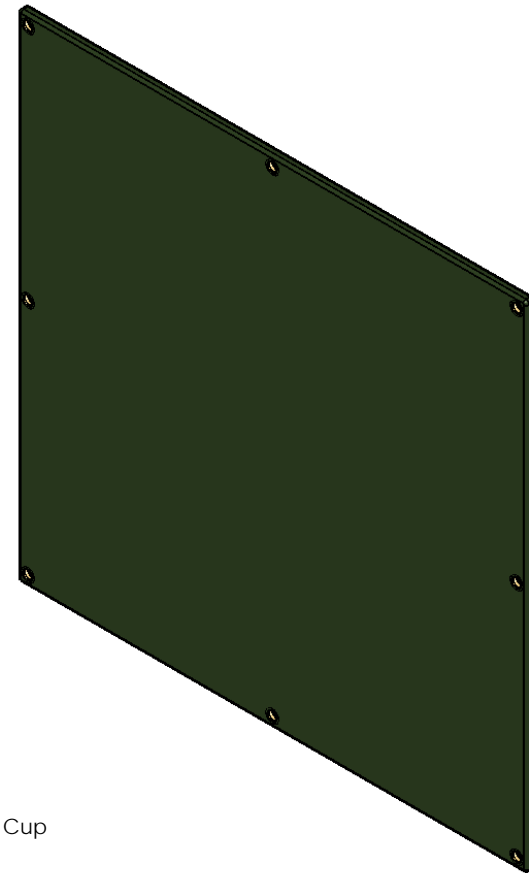

REL-02  
Brass Pentahead Cup  
8x

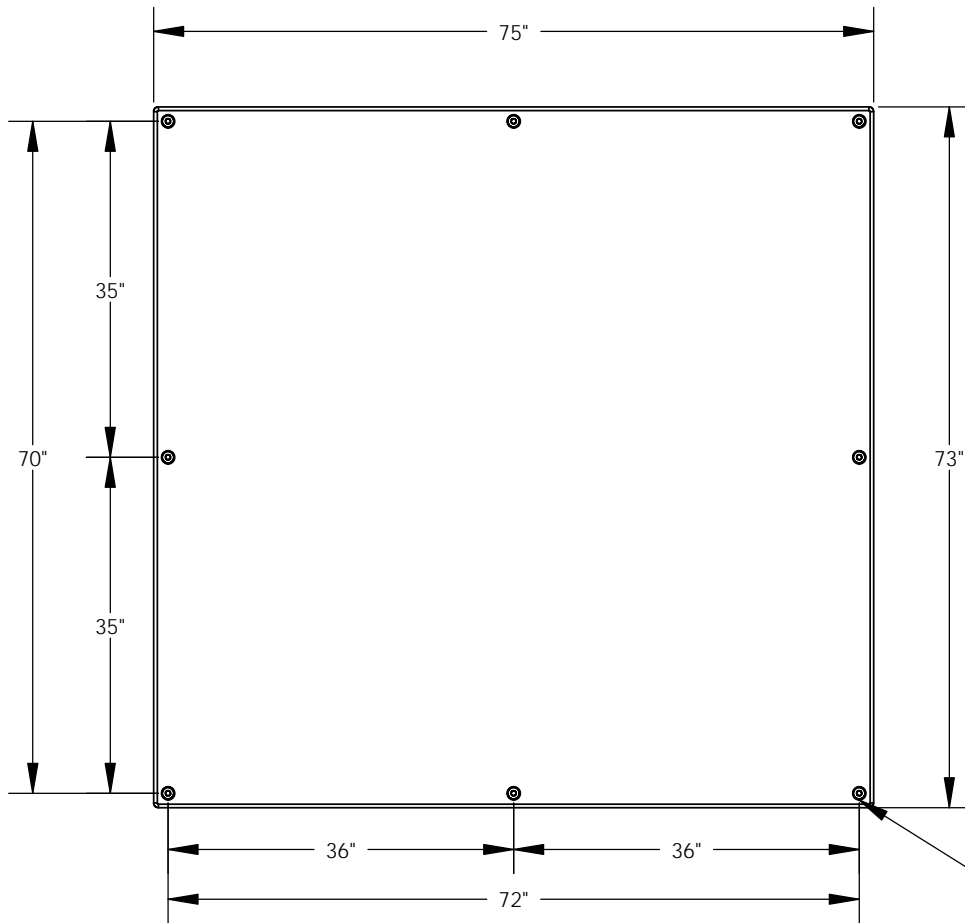
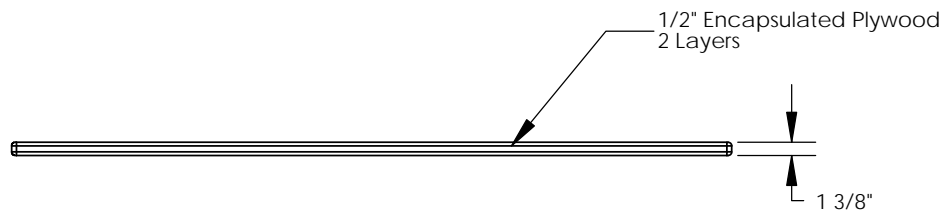

NOTE:  
Includes (8) 3/8-16x1.75  
SST Pentahead Bolts

**Nordic Fiberglass, Inc.**

21415 US Hwy 75 NW, Warren, MN 56762  
www.nordicfiberglass.com  
218-745-5095 ph. --- 218-745-4990 fax

GSC-75-73-MG

**PROPRIETARY AND CONFIDENTIAL**  
THE INFORMATION CONTAINED IN THIS DRAWING IS THE SOLE PROPERTY OF  
NORDIC FIBERGLASS, INC. ANY REPRODUCTION IN PART OR AS A WHOLE  
WITHOUT THE WRITTEN PERMISSION OF NORDIC FIBERGLASS, INC. IS PROHIBITED.

Customer Name: N/A		
DIMENSIONS ARE IN INCHES		
TOLERANCES: ANGLES $\pm 1^\circ$		
FRACTIONAL $\pm 1/32$		
ONE PLACE DECIMAL $\pm .060$		
TWO PLACE DECIMAL $\pm .030$		
THREE PLACE DECIMAL $\pm .015$		
MATERIAL		
	NAME	DATE
DRAWN	P.J.W.	06/09/06
CHECKED	---	--/--/--

SIZE	ITEM ID:	REV.
<b>A</b>	02215.02	<b>REL-02</b>
SCALE:1:20	SHEET 1 OF 1	