

REVISIONS			
REV.	DESCRIPTION	DATE	APPROVED
REL-02	Updated From 4 - BK-24 Bolt Kits	2/11/2013	R.L.J.
REL-03	Added 2 - FN-38's	4/7/2014	R.L.J.
REL-04	Updated Bolt Kit Locations From Upturn to 2 Bolt Bags w/4 Bolt Kits Each Hung From Opening Downturn	2/6/2019	R.L.J.

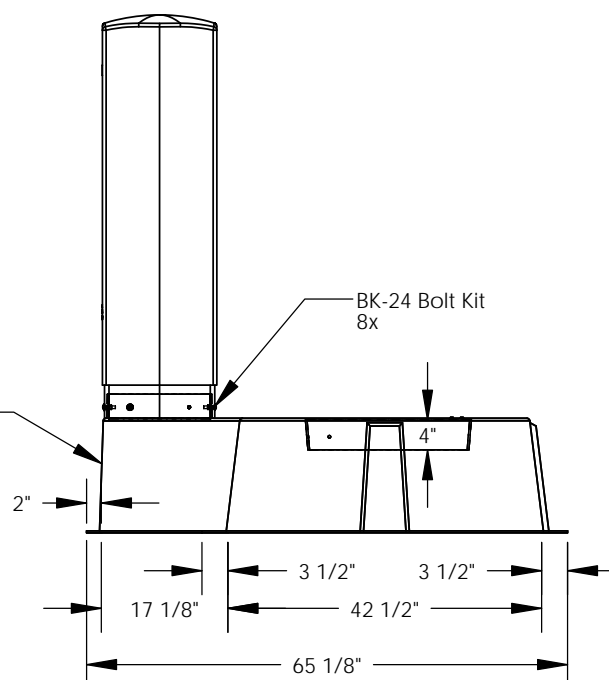
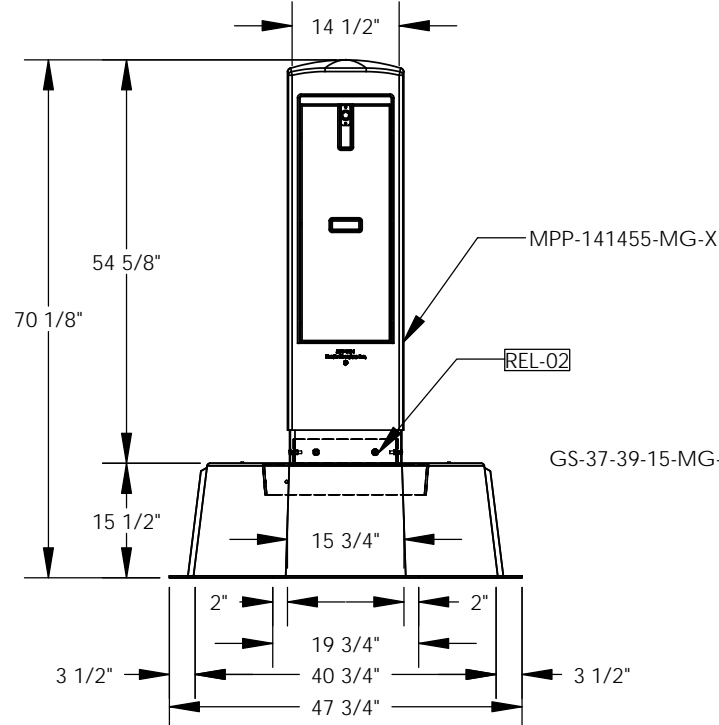
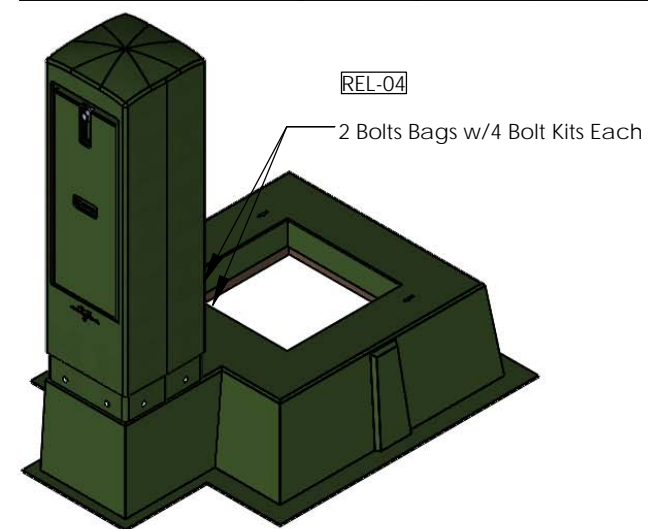
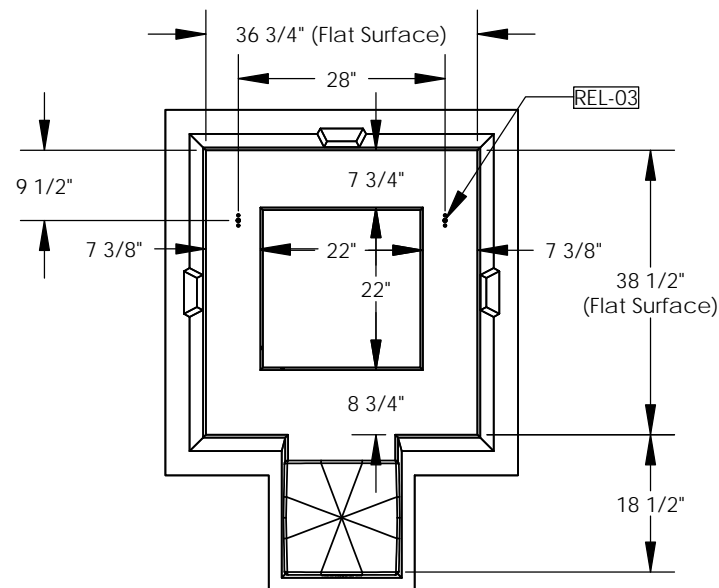

Includes 8 Bolt Kits:
Each BK-24 Bolt Kit Includes:
(1) 3/8-16x1.5 SST CH Bolt
(1) 3/8 SST Flat Washer
(1) 3/8 SST Lock Washer
(1) 3/8 SST Hex Nut

NOTE:
MPP-141455-MG-X Shipped Separate

PROPRIETARY AND CONFIDENTIAL
THE INFORMATION CONTAINED IN THIS DRAWING IS THE SOLE PROPERTY OF NORDIC FIBERGLASS, INC. ANY REPRODUCTION IN PART OR AS A WHOLE WITHOUT THE WRITTEN PERMISSION OF NORDIC FIBERGLASS, INC. IS PROHIBITED.

Customer Name: N/A				www.nordicfiberglass.com 218-745-5095 ph. --- 218-745-4990 fax			
DIMENSIONS ARE IN INCHES TOLERANCES: ANGLES ± 1° FRACTIONAL ± 1/32 ONE PLACE DECIMAL ±.060 TWO PLACE DECIMAL ±.030 THREE PLACE DECIMAL ±.015		MATERIAL		GS-37-39-15-MP-MG-22x22			
			NAME	DATE	SIZE	ITEM ID:	REV.
		DRAWN	R.L.J.	08/31/10	A	00813.01	REL-04
		CHECKED	---	--/--/--	SCALE:1:32	WEIGHT:	SHEET 1 OF 1

Nordic Fiberglass, Inc.

21415 US Hwy 75 NW, Warren, MN 56762
www.nordicfiberglass.com
218-745-5095 ph. --- 218-745-4990 fax

GS-37-39-15-MP-MG-22x22