

REVISIONS			
REV.	DESCRIPTION	DATE	APPROVED
REL-01		6/6/2006	
REL-02	Changed from 3/4" Plywood	10/8/2007	P.J.W.

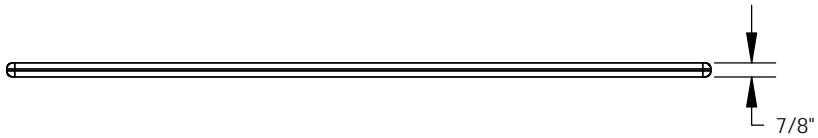
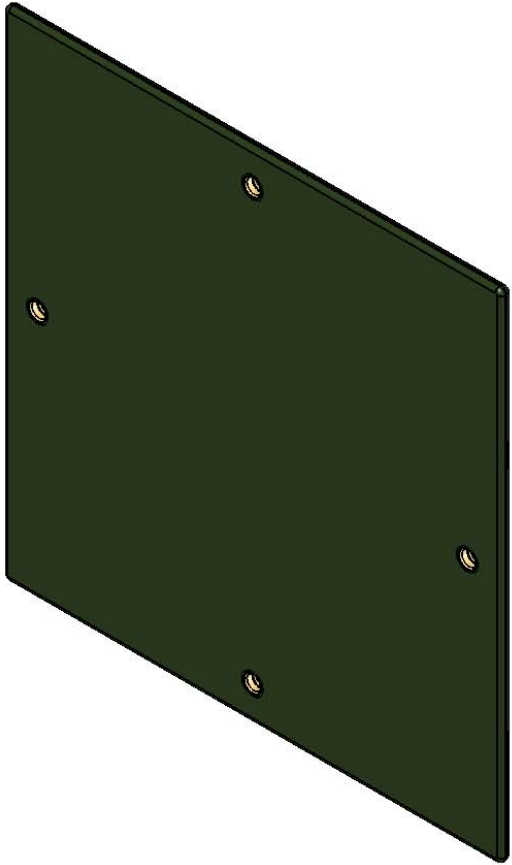
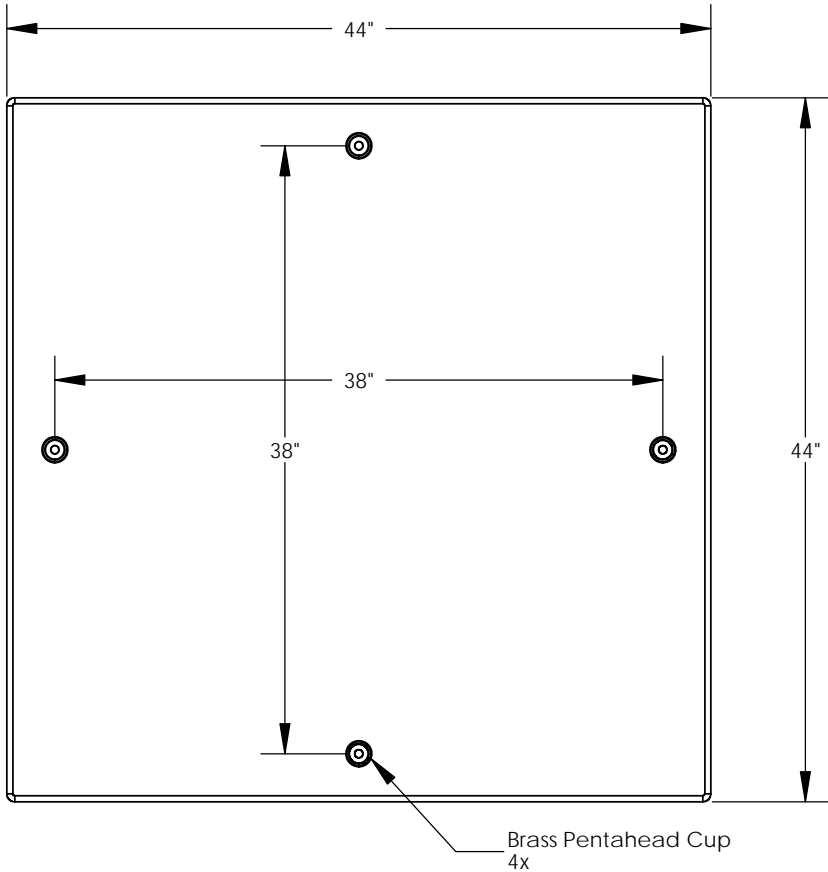

NOTE:
Includes (4) 3/8-16x1.5 SST
Pentahead Bolts

PROPRIETARY AND CONFIDENTIAL
THE INFORMATION CONTAINED IN THIS DRAWING IS THE SOLE PROPERTY OF NORDIC FIBERGLASS, INC. ANY REPRODUCTION IN PART OR AS A WHOLE WITHOUT THE WRITTEN PERMISSION OF NORDIC FIBERGLASS, INC. IS PROHIBITED.

Customer Name: N/A		
DIMENSIONS ARE IN INCHES		
TOLERANCES: ANGLES $\pm 1^\circ$		
FRACTIONAL $\pm 1/32$		
ONE PLACE DECIMAL $\pm .060$		
TWO PLACE DECIMAL $\pm .030$		
THREE PLACE DECIMAL $\pm .015$		
MATERIAL		
	NAME	DATE
DRAWN	P.J.W.	06/06/06
CHECKED	---	--/--/--

Nordic Fiberglass, Inc.
21415 US Hwy 75 NW, Warren, MN 56762
www.nordicfiberglass.com
218-745-5095 ph. --- 218-745-4990 fax

GSC-44-44-MG

SIZE	ITEM ID:	REV.
A	02150.00	REL-02
SCALE:1:12		SHEET 1 OF 1