

REVISIONS			
REV.	DESCRIPTION	DATE	APPROVED
REL-01		9/5/2007	
REL-02	Updated From #10-24x2" FH Screw/Lock Washer/Nut	9/6/2011	R.L.J.

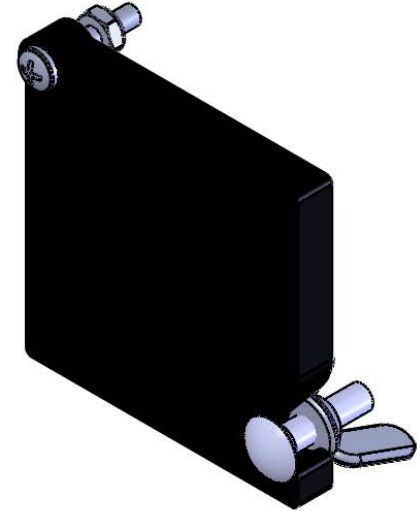
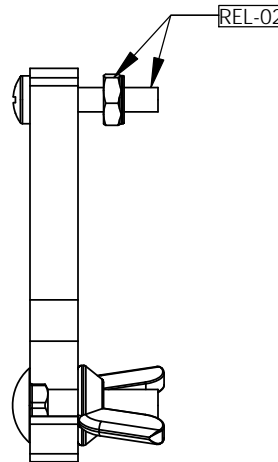
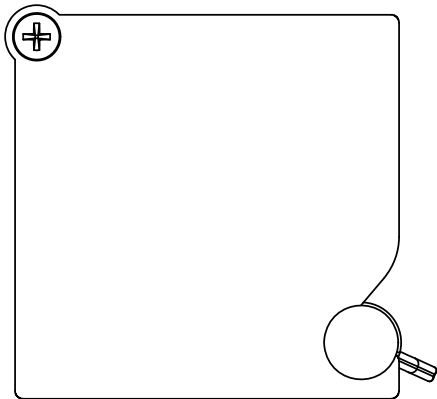

NOTE:
Includes:
(1) Cable Entrance Cover, (1) 1/4x1.0 SST Carriage Bolt, (1) 1/4 SST Wing Nut, (1) #10-24x1.0 SST PH Bolt, (1) #10-24 SST Self Locking Hex Nut

PROPRIETARY AND CONFIDENTIAL
THE INFORMATION CONTAINED IN THIS DRAWING IS THE SOLE PROPERTY OF NORDIC FIBERGLASS, INC. ANY REPRODUCTION IN PART OR AS A WHOLE WITHOUT THE WRITTEN PERMISSION OF NORDIC FIBERGLASS, INC. IS PROHIBITED.

Customer Name: N/A		
DIMENSIONS ARE IN INCHES TOLERANCES: ANGLES $\pm 1^\circ$ FRACTIONAL $\pm 1/2$ ONE PLACE DECIMAL $\pm .060$ TWO PLACE DECIMAL $\pm .030$ THREE PLACE DECIMAL $\pm .015$		
MATERIAL		
	NAME	DATE
DRAWN	P.J.W.	09/05/07
CHECKED	---	--/--/--

Nordic Fiberglass, Inc.		
21415 US Hwy 75 NW, Warren, MN 56762 www.nordicfiberglass.com 218-745-5095 ph. --- 218-745-4990 fax		
CEC-KIT, CABLE ENTRANCE W/HARDWARE		
SIZE	ITEM ID:	REV.
A	03235.04	REL-02
SCALE:1:2		SHEET 1 OF 1