

# ADJUSTABLE RECTANGLE CURVED SHOWER ROD

**CLEAN MODERN LINES**

sales@preferredbathinc.com

www.preferredbathinc.com

(336) 904-6248



## ADJUSTABLE STAINLESS STEEL CURVED SHOWER ROD

- ADJUSTABLE RECTANGLE CURVED SHOWER ROD ASSEMBLY - 1
- STAINLESS STEEL MOUNTING SCREWS - 4
- STAINLESS STEEL SET SCREWS - 2
- PLATED ZINC DIE-CAST WALL BRACKET - 2
- PLATED ROD RECEIVER - 2

PART NUMBERS	FINISH
112-5BP-A	Bright Polished
112-5BN-A	BRUSHED NICKEL
112-5ORB-A	Oil Rubbed Bronze

## PATENTED T-PLUG DESIGN

- PATENTED DESIGN #USD752421s
- EASY ONE PERSON INSTALLATION

## ADJUSTABLE FROM 42 TO 62 INCHES

- TOTAL INSTALLED LENGTH WILL VARY PER APPLICATION
- NO CUTTING REQUIRED

To cut the shower rod down please follow these instructions: Measure the total opening of the shower/ tub enclosure and subtract that number from 60 inches, the remaining number is what will need to be cut from the shower rod. Example: 58 inch opening minus 60 inches leaves 2 inches to cut. It is best to cut equal amounts off both ends, this insures a proper fit.

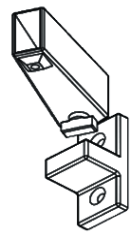
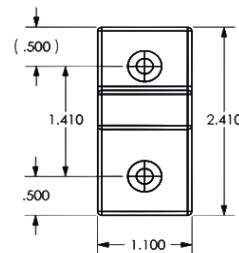

## INSTALLATION:

Screw the wall brackets onto the wall first. Be sure to measure and level each wall bracket. Once complete attach the bar receivers to the wall brackets via the patented T-Plug and insert the shower rod approximately 2 inches into one of the mounted bar receivers. Slide the shower rod towards the second empty bar receiver mounted on the adjacent wall and insert approximately 1 inch. Use the provided set screws to lock everything in place.



## WOOD BLOCKING IS THE PREFERRED METHOD OF INSTALLATION

Limited Warranty:

Preferred Bath Accessories Inc. warrants to the purchaser that the product will be free from defects in material and workmanship. If the product does not comply with this warranty, Preferred Bath Accessories Inc. will repair or replace the product or, at Preferred Bath Accessories Inc's. option, refund the purchase price. The limited warranty period is for the lifetime of the product. Limitations on the Warranty: The warranty does not cover, normal wear and tear, product abuse, neglect, improper installation or maintenance. Purchaser Requirements: If this product does not meet Preferred Bath Accessories Inc's. warranty, return the product (postage prepaid) to the place of purchase with proof of purchase and a written claim briefly describing the defect. You may be required to provide other information or evidence of the defect.