

Noga Handles

NG-1 Handle

	<p>NG-1 Handle accepts all “S” type Blades Ergonomic soft grip, acetyl and rubber construction Removable end cap for blade storage 125mm long x 28mm maximum diameter Blades are secured by pulling back the front locking mechanism and are free to rotate</p>
---	---

Packed Weight and Dimensions

Code	Description	Weight g	W mm	H mm	L mm
NG1000	NG-1 Handle	45	32	32	153

NG-2 Handle

	<p>NG-2 Handle accepts all “N” type Blades Ergonomic soft grip, acetyl and rubber construction Removable end cap for blade storage 125mm long x 28mm maximum diameter Blades are secured by pulling back the front locking mechanism and are free to rotate</p>
--	---

Packed Weight and Dimensions

Code	Description	Weight g	W mm	H mm	L mm
NG2000	NG-2 Handle	43	31	31	152

NG-3 Handle

	<p>NG-3 Handle accepts all Blade Holders Ergonomic soft grip, acetyl and rubber construction Removable end cap for blade storage 125mm long x 28mm maximum diameter</p>
---	--

Packed Weight and Dimensions

Code	Description	Weight g	W mm	H mm	L mm
NG3000	NG-3 Handle	45	32	32	153

Noga Handles

Uni Handle UH 1000

	<p>Robust Plastic Handle, Holds T120 Double Ended Scraper Blade A fluted locking collar clamps the blade in the required length position Overall Handle length: 130mm Maximum Handle diameter: 26mm</p>
--	---

Packed Weight and Dimensions

Code	Description	Weight g	W mm	H mm	L mm
UH 1000	Uni Handle	50	26	26	180

SC Handle

	<p>Handle Material: Aluminium, black anodised Handle Size: 120mm long x 12mm hexagonal section The Adjustable Scraper Handle also accepts all "D" type Scraper Blades.</p>
---	--

Packed Weight and Dimensions

Code	Description	Weight g	W mm	H mm	L mm
SC1300	SC Handle	40	23	23	155

Noga YT Handle: YT1000

	<p>The Noga YT handle provides the perfect grip for holding the following tools. All Noga "D" Type and T80 Scraper Blades Needle Files Measuring Pins and Drills up to 4.5mm dia. Flexible collet range: 2.2 – 4.5mm Overall length: 100mm Maximum Diameter: 20mm</p>
---	---

Packed Weight and Dimensions

Code	Description	Weight g	W mm	H mm	L mm
YT 1000	YT Handle	33	24	24	152

Noga Handles

Noga-Cut Handle: NC 5000



Noga-Cut Handle accepts Noga-Cut Ceramic Blades only
 Patented blade rotation system
 Ergonomic soft grip, acetyl and rubber construction
 Removable end cap for blade storage
 125mm long x 28mm maximum diameter

Packed Weight and Dimensions

Code	Description	Weight g	W mm	H mm	L mm
NC5000	Noga-Cut Handle	48	31	31	152

Cera-cut Handle CR 2100



This unique plastic handle positively holds the Ceramic Blades due to its self gripping taper.
 The handle also provides storage space inside for spare blades
 The handle end cap is designed for efficient removal of the blade

Packed Weight and Dimensions

Code	Description	Weight g	W mm	H mm	L mm
CR2100	Cera-Cut Handle	43	26	26	172

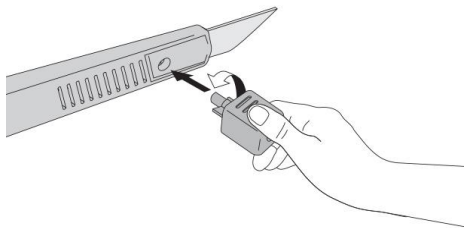

Blade removal:

- 1 Remove the cap from the rear of the handle
- 2 Insert the cap into the round hole and turn 90°
- 3 Pull the blade out

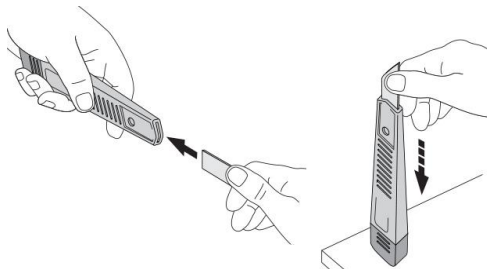

Blade insertion:

- 1 Insert the blade into the grove at the front of the handle
- 2 To secure the blade in place, hold the blade and lightly tap the handle against a solid surface to ensure the blade is firmly held in the self gripping taper in the handle

Packed Weight and Dimensions

Code	Description	Weight g	W mm	H mm	L mm
CR2100	Cera-Cut Handle	43	26	26	172

Noga Handles

Rapid Burr Handle (Not available separately)

	<p>Rapid Burr Handle Overall Length: 150mm Handle Body: Painted Aluminium x 12mm hex section Blade Holder: Steel mechanism Holds all "S" type blades plus special blades with 3.2 mm mounting diameters</p>
--	---

Packed Weight and Dimensions

Code	Description	Weight g	W mm	H mm	L mm
N/A	Rapid Burr Handle	N/A	N/A	N/A	N/A

Plastic Edge Off Handle (not available separately)

	<p>Plastic Edge Off Handle will accept all "S" type Heavy Duty Blades with 3.2mm shank Complete with moulded pocket clip Blades are secured by turning the front locking mechanism and are free to rotate Manufactured from tough ABS plastic Size 120mm long x 10mm hexagonal section</p>
---	--

Packed Weight and Dimensions

Code	Description	Weight g	W mm	H mm	L mm
N/A	Plastic Edge Off Handle	N/A	N/A	N/A	N/A