

Plunger Dial Indicators

Page: 1 of 4



DG-25M

General Specifications:

- Adjustable dial
- Hardened & ground racks
- Bezel lock
- Lug back fitting
- Tolerance pointers (not fitted to DG-100M)
- Fitted with ball anvil
- Anvil thread 2.5mm

Metric Models

Packed Weight and Dimensions

Code	Description	Dial Dia mm	Travel mm	Grads. mm	Weight g	W mm	H mm	L mm
DG-1MM	Dial Indicator	40	1.0	0.001	98	60	55	110
DG-5M	Dial Indicator	40	5.0	0.01	93	60	55	110
DG-M	Dial Indicator	60	10.0	0.01	176	80	60	165
DG-MB	Dial Indicator	60	10.0	0.01	176	80	60	165
DG-MSP	Dial Indicator	60	10.0	0.01	176	80	60	165
DG-25M	Dial Indicator	60	25.0	0.01	184	80	60	165
DG-25MB	Dial Indicator	60	25.0	0.01	184	80	60	165
DG-50M	Dial Indicator	76	50.0	0.01	251	65	60	220
DG-100M	Dial Indicator	80	100.0	0.01	996	124	64	405

Range Details Metric:

Code	Dial Dia./ mm	Travel / mm	Grads. / mm	Reading	Dial Colour
DG-1MM	40	1.0	0.001	0-100 c/w	White
DG-5M	40	5.0	0.01	0-100 c/w, 0-100 a/c	White
DG-M	60	10.0	0.01	0-100 c/w, 0-100 a/c	White
DG-MB	60	10.0	0.01	0-100 c/w, 0-100 a/c	Black
DG-MSP	60	10.0	0.01	0-100 c/w, 0-100 a/c	White
DG-25M	60	25.0	0.01	0-100 c/w, 0-100 a/c	White
DG-25MB	60	25.0	0.01	0-100 c/w, 0-100 a/c	Black
DG-50M	76	50.0	0.01	0-100 c/w, 0-100 a/c	White
DG-100M*	80	100.0	0.01	0-100 c/w, 0-100 a/c	White

* DG-100M cannot be used upside down (inverted)

Plunger Dial Indicators

 <p>DG-MSP</p>	<p>General Specifications:</p> <ul style="list-style-type: none"> Adjustable dial Hardened & ground racks Bezel lock Lug back fitting Tolerance pointers Fitted with ball anvil Anvil thread 2.5mm
---	---

Inch Models

Packed Weight and Dimensions

Code	Description	Dial Dia inch	Travel inch	Grads. inch	Weight g	W mm	H mm	L mm
DG-1/4	Dial Indicator	1.58	0.25	0.001	93	60	55	110
DG-1/2S	Dial Indicator	2.35	0.50	0.001	176	80	60	165
DG-1/2SB	Dial Indicator	2.35	0.50	0.001	176	80	60	165
DG-1S	Dial Indicator	2.35	1.00	0.001	184	80	60	165
DG-1SB	Dial Indicator	2.35	1.00	0.001	184	80	60	165
DG-2S	Dial Indicator	3.0	2.00	0.001	251	65	60	220

Range Details Inch:

Code	Dial Dia inch	Travel. inch	Grads. inch	Reading	Dial Colour
DG-1/4	1.58	0.25	0.001	0-100 c/w	White
DG-1/2S	2.35	0.50	0.001	0-100 c/w, 0-100 a/c	White
DG-1/2SB	2.35	0.50	0.001	0-100 c/w, 0-100 a/c	Black
DG-1S	2.35	1.00	0.001	0-100 c/w, 0-100 a/c	White
DG-1SB	2.35	1.00	0.001	0-100 c/w, 0-100 a/c	Black
DG-2S	3.0	2.00	0.001	0-100 c/w, 0-100 a/c	White

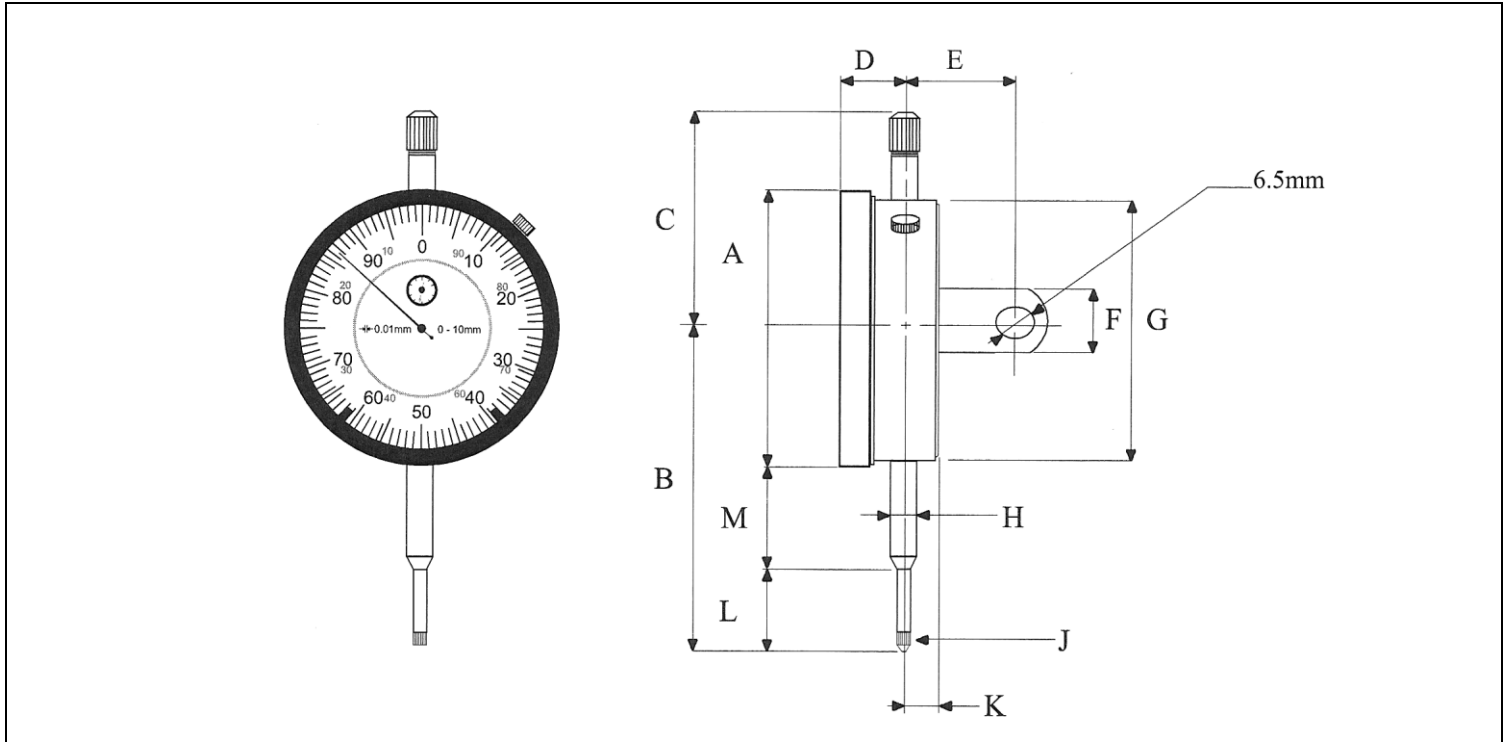

Dimensions: Metric Models

Code	A	B	C	D	E	F	G	H	J	K	L	M
	mm	mm	mm	mm	mm	mm	mm	mm	mm	mm	mm	mm
DG-1MM	40	46.0	30.0	12.8	17.7	17.8	36.0	8.0	M2.5	6.3	12.5	13.5
DG-5M	40	46.0	30.0	12.8	17.7	17.8	36.0	8.0	M2.5	6.3	12.5	13.5
DG-M	60	69.0	45.0	16.0	19.3	17.8	54.7	8.0	M2.5	8.0	20.0	18.0
DG-MB	60	69.0	45.0	16.0	19.3	17.8	54.7	8.0	M2.5	8.0	20.0	18.0
DG-MSP	60	84.0	45.0	16.0	19.3	17.8	54.7	8.0	M2.5	8.0	20.0	18.0
DG-25M	60	84.0	40.0	16.0	19.3	17.8	54.7	8.0	M2.5	8.0	36.3	18.0
DG-25MB	60	84.0	40.0	16.0	19.3	17.8	54.7	8.0	M2.5	8.0	36.3	18.0
DG-50M	76	130.0	48.0	16.4	23.2	17.8	71.0	8.0	M2.5	8.0	59.0	33.0
DG-100M*	83	210.0	160.0	18.0	15.0	17.8	80.0	8.0	M2.5	10.0	110.0	58.0

* DG-100M cannot be used upside down (inverted)

Dimensions: Inch Models

Code	A	B	C	D	E	F	G	H	J	K	L	M
	inch	inch	inch	inch	inch	inch	inch	mm	mm	inch	inch	inch
DG-1/4	1.58	1.92	1.19	0.53	0.69	0.7	1.41	8.0	M2.5	0.25	0.60	0.51
DG-1/2S	2.35	3.02	1.54	0.63	0.77	0.7	2.16	8.0	M2.5	0.32	1.08	0.73
DG-1/2SB	2.35	3.02	1.54	0.63	0.77	0.7	2.16	8.0	M2.5	0.32	1.08	0.73
DG-1S	2.35	3.36	1.52	0.63	0.77	0.7	2.16	8.0	M2.5	0.32	1.42	0.73
DG-1SB	2.35	3.36	1.52	0.63	0.77	0.7	2.16	8.0	M2.5	0.32	1.42	0.73
DG-2S	3.0	5.45	4.37	0.61	0.77	0.7	2.16	8.0	M2.5	0.32	2.28	1.68

Plunger Dial Indicators

Page: 4 of 4

Accuracy Specifications: Metric

Range	Grads.	Total Revs.	Each 0.1mm	Each 0.5mm	Each 1.0mm	Each 2mm	Total Travel
mm	mm		mm	mm	mm	mm	mm
0-1	0.001	1	0.005	0.008	0.01	-	-
0-5	0.01	5	0.005	0.008	0.01	0.015	0.016
0-10	0.01	10	0.005	0.008	0.01	0.015	0.020
0-25	0.01	25	0.005	0.008	0.01	0.015	0.030
0-50	0.01	50	0.01	0.015	0.02	0.025	0.045
0-100	0.01	100	0.01	0.015	0.02	0.025	0.090

* DG-100M cannot be used upside down (inverted)

Accuracy Specifications: Inch

Range	Grads.	Total Revs.	Any 2 Revs.	First 10 Revs.	First 20 Revs.	Total Travel
inch	inch		inch	inch	inch	inch
1/4	0.001	2 1/2	0.001	N/A	N/A	0.0012
1/2	0.001	5	0.001	0.0015	N/A	0.0015
1	0.001	10	0.001	0.002	N/A	0.002
2	0.001	20	0.001	0.002	0.004	0.004