

Instructions for Use

V86900ASM Pro 1F® /Pro 3F® Inflator-Vest
Assembly for Manufacturers

Cautions:

- Carefully follow the directions below to maintain assembly integrity.

Installation of Manifold, Knurl Pins, O-Rings, & 1F/3F Inflator:

1. Place either the Pro 1F® or Pro 3F® inflator into the holding block on the V86900 press with the back of the inflator facing the operator. (Illustration #1)
2. Insert the knurl pins into the top of the jacket manifold and slide the o-ring onto the manifold. (Illustration #2)
3. Align the manifold with the back of the inflator and begin to push it into the back of the inflator. (Illustration #3)
4. While pushing the manifold into the back of the inflator depress the lever arm so that the knurl pins are pushed through the manifold & inflator. (Illustration #4)
5. Remove vest & inflator from assembly unit.

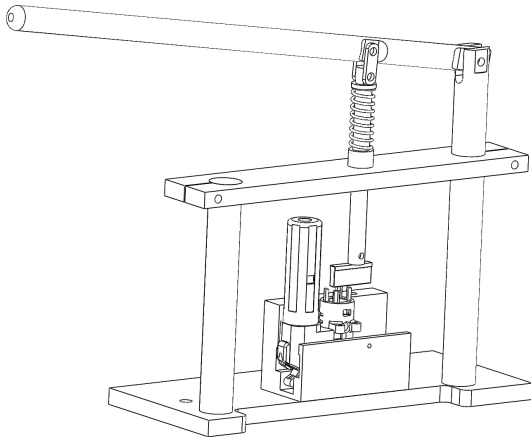

illustration 1

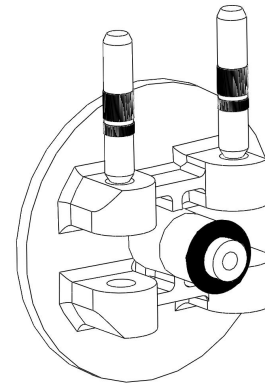

illustration 2

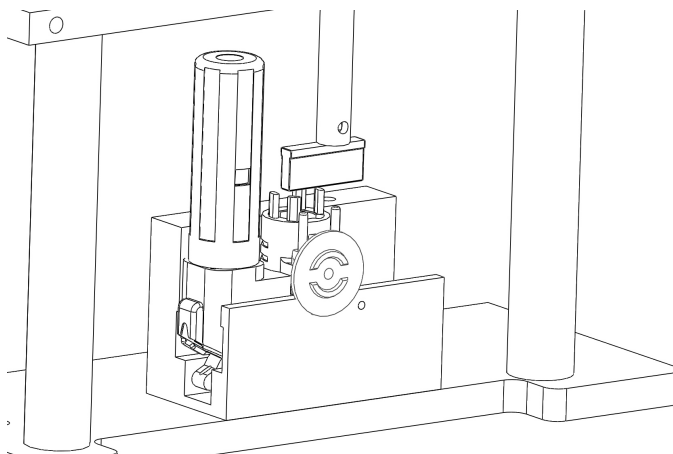

illustration 3

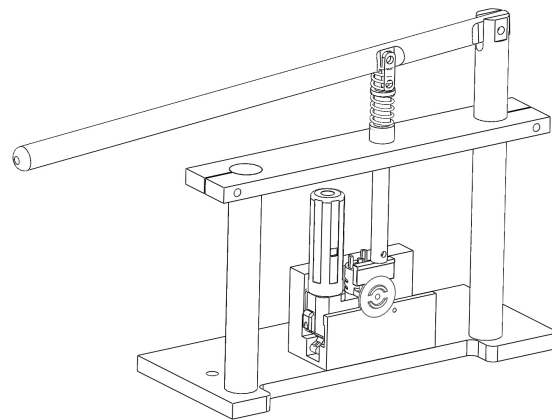

illustration 4