

Instructions for Use

830B08 Molded Manifold for Manufacturers and Service Stations

Cat. No.: 830B03, 830B08, 830B09, 8491AM

Cautions:

- Carefully follow the directions below to maintain the valve integrity.
- To prevent valve damage, Follow proper torque settings.
- The cap with the HR underlined and the ® can be used on all 830B08 manifolds. See below.

Installation 840 Inflator (ill. 1):

1. Install top gasket (P/N 8491AM) on manifold. * Note always use new gaskets when installing inflator.
2. Install 840 inflator on manifold, aligning flats.
3. Install 2nd top gasket (P/N 8491AM) on manifold.
4. Screw cap on manifold.
5. Retain (Secure) inflator and torque cap to 24 - 30 in-lb., with a calibrated torque wrench.

Installation Alpha Inflator® (ill. 2):

1. Check inflator to make sure o-rings are installed on both sides.
2. Install Alpha Inflator® on manifold, aligning flats.
3. Screw cap on manifold.
4. Retain (Secure) inflator and torque cap to 24 - 30 in-lb., with a calibrated torque wrench.

Installation 1F Inflator® (ill. 3):

1. Check inflator to make sure o-rings are installed on both sides.
2. Install 1F Inflator® on manifold, aligning flats.
3. Screw cap on manifold.
4. Retain (Secure) inflator and torque cap to 24 - 30 in-lb., with a calibrated torque wrench.

Illustration 1

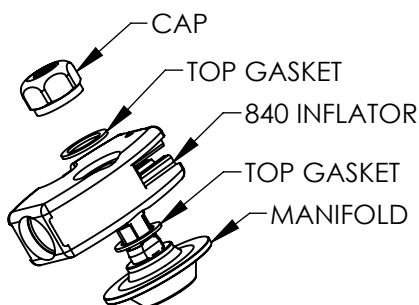

Illustration 2

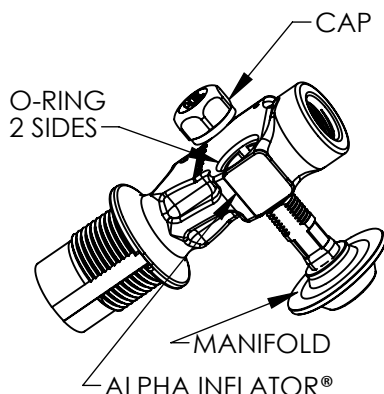

Illustration 3

