

- IP67 Waterproof
- Constant Voltage DC 12V
- 2 Set of DC output wires
- Designed for DC12V LED Lights

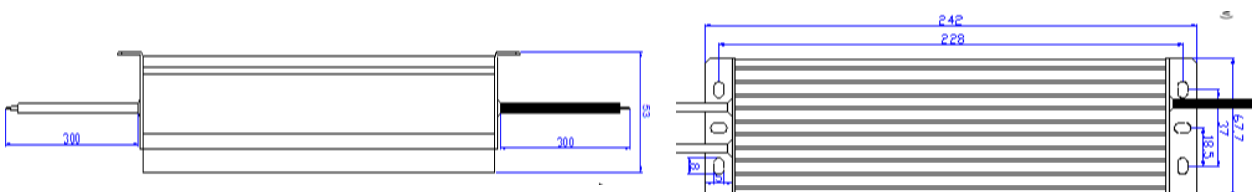

Products Model: VHO-150-012B5		
Output	Rated Output Voltage	12V
	Output current	12.5A
	Rated Power	150W
	Voltage Precision	12V±0.5V
	Output Ripple	<500mV
	Load Regulation	±2%
Input	Input Voltage range	AC 170~265V
	Input Frequency range	50-60HZ
	Power Factor	≥0.9
	Efficiency	>82%
Protection	Overload Protection	12.5-14A
	Short circuit Protection	Protection type: Hiccup mode, recovers automatically after fault condition is removed
Working Protection	Working Temperature	-30°C ~ +50°C
	Storage Temperature	-40°C ~ +80°C
	IP Rate	IP 67
Safety & EMC	Security Standard	Design refer to LVD EN61347-2-13:2006, EN61347-1:2008
	Withstand voltage	I/P-O/P:2KVAC I/P-FG:2KVAC O/P-FG:0.5KVAC
	Insulation Resistance	I/P-O/P:>100M Ohms/500VDC/25°C/70% RH
	EMC	EN55015: 2006/A2:2009, EN61000-3-2:2006/A2: 2009, EN61000-3-3: 2008, EN61547:2009
Others	Dimensions	242*68*53 (L*W*H)
	Weight	1210g



* The information in this datasheet may be changed by Everglow Lighting at any time without prior notice.